

## T. 34 N., R. 101 W., Sixth Principal Meridian, Wyoming, Field Note Links

Plat Accession Number(s)	Year(s) of Survey	
		Township Subdivision Plats
2018	1882	<a href="https://www.wy.blm.gov/cadastral/countyplats/fremont/fieldnotes/t34nr101w_c179fn.pdf">https://www.wy.blm.gov/cadastral/countyplats/fremont/fieldnotes/t34nr101w_c179fn.pdf</a>
		Township Exterior Plats
2019	1882	<a href="https://www.wy.blm.gov/cadastral/countyplats/fremont/fieldnotes/ext2019.pdf">https://www.wy.blm.gov/cadastral/countyplats/fremont/fieldnotes/ext2019.pdf</a>



2018

TOWNSHIP N<sup>o</sup> 34 NORTH. RANGE N<sup>o</sup> 101 WEST of the 6<sup>th</sup> Principal MERIDIAN.



*Meanders of N. F. Pajon Agie River.*

Posts	Courses	Dist. in ac.
<i>Right Bank</i>		
<i>Sec. 35</i>		
1	N 58 1/2° E.	10.00
	N 12 1/2° E.	13.65
	N 60 1/4° E.	10.00
2	N 79° E.	2.00
<i>Sec. 36</i>		
2	S 87° E.	5.50
	N 72° E.	32.25
	S 87° E.	10.00
	N 59 3/4° E.	10.00
	S 73 1/2° E.	12.00
	N 69° 45' E.	6.20
	N 28 3/4° E.	8.00
	N 38 1/4° E.	3.00
3	N 28 1/2° E.	2.94
<i>Total Meanders</i>		
1 mi.	47 chs	54 chs

Total number of Acres. 295.03

Surveys Designated	By Whom Surveyed	Date of Contract	Amount of Surveys M <sup>o</sup> C <sup>o</sup> A <sup>c</sup>	When Surveyed	Magnetic Declination
E. & S. Township lines	Charles W. Brown	June 29, 1882	1 72 30	Octob. 12, 1882	17° 45' E. or S. E.
Subdivisions	"	"	24 40	Octob. 13, 1882	17° 45' "
Connections	"	"	"	"	"
MEANDERS	Charles W. Brown	June 29, 1882	1 47 54	Octob. 13, 1882	"

The above Map of Township N<sup>o</sup> 34 North Range N<sup>o</sup> 101 West of the Sixth Principal Meridian Wyoming Territory is strictly conformable to the field notes of the survey thereof on file in this Office, which have been examined and approved

Surveyor General's Office, *Edw. C. David* Sur. Gen.  
Cheyenne Wyoming  
May 11<sup>th</sup> 1883



(20)  
Index

2019

27

Original  
Cassidy

# EXTERIOR LINES.

Scale 3 miles to 1 inch.

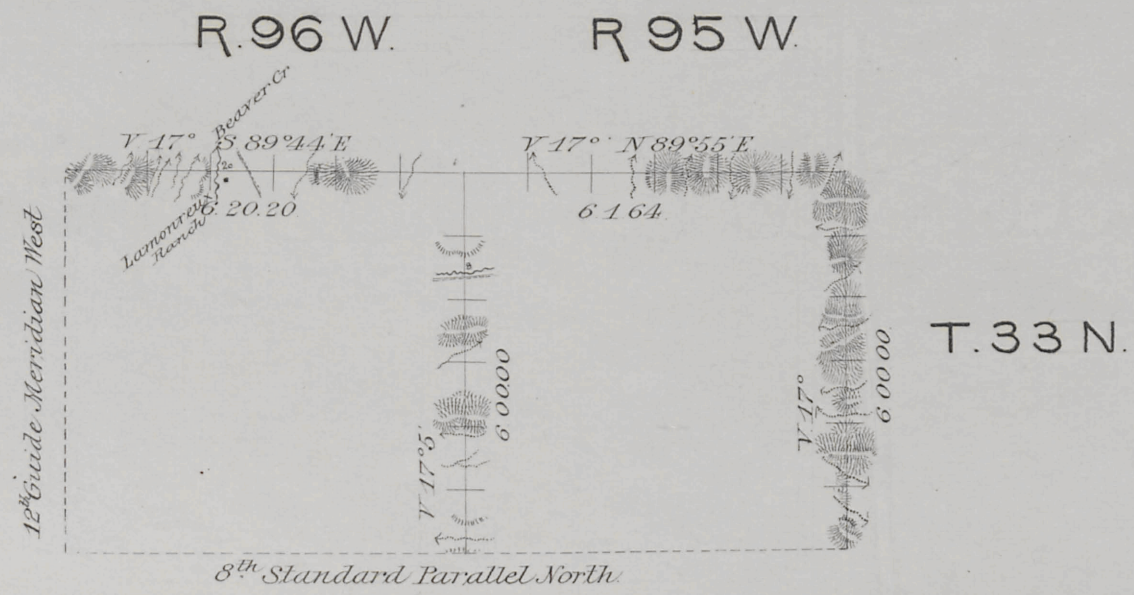

Fractional Township 34 North, Range 101 West 6<sup>th</sup> P.M.

Scale 40 Chains to 1 inch.

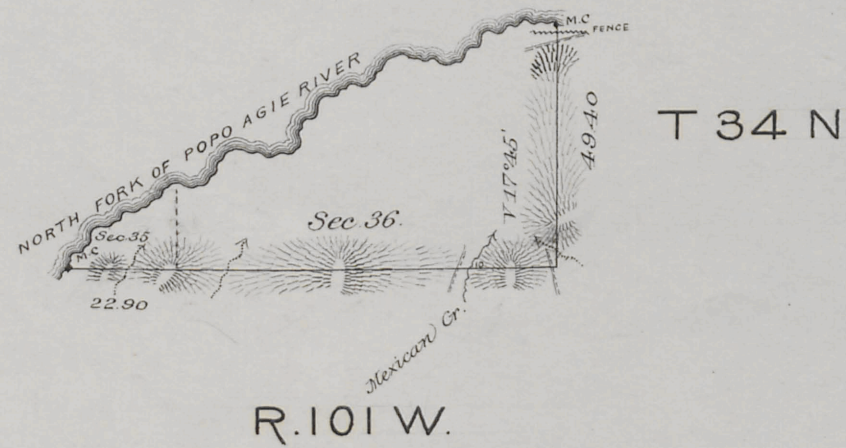

Surveys designated	By whom surveyed	Date of Contract	Amount of surveys			When surv <sup>d</sup>	Mag Declin <sup>o</sup>
			Ac.	Chs.	Sec.		
Ext lines T 33 N R 95 & 96	Chas W. Brown	June 29 1882	24	21	84	Sept 3 4 1882	17° E.
T 34 N R 101 W	"	"	1	72	30	Oct 12 1882	17° 45 E

I hereby certify that the above diagrams of the Exterior lines of Townships No 33 North Ranges 95 & 96, of the line between Ranges 100 & 101 in fractional Township 34 North and of the line between fractional Townships 33 & 34 North Range 101 West of the Sixth Principal Meridian Wyoming Territory are strictly conformable to the field notes of the survey thereof on file in this office which have been examined and approved.

Surveyor General's Office  
Cheyenne, Wyo. May 11<sup>th</sup> 1883

Edw. C. David  
Surveyor General.