

T. 34 N., R. 95 W., Sixth Principal Meridian, Wyoming, Field Note Links

Plat Accession Number(s)	Year(s) of Survey	
		Township Subdivision Plats
4578	1892	https://www.wy.blm.gov/cadastral/countyplats/fremont/fieldnotes/t34nr95w_c249fn.pdf
		Township Exterior Plats
4583	1892	https://www.wy.blm.gov/cadastral/countyplats/fremont/fieldnotes/ext2676.pdf
4584	1892	https://www.wy.blm.gov/cadastral/countyplats/fremont/fieldnotes/ext2677.pdf

4578

Township No 34 North, Range No 95 West of the 6th Principal Meridian

WIND RIVER OR SHOSHONE INDIAN RESERVATION

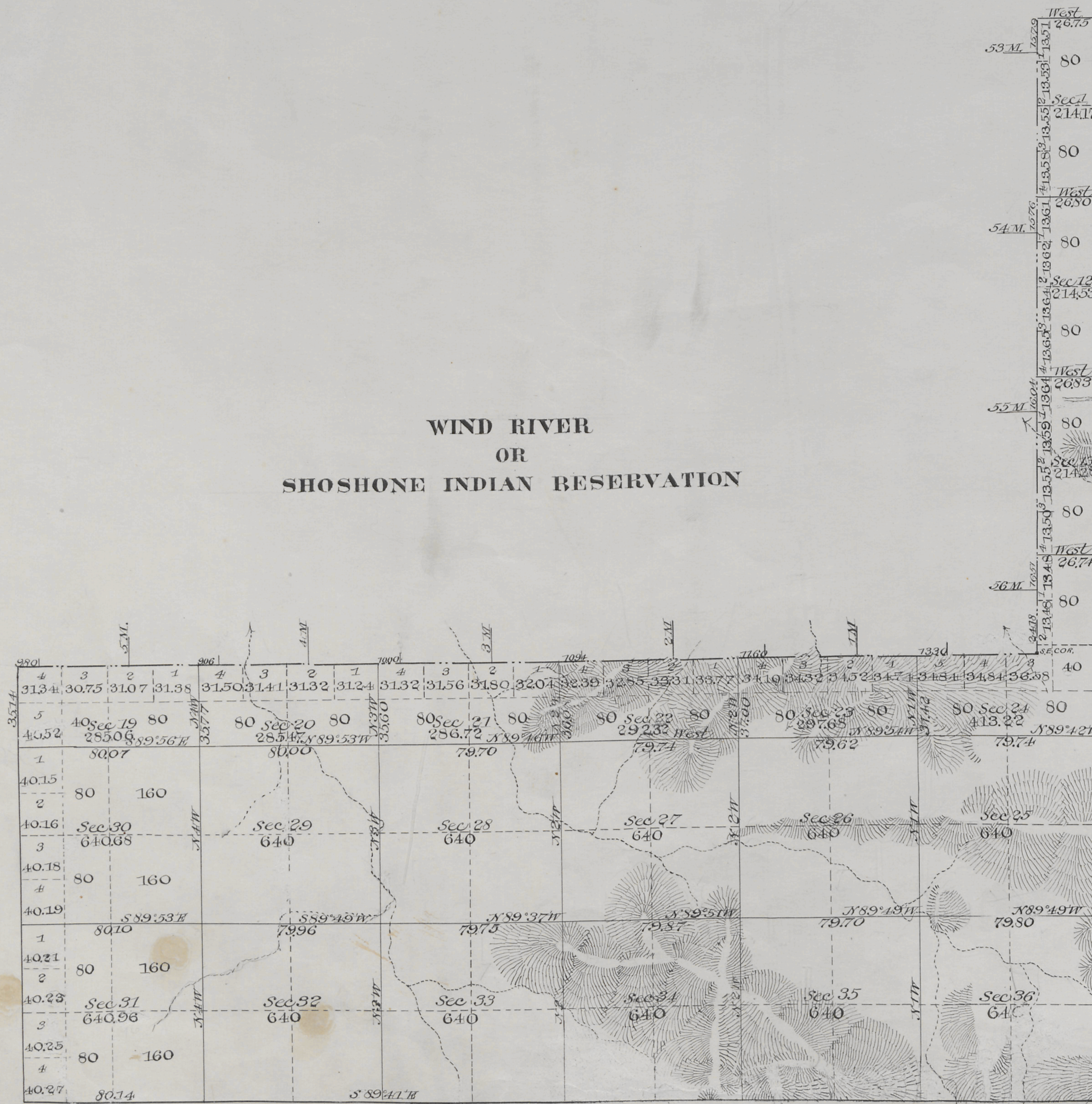

West 26.75
53 M. 1351
80
Sec 11 214.17
80
West 26.80
54 M. 1361
80
Sec 12 214.53
80
West 26.83
55 M. 1369
80
Sec 13 214.28
80
West 26.74
56 M. 1348
80

Subdivision lines at intermediate rates 3^m 41ⁱⁿ 11ⁱⁿ
 minimum " 21 " 75 " 18 "
 Connection " 1 " 48 " 80 "

Total number of Acres. 10,185.09

Survey Designated	By Whom Surveyed	Date of Contract	Amount of Survey M. Ch ^s	Date of Survey	Magnetic Declination
Subdivisions	Coleman & Gilcrest	Sept 2 1892	25 20 29	Sept 21-23 92	16° 50' East
Connections	" "	" "	7 48 80	" " " "	" " " "

The above diagram of Township No 34 North of Range No 95 West of the 6th Principal Meridian Wyoming, is strictly conformable to the field notes of the survey thereof on file in this office which have been examined and approved. W^m A. Richards
 Surveyor General's Office
 Cheyenne Wyo June 8th 1893
 Surv Genl

2671

Index 4684

EXTERIOR LINES

Scale 1 inch = 2 Miles. Mag. Var. East.

WIND RIVER OR SHOSHONE INDIAN RESERVATION

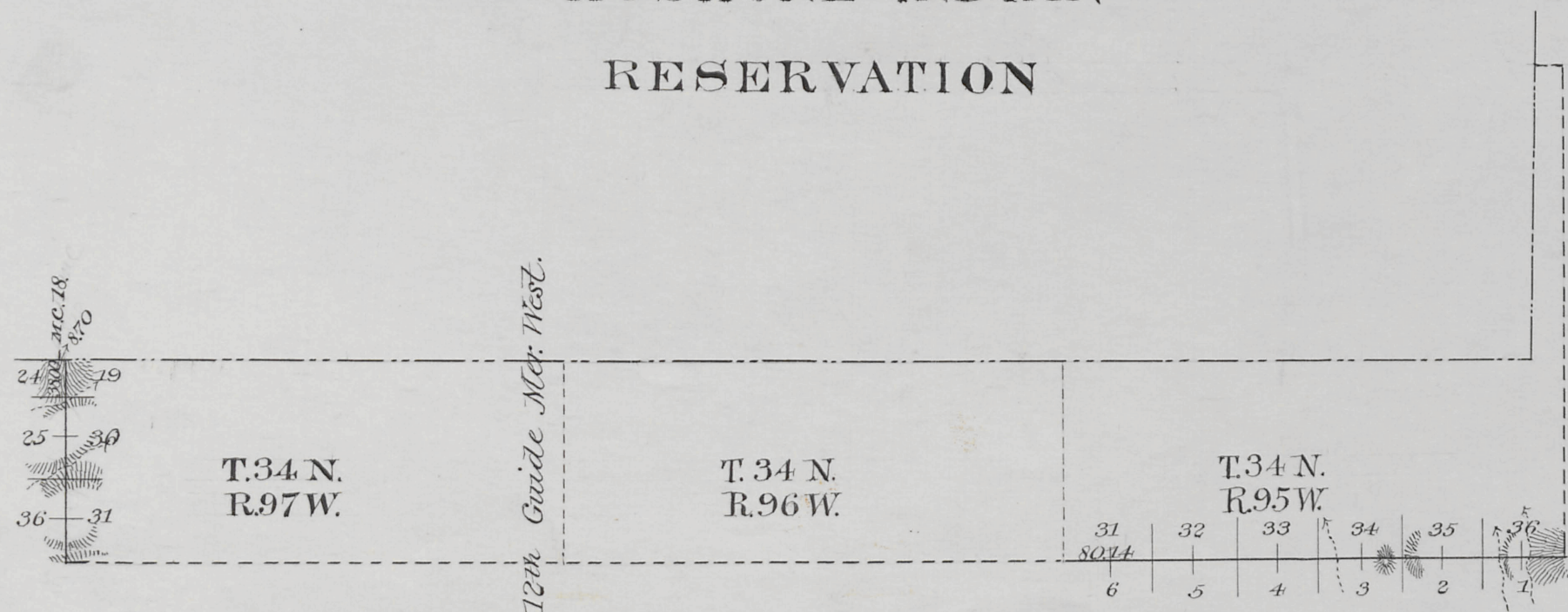

Exterior lines at minimum rates $8^M. 38^C. 14^Lks$
 Connection " " " " $8^M. 70^Lks$

Surveys Designated	By Whom Surveyed	Date of Contract	Amount of Surveys			Date of Contract	Magnetic Direction
			M.	Cts	Lks		
Exteriors	Coleman & Gilcrest	Sept 2, 1892	8	38	14	Sept 21, 1892	76° 55' East
Connections	" "	" " "	"	8	70	" " "	" " "

The above diagram of the resurvey of the exterior lines on the south boundary of Township 34 North of Range 95 West, and the West boundary of Township 34 North of Range 97 West of the 6th Principal Meridian Wyoming is strictly conformable to the field notes of the survey thereof on file in this office which have been examined and approved. *Wm. A. Richards*
 Surveyor General's Office
 Cheyenne Wyo. (June 8-1893) *Sur. Genl.*