

T. 36 N., R. 95 W., Sixth Principal Meridian, Wyoming, Field Note Links

Plat Accession Number(s)	Year(s) of Survey	
		Township Subdivision Plats
4580	1892	https://www.wy.blm.gov/cadastral/countyplats/fremont/fieldnotes/t36nr95w_c249fn.pdf
		Township Exterior Plats
4583	1892	https://www.wy.blm.gov/cadastral/countyplats/fremont/fieldnotes/ext2676.pdf

Township No 36 North, Range No 95 West of the 6th Principal Meridian

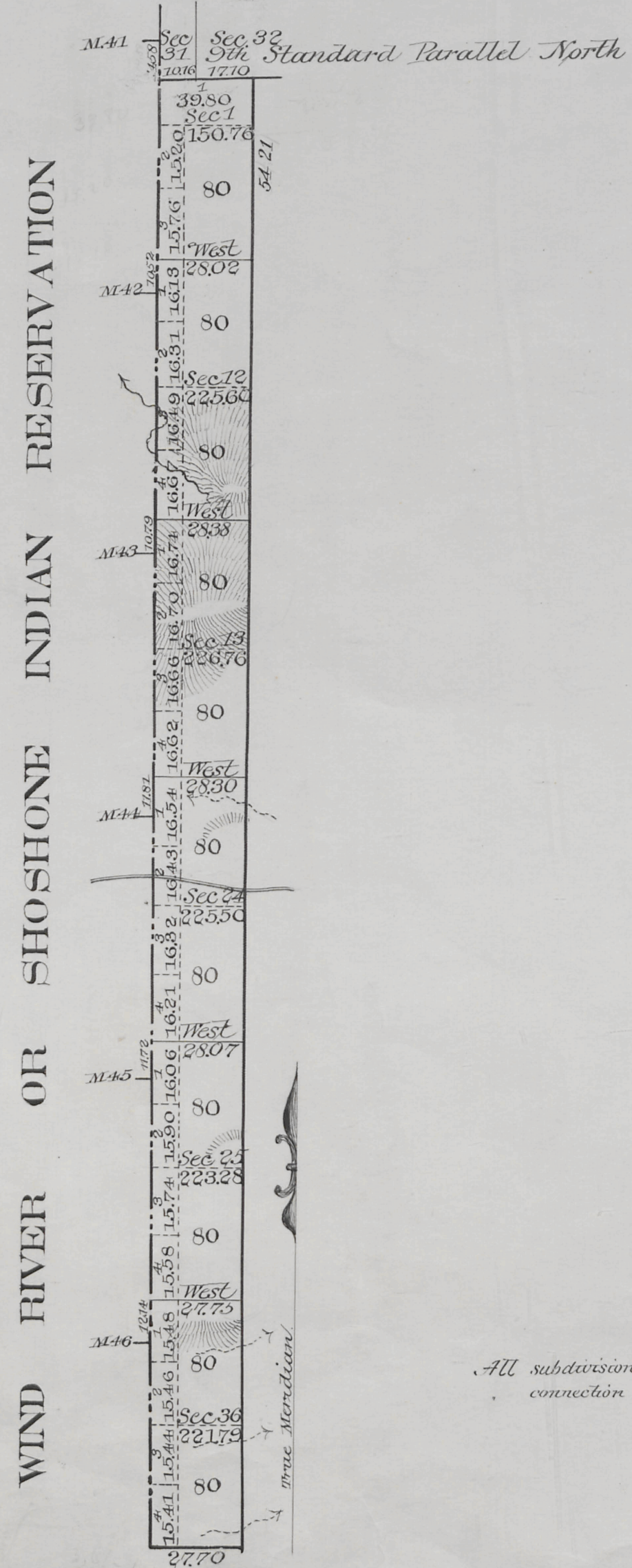

All subdivision lines at minimum rates 1st 60th 52nd
 connection " " " 71st 86th

Total number of Acres 1273.69

Surveys Designated	By Whom Surveyed	Date of Contract	Amount of Survey Ac. Chs. Lks.	Date of Survey	Magnetic Declination
Subdivisions	Coleman & Gilcrest	Sept 2, 1892.	1 60 52	Oct 24, 1892	17° 00' East
Connections.	"	"	71 86	"	"

The above Map of Township No 36 North of Range No 95 West of the 6th Principal Meridian, Wyoming, is strictly conformable to the field notes of the Survey thereof on file in this office, which have been examined and approved. *A. Richards*
 Surveyor General's Office
 Cheyenne Wyo. June 8 - 1893
Surr. Genl.

Index

Original

EXTERIOR LINES.

Scale 2 miles to 1 inch. Magnetic Variation East.

WIND RIVER
OR
SHOSHONE INDIAN
RESERVATION.

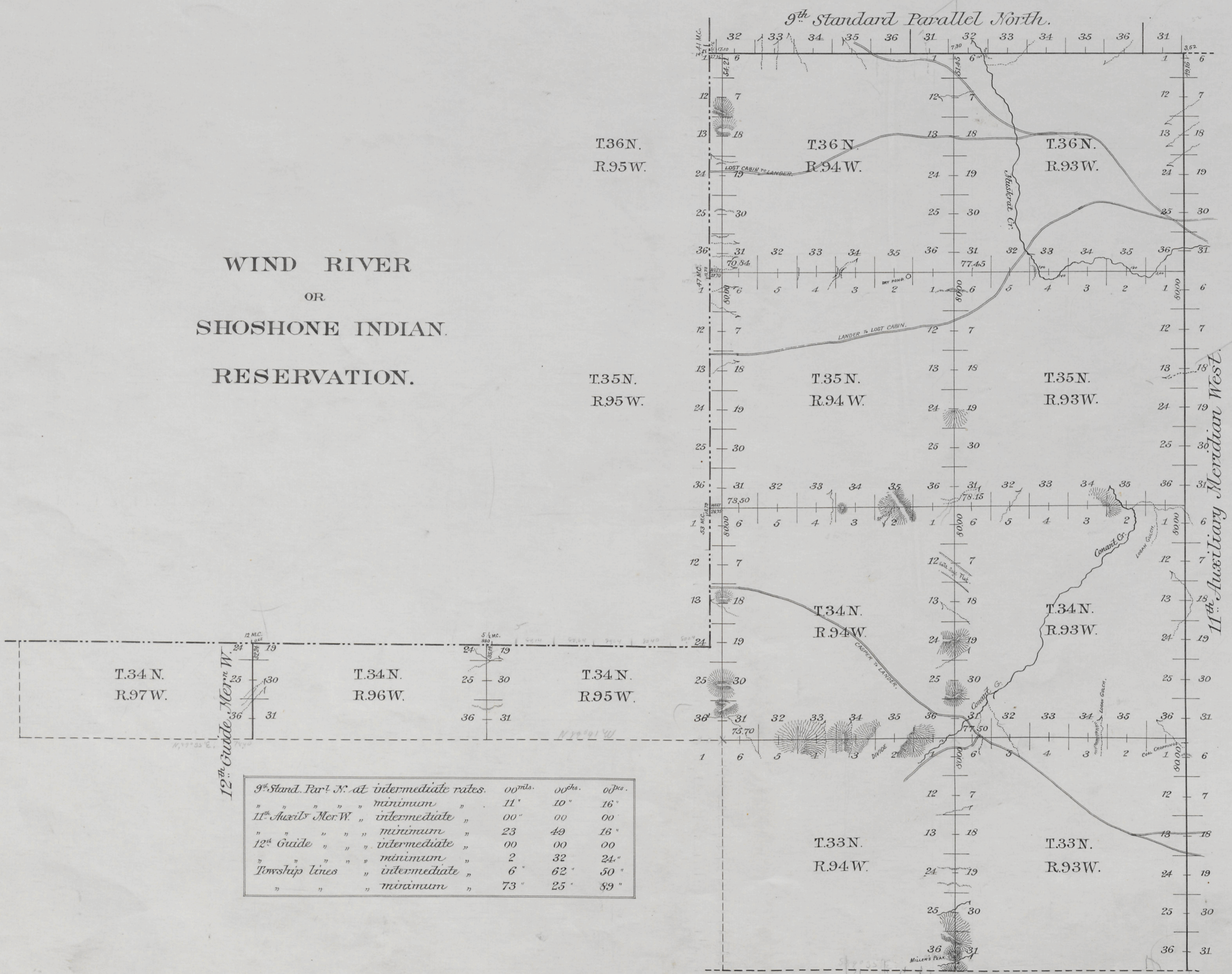

9 th Stand. Par ^l N. at intermediate rates.	00 ^{mils.}	00 ^{chs.}	00 ^{pts.}
" " " minimum	11 "	10 "	16 "
11 th Aux ^l Mer. W. " intermediate	00 "	00 "	00 "
" " " minimum	23 "	49 "	16 "
12 th Guide " " intermediate	00 "	00 "	00 "
" " " minimum	2 "	32 "	24 "
Township lines " intermediate	6 "	62 "	50 "
" " " minimum	73 "	25 "	59 "

Surveys Designated.	By Whom Surveyed.	Date of Contract.	Amount of Surveys. Mls. Chs. Lks.	When Surveyed.	Magnetic Declination.
9 th Stand. Par ^l N.	Coleman & Gilcrest	Sept 2, 1892.	11 10 16	Oct. 11-12, 1892	16° 55' East.
11 th Aux ^l Mer. W.	" "	" "	23 49 16	Sep ^r 25-26, "	16° 45' "
12 th Guide Mer. W.	" "	" "	2 32 24	Sep ^r 19, "	16° 47' "
Township Lines.	" "	" "	80 08 39	Sep. 30-Oct. 24, 1892	16° 47' - 17° 00' East.

The above diagram of the Exterior lines of Townships 33, 34, 35 and 36 North, Ranges 93 and 94 West, fractional Townships 34, 35 and 36 North, Range 95 West and fractional Townships 34 North, Ranges 96 and 97 West, of the 6th Principal Meridian, Wyoming, is strictly conformable to the field notes of survey thereof on file in this office, which have been examined and approved.

U.S. Surveyor General's Office,
Cheyenne, Wyoming,
Jan. 8th 1893.

J. S. Richards
U.S. Surveyor General.