

## T. 45 N., R. 104 W., Sixth Principal Meridian, Wyoming, Field Note Links

Plat Accession Number(s)	Year(s) of Survey	
		Township Subdivision Plats
6408	1934	<a href="https://www.wy.blm.gov/cadastral/countyplats/fremont/fieldnotes/t45nr104w_gp035fn.pdf">https://www.wy.blm.gov/cadastral/countyplats/fremont/fieldnotes/t45nr104w_gp035fn.pdf</a>
6408	1934	<a href="https://www.wy.blm.gov/cadastral/countyplats/fremont/fieldnotes/t45nr104w_gp035fn_bnd.pdf">https://www.wy.blm.gov/cadastral/countyplats/fremont/fieldnotes/t45nr104w_gp035fn_bnd.pdf</a>
3249	1883	<a href="https://www.wy.blm.gov/cadastral/countyplats/fremont/fieldnotes/t45nr104w_c186fn.pdf">https://www.wy.blm.gov/cadastral/countyplats/fremont/fieldnotes/t45nr104w_c186fn.pdf</a>
		Township Exterior Plats
4372	1891	<a href="https://www.wy.blm.gov/cadastral/countyplats/hotsprings/fieldnotes/ext2534.pdf">https://www.wy.blm.gov/cadastral/countyplats/hotsprings/fieldnotes/ext2534.pdf</a>
3254	1882	<a href="https://www.wy.blm.gov/cadastral/countyplats/hotsprings/fieldnotes/ext3254.pdf">https://www.wy.blm.gov/cadastral/countyplats/hotsprings/fieldnotes/ext3254.pdf</a>
3253	1883	<a href="https://www.wy.blm.gov/cadastral/countyplats/hotsprings/fieldnotes/ext3253.pdf">https://www.wy.blm.gov/cadastral/countyplats/hotsprings/fieldnotes/ext3253.pdf</a>
3253	1883	<a href="https://www.wy.blm.gov/cadastral/countyplats/hotsprings/fieldnotes/retext2019.pdf">https://www.wy.blm.gov/cadastral/countyplats/hotsprings/fieldnotes/retext2019.pdf</a>
3251	1883	<a href="https://www.wy.blm.gov/cadastral/countyplats/fremont/fieldnotes/ext3251.pdf">https://www.wy.blm.gov/cadastral/countyplats/fremont/fieldnotes/ext3251.pdf</a>

TOWNSHIP N<sup>o</sup> 45 NORTH, RANGE N<sup>o</sup> 104 WEST OF THE SIXTH PRINCIPAL MERIDIAN, WYOMING.  
INDEPENDENT RESURVEY OF PORTION OF NORTH BOUNDARY



UNITED STATES DEPARTMENT OF THE INTERIOR  
GENERAL LAND OFFICE

Denver, Colorado, May 3, 1946  
This plat of a portion of the North Boundary of Township No. 45 North, Range No. 104 West of the Sixth Principal Meridian, Wyoming, is strictly conformable to the field notes of the survey thereof which have been examined and approved.

Washington, D.C., JULY 15, 1946  
The survey represented by this plat having been correctly executed in accordance with the requirements of law and the regulations of this office, is hereby accepted.

*W. H. Anthony*  
Supervisor of Surveys.

*Thomas O'Sullivan*  
ACTING ASSISTANT COMMISSIONER

Scale: 1 inch = 40 chains.

LINES DESIGNATED	BY WHOM SURVEYED	GROUP N <sup>o</sup>	DATE OF SPECIAL INSTRUCTIONS	WHEN SURVEYED	
				BEGUN	COMPLETED
Exterior	Atherly and Young	35	March 14, 1916	July 9, 1934	July 28, 1934

TOWNSHIP N<sup>o</sup> 45 NORTH. RANGE N<sup>o</sup> 104 WEST of the 6<sup>th</sup> Principal MERIDIAN.

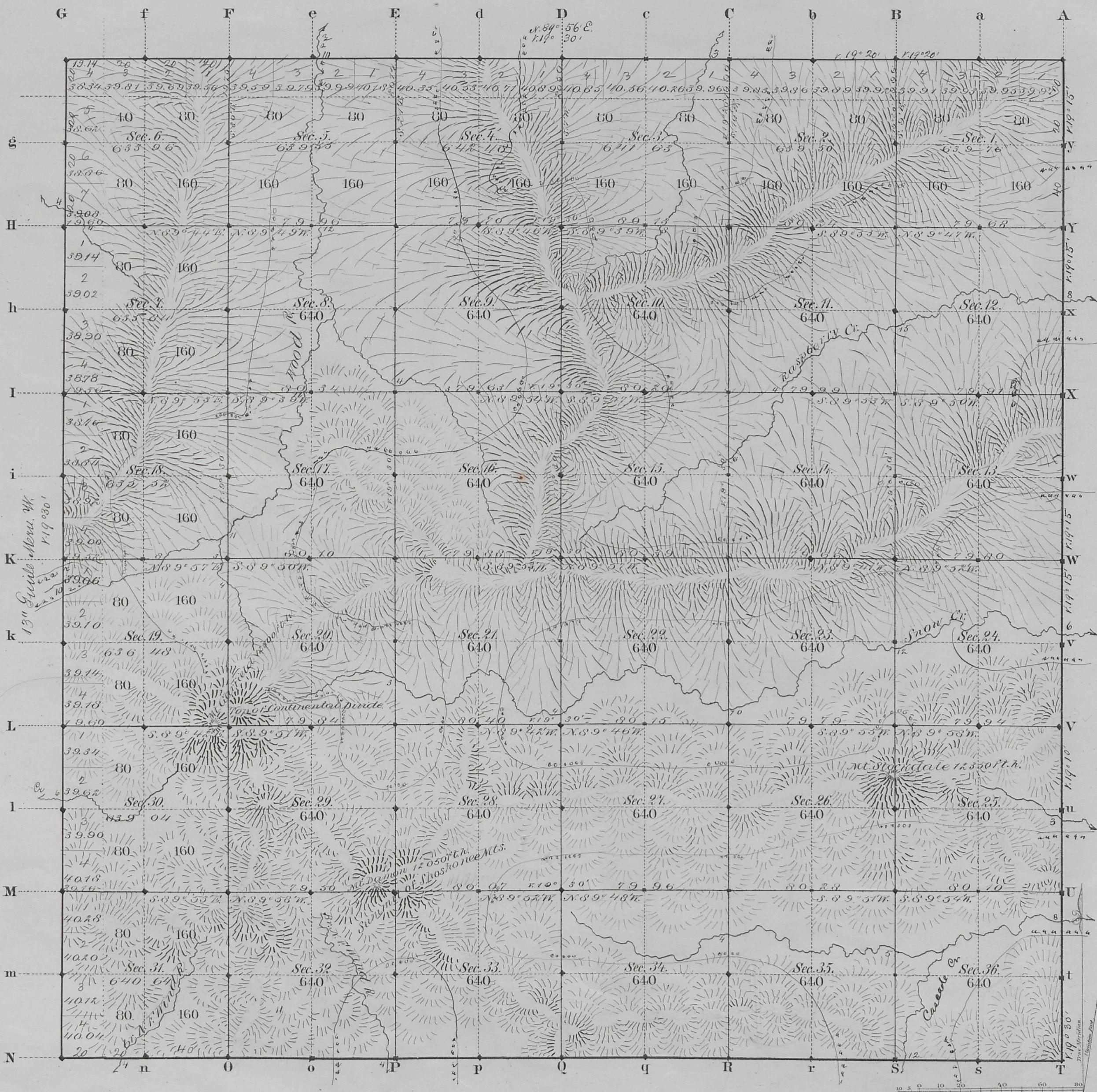

11<sup>th</sup> Land Parl. N  
West  
1.14° 30'

Total number of Acres. 23,024.40

Surveys Designated	By Whom Surveyed	Date of Contract	Amount of Surveys M <sup>o</sup> C <sup>o</sup> L <sup>o</sup>	When Surveyed	Magnetic Declination
E. of Township lines	A. J. Cavanaugh	July 10, 1882	11 74 14	Mar. 22, 23, 1883	19° 22' East
Subdivisions	"	"	59 78 13	June 10, 23, 1883	19° 30' "
Connections	"	"	5 00 00	March 7, 1883	"
11 <sup>th</sup> Land P. N.	"	"	5 00 00	Apr. 24, 7, 1883	"

The above Map of Township N<sup>o</sup> 45 North Range N<sup>o</sup> 104 West of the Sixth Principal Meridian Wyoming Territory is strictly conformable to the field notes of the survey thereof on file in this Office, which have been examined and approved

Surveyor General's Office, *Edw. C. Baird*  
Cheyenne Wyoming  
Secretary 23<sup>rd</sup> 1884

21  
 4372

# EXTERIOR LINES

Scale 1 inch = 2 miles. Mag. Var. East.

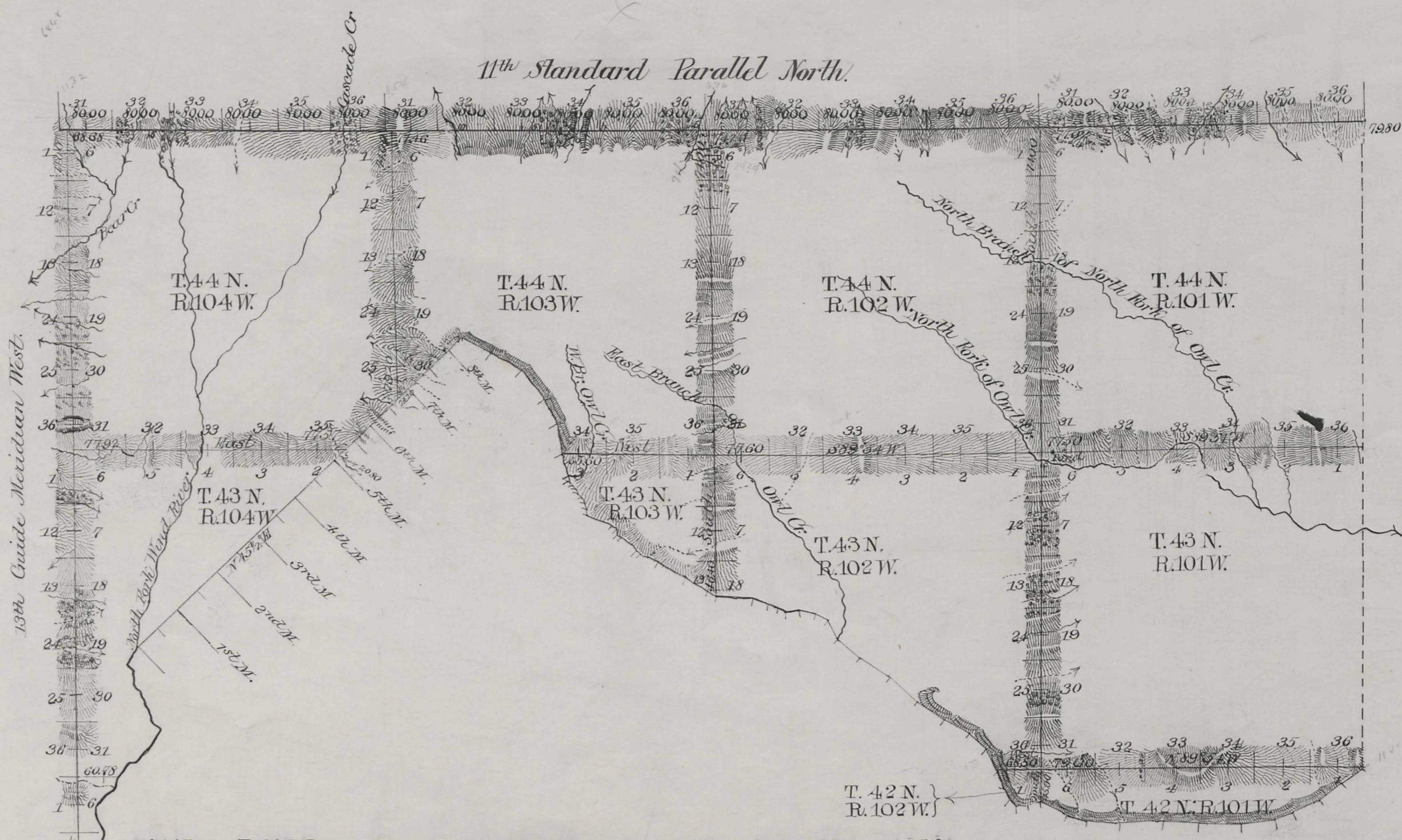

WIND RIVER OR SHOSHONE INDIAN RESERVATION

Connection lines at intermediate rates	M	CA <sup>s</sup>	LR <sup>s</sup>
Standard	0	24	20
" " " minimum	2	08	25
Exterior	4	06	89
" " " intermediate	4	10	18
Meander	4	36	70
" " " minimum	16	69	20
Boundary	3	02	20

Surveys Designated	By Whom Surveyed	Date of Contract	Approved of Surveys	Date of Survey	Magnetic Decline
Connections	Carpenter & Warner	April 1 - 1891	24 20		
13th Guide Mer.	"	"	13 52 25	July 24 - 25 - 1891	17° 32' East
11th Standard Par.	"	"	24 00 00	July 19 - 23 - 1891	17° 41' East
Exteriors	"	"	53 17 07	Sept. 1 - 8 - 1891	17° 36' "
Meanders	"	"	21 25 20	Sept. 9 - 11 - 1891	17° 30' "
Boundary	"	"	3 02 20	Aug. 30 - 1891	17° 35' "

I hereby certify that the above diagram of the 13th Guide Meridian West in Townships 42, 43 and 44 North, the 11th Standard Parallel North in Ranges 101, 102, 103 and 104 West, the Exterior lines of Fractional Townships 42 North, Ranges 101, 102 and 104 West, Townships 43 North Range 101 West, Fractional Townships 43 North, Ranges 102, 103 and 104 West, Townships 44 North Ranges 101 and 102 West, Fractional Townships 44 North, Ranges 103 and 104 West; The Meander lines of Fractional Townships 42 North, Ranges 101 and 102 West, Fractional Townships 43 North Ranges 102 and 103 West, Fractional Township 44 North, Range 103 West; and the South West Boundary line of Fractional Township 44 North, Range 103 West, and the South East Boundary of Fractional Township 44 North, Range 104 West of the 6th Principal Meridian Wyoming, is strictly conformable to the field notes of the survey thereof which have been examined and approved.

Surveyor General's Office  
 Cheyenne Wyo. May 27<sup>th</sup> 1892

*Wm. A. Richards*  
 Surveyor General

2534

(25)  
Index

3254

### 11<sup>th</sup> STANDARD PARALLEL NORTH

Along the S. bdy of T<sup>p</sup>. 45 N. R's 102, 103 + 104 W. of the 6<sup>th</sup> P.M. Wyoming Territory  
Scale 40 C<sup>ts</sup> to 1 inch. Mag. Var. East.  
Course West.

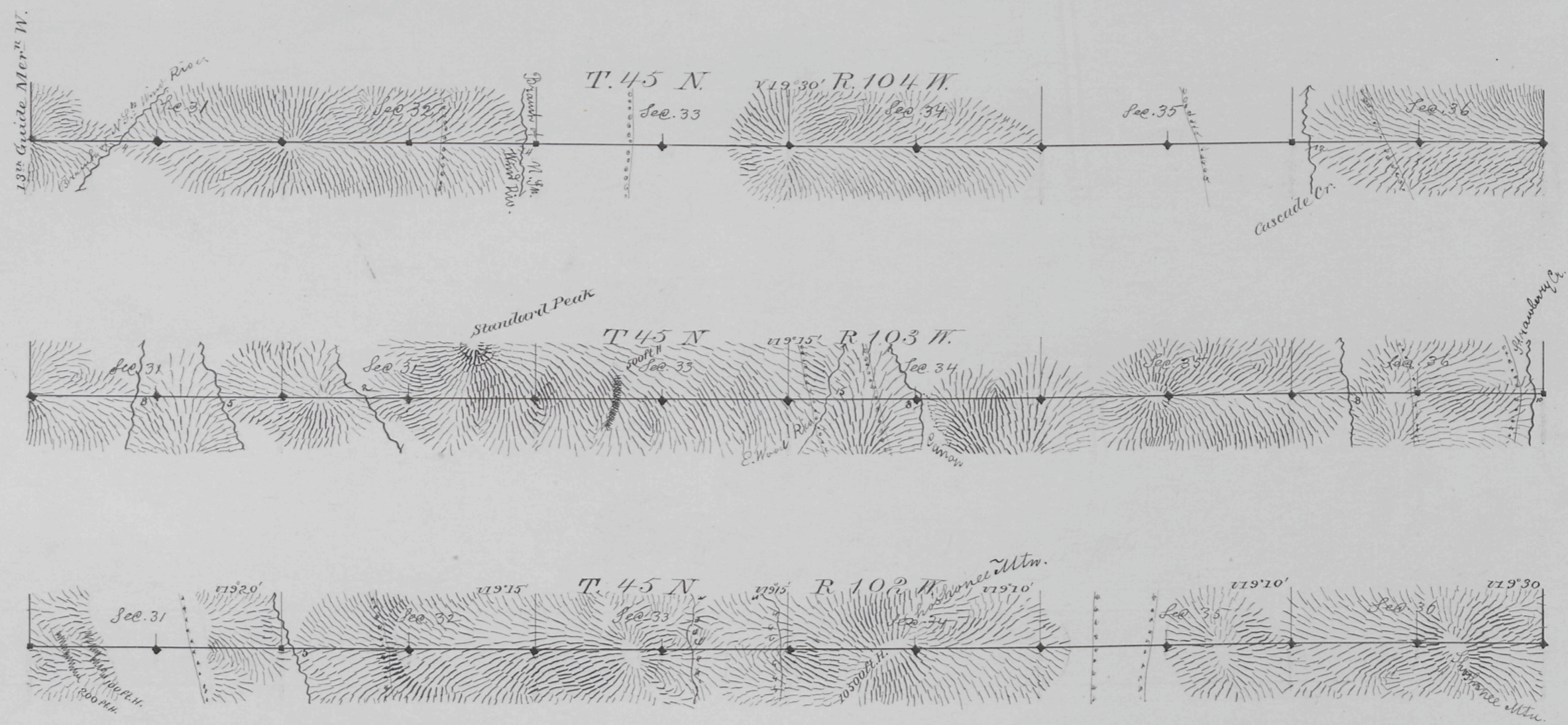

Survey Designated	By Whom Surveyed	Date of Contract	Amount of Survey			When Surveyed
			N <sup>ts</sup>	C <sup>ts</sup>	E <sup>ts</sup>	
11 <sup>th</sup> Stand. Par. N.	N. J. Barnham	July 10, 1882	78	0	0	March 5-7, 1883

The above diagram of the 11<sup>th</sup> Stand. Par. N. Along the S. bdy of T<sup>p</sup>. 45 N. Ranges 102, 103 + 104 W. of the 6<sup>th</sup> P.M. Wyo. Ter. is strictly conformable to the field notes of the survey on file in this Office, which have been examined and approved.

Surveyor General's Office,  
Cheyenne Wyo. Feb. 23, 1884.

*Edw. C. Davis*  
Sur<sup>r</sup> Gen.

(25)  
Indexed

3253

# EXTERIOR LINES.

Scale 3 miles to 1 inch Magnetic Variation, East.

pd  
KB  
E

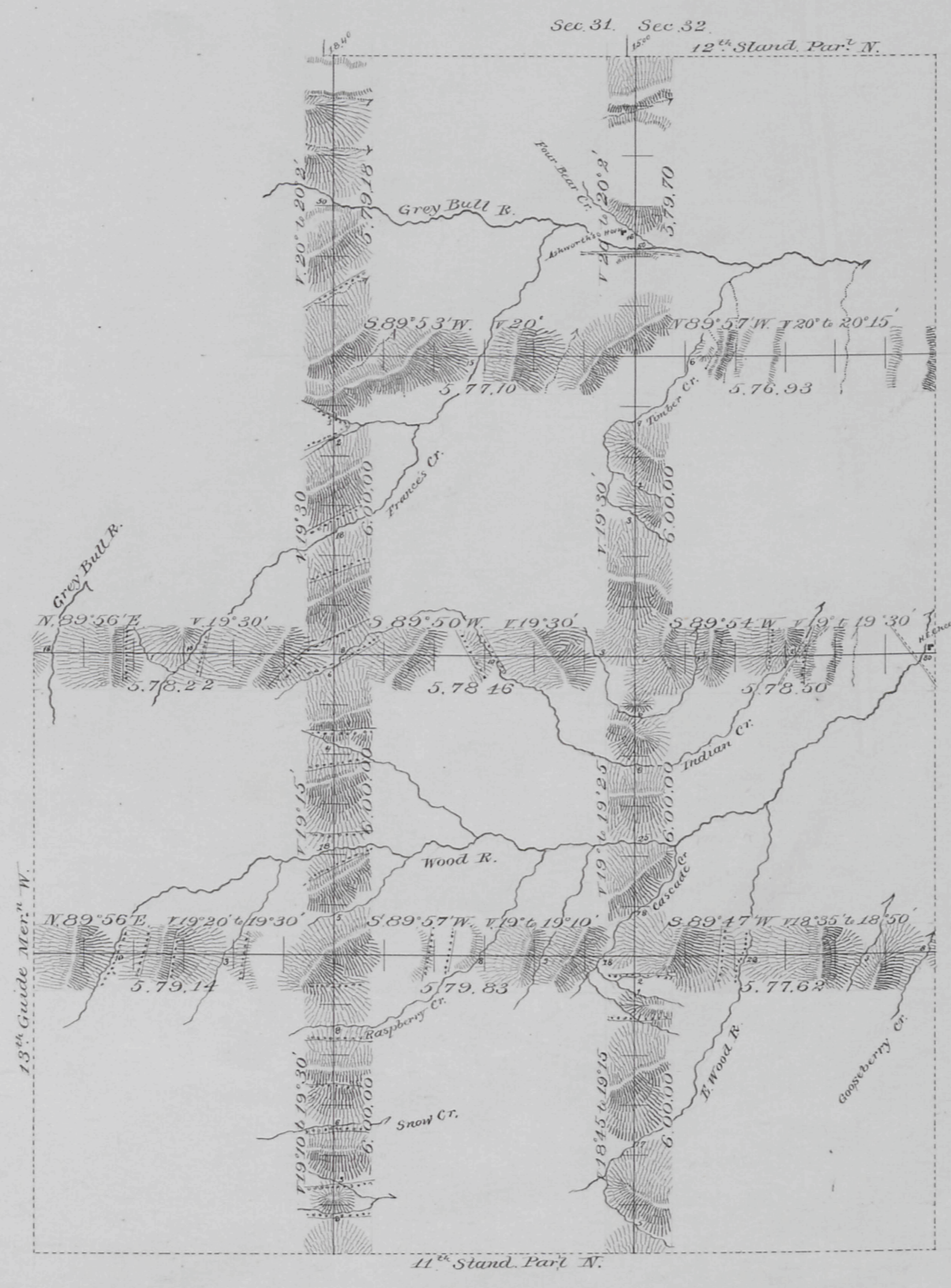

T. 48N.

T. 47N.

T. 46N.

T. 45N.

R. 104W.

R. 103W.

R. 102W.

Surveys Designated.	By Whom Surveyed	Date of Contract.	Amount of Surveys			When Surveyed.
			secs	cts	lks	
Exterior lines	N.J. Burnham	July 10 <sup>th</sup> 1882	95	64	68	March 12-29 1883
Connections	"	"		33	40	"

I hereby certify that the above diagram of the Exterior lines of Townships 45, 46, 47 & 48 N., R's 102 & 103 W., and Tps 45 & 46 N., R. 104 W. of the 6<sup>th</sup> P.M. Wyo. Ter. is strictly conformable to the field notes of the survey thereof on file in this office, which have been examined and approved.

Surveyor General's Office,  
Cheyenne Wyoming February 23 1884 } Edw. C. Davis  
Surveyor General

(25)  
Index

3251

# 13<sup>TH</sup> GUIDE MERIDIAN WEST.

Along the West Bound<sup>ry</sup> of Townships 45, 46, 47 & 48 North Range 104 West of the 6<sup>th</sup> Prin. Mer. Wyoming Ter.

Mag. Var. East.

Scale 40 Chains to 1 inch.

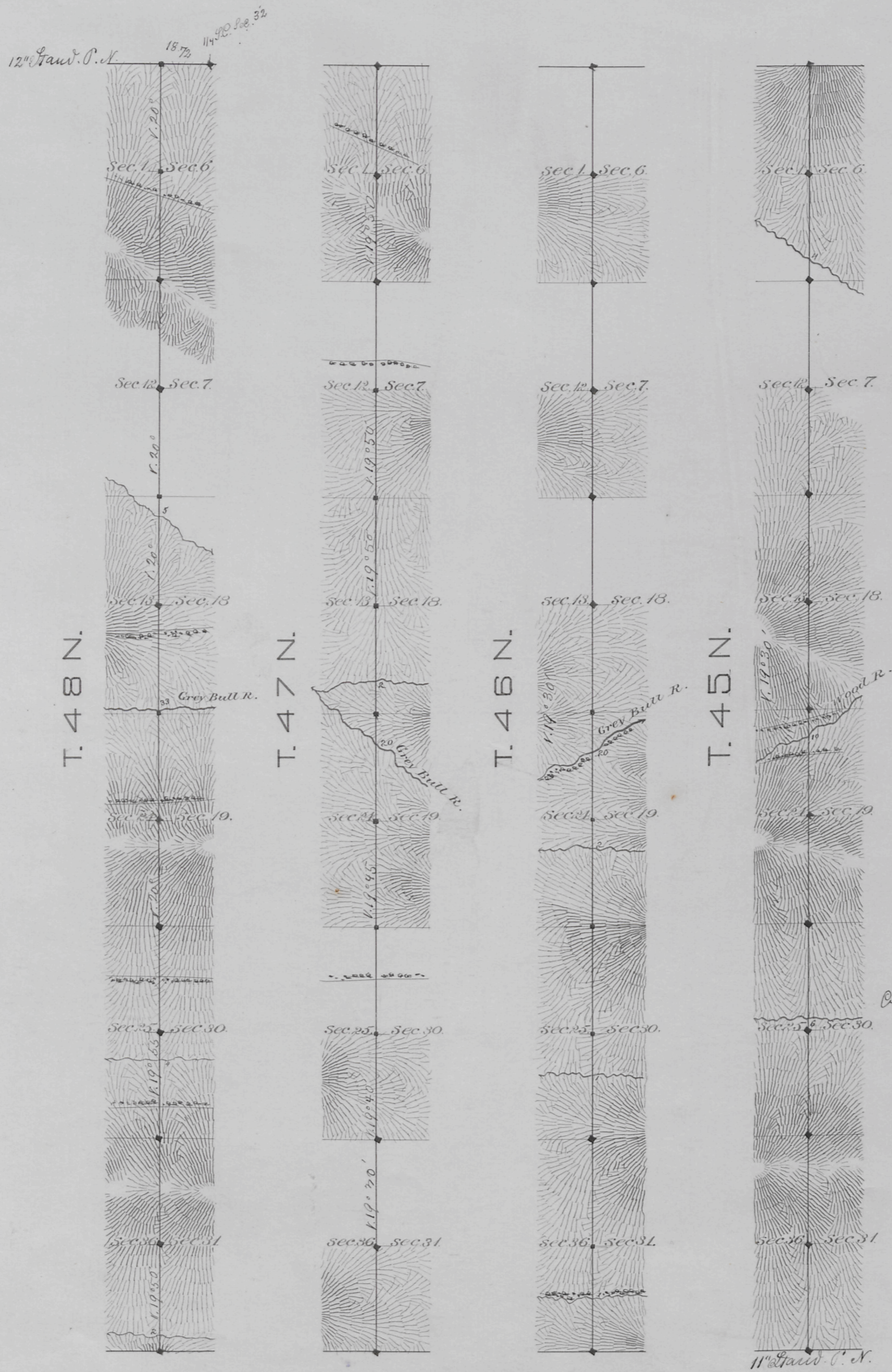

Surveys Designated By Whom Surveyed	Date of Contract	Amount of Surveys			When Surveyed.
		M <sup>rs</sup>	C <sup>hs</sup>	L <sup>ts</sup>	
13 <sup>th</sup> Guide Mer. W. N. J. Burnham	July 10, 1882	24	0	0	M <sup>rs</sup> 7-9, 1883

I hereby certify that the above diagram of the 13<sup>th</sup> Guide Mer<sup>idian</sup> West of the 6<sup>th</sup> Prin. Mer. Wyo. Ter. along the West Bound<sup>ry</sup> of Tps. 45, 46, 47, 48 North Range 104, is strictly conformable to the field notes of the survey thereof on file in this Office, which have been examined and approved.

Surveyor Gen<sup>l</sup> Office  
Cheyenne, Wyo. Feb. 23, 1884

*Edw. C. David*  
Sur<sup>veyor</sup> Gen<sup>l</sup>

## T. 45 N., R. 104 W., Sixth Principal Meridian, Wyoming, Field Note Links

Plat Accession Number(s)	Year(s) of Survey	
		Mineral Survey No. 141 (Sections 1 and 2)
5544	1901	<a href="https://www.wy.blm.gov/cadastral/mineralsurvey/100-149/ms141.pdf">https://www.wy.blm.gov/cadastral/mineralsurvey/100-149/ms141.pdf</a>
		Mineral Survey No. 142 (Section 1)
5545	1901	<a href="https://www.wy.blm.gov/cadastral/mineralsurvey/100-149/ms142.pdf">https://www.wy.blm.gov/cadastral/mineralsurvey/100-149/ms142.pdf</a>
		Mineral Survey No. 143 (Section 1)
5546	1901	<a href="https://www.wy.blm.gov/cadastral/mineralsurvey/100-149/ms143.pdf">https://www.wy.blm.gov/cadastral/mineralsurvey/100-149/ms143.pdf</a>
		Mineral Survey No. 148 (Sections 13 and 14)
5551	1901	<a href="https://www.wy.blm.gov/cadastral/mineralsurvey/100-149/ms148.pdf">https://www.wy.blm.gov/cadastral/mineralsurvey/100-149/ms148.pdf</a>
		Mineral Survey No. 149 (Sections 11 and 12)
5552	1901	<a href="https://www.wy.blm.gov/cadastral/mineralsurvey/100-149/ms149.pdf">https://www.wy.blm.gov/cadastral/mineralsurvey/100-149/ms149.pdf</a>
		Mineral Survey No. 181 (Sections 1, 2, 11, and 12)
5584	1902	<a href="https://www.wy.blm.gov/cadastral/mineralsurvey/150-199/ms181.pdf">https://www.wy.blm.gov/cadastral/mineralsurvey/150-199/ms181.pdf</a>



## T. 45 N., R. 104 W., Sixth Principal Meridian, Wyoming, Field Note Links

Plat Accession Number(s)	Year(s) of Survey	
		Mineral Survey No. 242 (Section 1)
5642	1903	<a href="https://www.wy.blm.gov/cadastral/mineralsurvey/200-249/ms242.pdf">https://www.wy.blm.gov/cadastral/mineralsurvey/200-249/ms242.pdf</a>
		Mineral Survey No. 243 (Section 12)
5643	1903	<a href="https://www.wy.blm.gov/cadastral/mineralsurvey/200-249/ms243.pdf">https://www.wy.blm.gov/cadastral/mineralsurvey/200-249/ms243.pdf</a>
		Mineral Survey No. 249 (Section 12)
5649	1903	<a href="https://www.wy.blm.gov/cadastral/mineralsurvey/200-249/ms249.pdf">https://www.wy.blm.gov/cadastral/mineralsurvey/200-249/ms249.pdf</a>
		Mineral Survey No. 251 (Sections 11, 12, 13, and 14)
5651	1903	<a href="https://www.wy.blm.gov/cadastral/mineralsurvey/250-299/ms251.pdf">https://www.wy.blm.gov/cadastral/mineralsurvey/250-299/ms251.pdf</a>
		Mineral Survey No. 256 (Sections 1, 2, 11, and 12)
5655	5655	<a href="https://www.wy.blm.gov/cadastral/mineralsurvey/250-299/ms256.pdf">https://www.wy.blm.gov/cadastral/mineralsurvey/250-299/ms256.pdf</a>
		Mineral Survey No. 258 (Sections 2 and 3)
5657	1904	<a href="https://www.wy.blm.gov/cadastral/mineralsurvey/250-299/ms258.pdf">https://www.wy.blm.gov/cadastral/mineralsurvey/250-299/ms258.pdf</a>

## T. 45 N., R. 104 W., Sixth Principal Meridian, Wyoming, Field Note Links

Plat Accession Number(s)	Year(s) of Survey	
		Mineral Survey No. 259 (Section 12)
5658	1904	<a href="https://www.wy.blm.gov/cadastral/mineralsurvey/250-299/ms259.pdf">https://www.wy.blm.gov/cadastral/mineralsurvey/250-299/ms259.pdf</a>
		Mineral Survey No. 307 (Sections 11, 12, and 14)
5698	1904	<a href="https://www.wy.blm.gov/cadastral/mineralsurvey/300-349/ms307.pdf">https://www.wy.blm.gov/cadastral/mineralsurvey/300-349/ms307.pdf</a>
		Mineral Survey No. 319 (Sections 12 and 13)
5711	1905	<a href="https://www.wy.blm.gov/cadastral/mineralsurvey/300-349/ms319.pdf">https://www.wy.blm.gov/cadastral/mineralsurvey/300-349/ms319.pdf</a>
		Mineral Survey No. 321 (Sections 13 and 24)
5713	1905	<a href="https://www.wy.blm.gov/cadastral/mineralsurvey/300-349/ms321.pdf">https://www.wy.blm.gov/cadastral/mineralsurvey/300-349/ms321.pdf</a>
		Mineral Survey No. 322 (Section 12 and 13)
5714	1905	<a href="https://www.wy.blm.gov/cadastral/mineralsurvey/300-349/ms322.pdf">https://www.wy.blm.gov/cadastral/mineralsurvey/300-349/ms322.pdf</a>
		Mineral Survey No. 373 (Section 11)
5766	1906	<a href="https://www.wy.blm.gov/cadastral/mineralsurvey/350-399/ms373.pdf">https://www.wy.blm.gov/cadastral/mineralsurvey/350-399/ms373.pdf</a>

## T. 45 N., R. 104 W., Sixth Principal Meridian, Wyoming, Field Note Links

Plat Accession Number(s)	Year(s) of Survey	
		Mineral Survey No. 375 (Section 12)
5768	1906	<a href="https://www.wy.blm.gov/cadastral/mineralsurvey/350-399/ms375.pdf">https://www.wy.blm.gov/cadastral/mineralsurvey/350-399/ms375.pdf</a>
		Mineral Survey No. 378 (Sections 11 and 14)
5769	1906	<a href="https://www.wy.blm.gov/cadastral/mineralsurvey/350-399/ms378.pdf">https://www.wy.blm.gov/cadastral/mineralsurvey/350-399/ms378.pdf</a>
		Mineral Survey No. 393 (Section 12)
5783	1907	<a href="https://www.wy.blm.gov/cadastral/mineralsurvey/350-399/ms393.pdf">https://www.wy.blm.gov/cadastral/mineralsurvey/350-399/ms393.pdf</a>
		Mineral Survey No. 408 (Section 24)
5796; 5797	1907	<a href="https://www.wy.blm.gov/cadastral/mineralsurvey/400-449/ms408.pdf">https://www.wy.blm.gov/cadastral/mineralsurvey/400-449/ms408.pdf</a>
		Mineral Survey No. 409 (Section 12)
5798	1907	<a href="https://www.wy.blm.gov/cadastral/mineralsurvey/400-449/ms409.pdf">https://www.wy.blm.gov/cadastral/mineralsurvey/400-449/ms409.pdf</a>
		Mineral Survey No. 410 (Sections 12 and 13)
5799; 5800	1907	<a href="https://www.wy.blm.gov/cadastral/mineralsurvey/400-449/ms410.pdf">https://www.wy.blm.gov/cadastral/mineralsurvey/400-449/ms410.pdf</a>

## T. 45 N., R. 104 W., Sixth Principal Meridian, Wyoming, Field Note Links

Plat Accession Number(s)	Year(s) of Survey	
		Mineral Survey No. 411 (Sections 12 and 13)
5801	1907	<a href="https://www.wy.blm.gov/cadastral/mineralsurvey/400-449/ms411.pdf">https://www.wy.blm.gov/cadastral/mineralsurvey/400-449/ms411.pdf</a>
		Mineral Survey No. 413 (Section 1)
5803	1907	<a href="https://www.wy.blm.gov/cadastral/mineralsurvey/400-449/ms413.pdf">https://www.wy.blm.gov/cadastral/mineralsurvey/400-449/ms413.pdf</a>
		Mineral Survey No. 414 (Section 12)
5804; 5805	1907	<a href="https://www.wy.blm.gov/cadastral/mineralsurvey/400-449/ms414.pdf">https://www.wy.blm.gov/cadastral/mineralsurvey/400-449/ms414.pdf</a>
		Mineral Survey No. 434 (Sections 21 and 22)
5824	1908	<a href="https://www.wy.blm.gov/cadastral/mineralsurvey/400-449/ms434.pdf">https://www.wy.blm.gov/cadastral/mineralsurvey/400-449/ms434.pdf</a>
		Mineral Survey No. 491 (Section 12)
5879	1914	<a href="https://www.wy.blm.gov/cadastral/mineralsurvey/450-499/ms491.pdf">https://www.wy.blm.gov/cadastral/mineralsurvey/450-499/ms491.pdf</a>
		U.S. Location Monument No. 18 (Section 24)
-	1907	<a href="https://www.wy.blm.gov/cadastral/countyplats/fremont/fieldnotes/uslm18_fn.pdf">https://www.wy.blm.gov/cadastral/countyplats/fremont/fieldnotes/uslm18_fn.pdf</a>

## T. 45 N., R. 104 W., Sixth Principal Meridian, Wyoming, Field Note Links

Plat Accession Number(s)	Year(s) of Survey	U.S. Location Monument No. 19 (Section 15)
-	1908	<a href="https://www.wy.blm.gov/cadastral/countyplats/fremont/uslm19.PDF">https://www.wy.blm.gov/cadastral/countyplats/fremont/uslm19.PDF</a>
-	1908	<a href="https://www.wy.blm.gov/cadastral/countyplats/fremont/fieldnotes/uslm19_fn.pdf">https://www.wy.blm.gov/cadastral/countyplats/fremont/fieldnotes/uslm19_fn.pdf</a>