

T. 46 N., R. 105 W., Sixth Principal Meridian, Wyoming, Field Note Links

Plat Accession Number(s)	Year(s) of Survey	Township Exterior Plats
3251	1883	https://www.wy.blm.gov/cadastral/countyplats/fremont/fieldnotes/ext3251.pdf
		Yellowstone National Park Boundary
5963	1893	https://www.wy.blm.gov/cadastral/countyplats/fremont/fieldnotes/ynp_0013fn.pdf

DIAGRAM
OF THE
N.E. & S. BOUNDARIES
OF THE
PUBLIC FOREST RESERVATION
AND THE
FRAC.E. BOUNDARY
OF THE
YELLOWSTONE NATIONAL PARK
IN
WYOMING

As surveyed by Philip M. Gallaher U.S. Deputy Surveyor Aug. 3rd to Oct. 22nd 1893, under his contract No. 263 dated Oct. 17, 1894.

Scale 1/2 in = 1 mile
 O indicates corners established
 + indicates proper points for corners but not established

I certify that the above diagram of the N.E. & S. Boundaries of the Public Forest Reservation and the Frac.E. Boundary of the Yellowstone National Park in Wyoming, is strictly conformable to the field notes of the survey thereof on file in this office which have been examined and approved.

U.S. Surveyor's Office
 Helena Mont July 17, 1894.

Joseph H. Weil
 Surveyor General
 for Montana

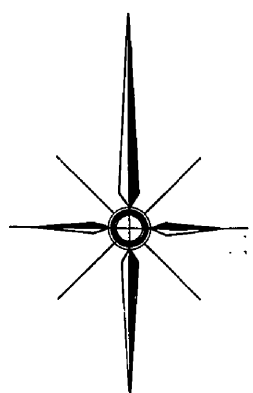

YELLOWSTONE NATIONAL PARK

YELLOWSTONE LAKE

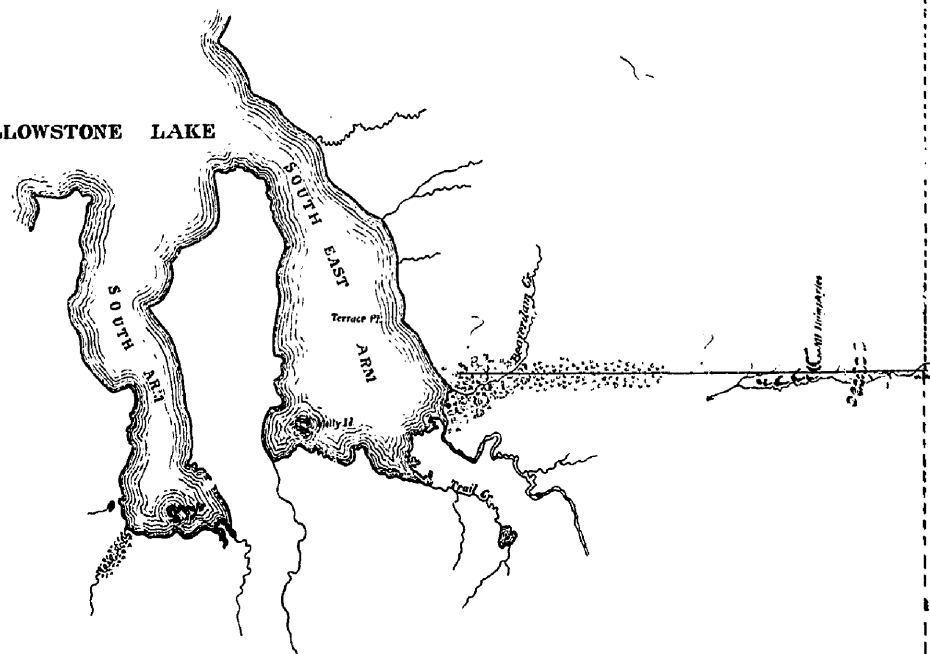

FOREST RESERVATION

PUBLIC

W Y O M I N G

13 I D A H O

25M
26M
27M
28M
29M
30M
31M
32M
33M
34M
35M
36M
37M
38M
39M
40M
41M
42M
43M
44M
45M
46M
47M
48M
49M
50M
51M
52M
53M
54M
55M
56M
57M
58M
59M
60M
61M
62M
63M
64M
65M
66M
67M
68M
69M
70M
71M
72M
73M
74M
75M
76M
77M
78M
79M
80M
81M
82M
83M
84M
85M
86M
87M
88M
89M
90M
91M
92M
93M
94M
95M
96M
97M
98M
99M
100M

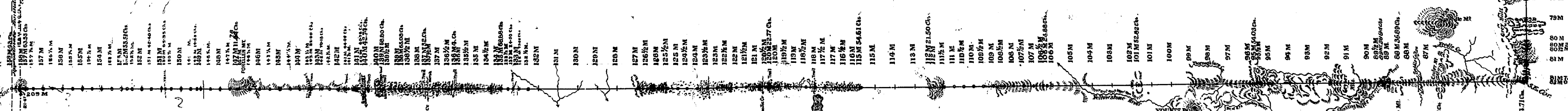

(25)
Index

3251

13TH GUIDE MERIDIAN WEST.

Along the West Bound^{ry} of Townships 45, 46, 47 & 48 North Range 104 West of the 6th Prin. Mer. Wyoming Ter.

Mag. Var. East.

Scale 40 Chains to 1 inch.

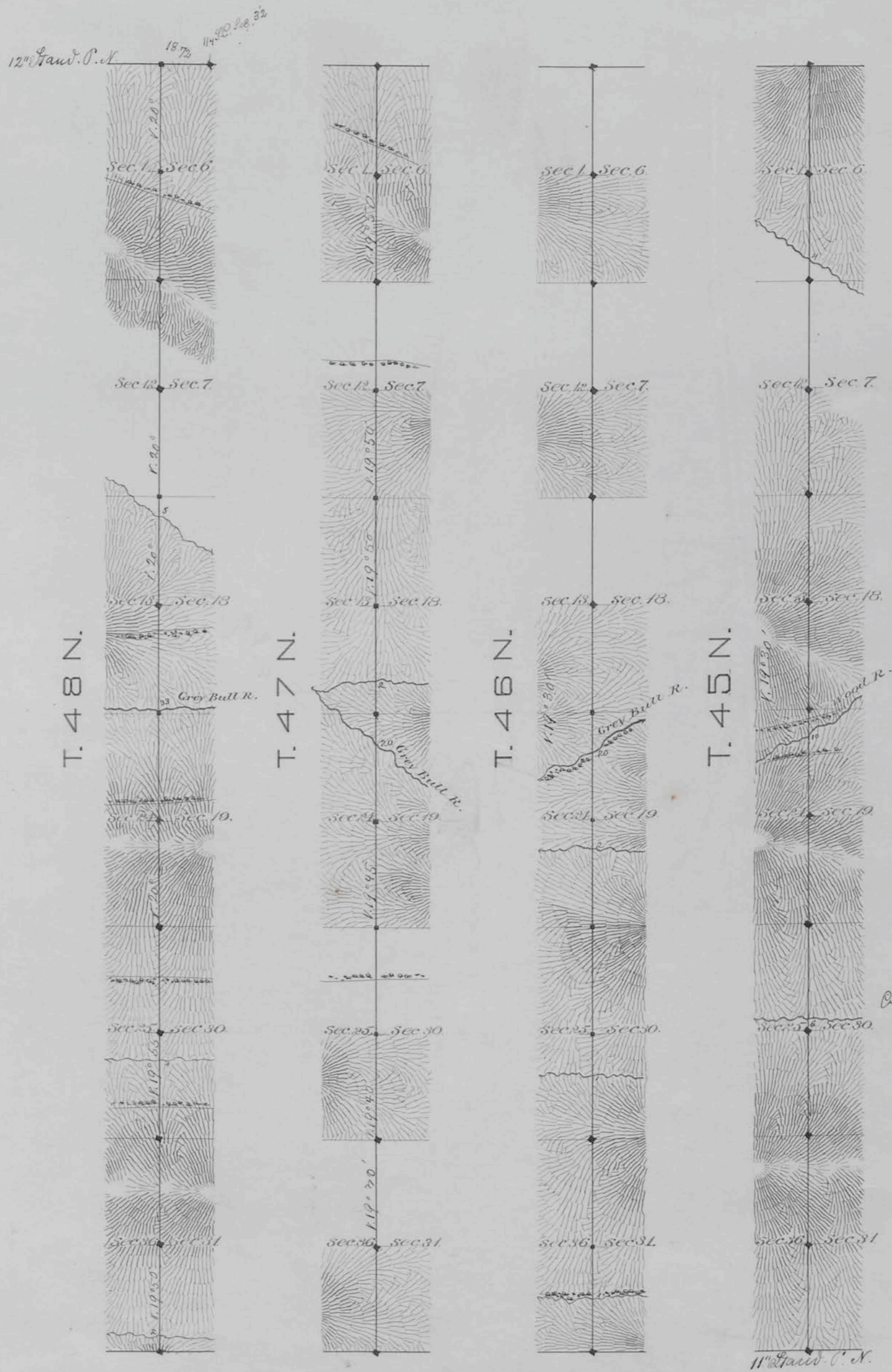

Surveys Designated By Whom Surveyed	Date of Contract	Amount of Surveys		When Surveyed
		Acres	Sq. Rods	
13 th Guide Mer. W. N.J. Burnham	July 10, 1832	24	0	18 th 7-9, 1833

I hereby certify that the above diagram of the 13th Guide Mer^y West of the 6th Prin. Mer. Wyo. Ter. along the West Bound^{ry} of Tps. 45, 46, 47, 48 North Range 104 is strictly conformable to the field notes of the survey thereof on file in this Office, which have been examined and approved.

Surveyor Gen^l Office
Cheyenne, Wyo. Feb. 23, 1834

Edw. C. David
Sur^g Gen^l