

T. 27 N., R. 117 1/2 W., Sixth Principal Meridian, Wyoming, Field Note Links

Plat Accession Number(s)	Year(s) of Survey	Township Subdivision Plats
6052	1932-34	https://www.wy.blm.gov/cadastral/countyplats/lincoln/fieldnotes/t27nr117.5w_gp118fn.pdf

60536052

ORIGINAL

FRACTIONAL TOWNSHIP N° 27 NORTH, RANGE N° 117½ WEST OF THE SIXTH PRINCIPAL MERIDIAN, WYOMING.

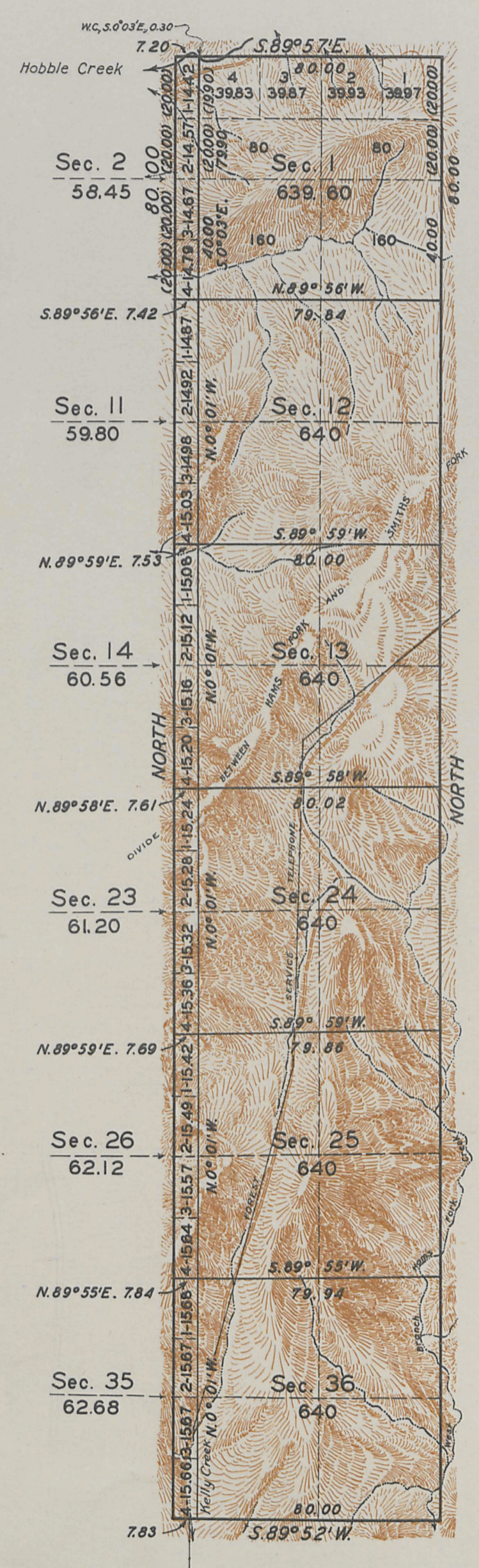

SURVEY AUTHORIZED BY COMMISSIONER'S LETTER "E" DATED MARCH 11, 1931.

LATITUDE 42° 16' N.
LONGITUDE 110° 47' W.

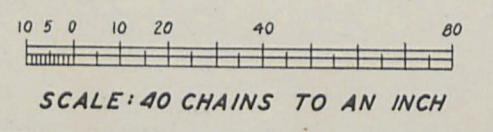

AREA SURVEYED 4 204.41 ACRES

LINES DESIGNATED	BY WHOM SURVEYED	GROUP		MILEAGE		WHEN SURVEYED	
		NO.	DATE	MLS.	CHS.	BEGUN	COMPLETED
SUBDIVISIONAL E.&N. BDRS.	CRAWFORD & MACDONALD	118	APR. 30, 1931	11	37.65	JUNE 9, 1934	JUNE 21, 1934
W. BDY.	VOIGT & PETERSEN	"	"	7	7.20	"	"
S. BDY.	LEO M. PETERSEN	"	"	6	0.00	JUNE 24, 1932	JULY 6, 1932
		"	"	1	7.83	SEPT. 7, 1933	SEPT. 7, 1933

OFFICE OF U.S. SUPERVISOR OF SURVEYS
DENVER, COLORADO. MAY 23, 1935.
THE ABOVE PLAT OF TOWNSHIP NO. 27 NORTH, RANGE NO. 117½ WEST OF THE SIXTH PRINCIPAL MERIDIAN, WYOMING, IS STRICTLY CONFORMABLE TO THE FIELD NOTES OF THE SURVEY THEREOF WHICH HAVE BEEN EXAMINED AND APPROVED

Wm. H. Johnson
U.S. SUPERVISOR OF SURVEYS

DEPARTMENT OF THE INTERIOR
GENERAL LAND OFFICE
WASHINGTON, D.C. JUNE 13, 1935.
THE SURVEY REPRESENTED BY THIS PLAT HAVING BEEN CORRECTLY EXECUTED IN ACCORDANCE WITH THE REQUIREMENTS OF LAW AND THE REGULATIONS OF THIS OFFICE IS HEREBY ACCEPTED.

Antoinette Frank
ASSISTANT COMMISSIONER

MDK

3003

Trans. made to Evanston L.O.
Jan. 22, 1936. 27-117½