

FIELD NOTES
PUBLIC SURVEY

3849-3852

VOL. 418
1910-1913

INDEX

VOL. 418. 1910-1913.

Page 1 Subdivision 55-103.-3849

Page 255 Subdivision 55-102.-3850

Page 389 Subdivision 56-102.-3851

Page 577 Subdivision 56-103.-3852

577

BOOK No. G-1

RECEIVED S. G. O.
DEC 21 1911
CHEYENNE, WYO.

FIELD NOTES

OF

The survey of the Private Land Claims, and
resurvey of subdivision

The lines of

Township 56 N.,

Range 103

West of the Sixth Principal Meridian in Wyoming.

INDEXED
aw

RE SURVEYED BY

United States

Albert B. Bartlett, Deputy Surveyor,

his Under contract No. 341, dated August 16, 1909

Survey commenced May 25, 1911

Survey completed June 18, 1911

Platted by

....., 190

Copied for Washington by

....., 190

Copied for Register by

....., 190

Transcribed by S.L.

October 1912.

O-S.L.

J-K.L.D.

3852

NAMES AND DUTIES OF ASSISTANTS.

Clarence C. Lusby Chainman.

James A. Cain Chainman.

..... Axman.

Walter L. Hoffmann Moundsman.

Albert Park Moundsman

Argus E. Lewallen Flagman.

Foster Watkins Axman.

Howell F. Hayslette Flagman.

INDEX.

Township 56 N., Range 103 W.

		106			100			100			99	
6	93	5	70	4	53	3	38	2	21	1		
									(192)			
91		90		69		52		37		20		
7	89	8	67	9	51	10	36	11	19	12		
			(217)						(212)			
87		85		66		51		35		17		
		(217)		(216)				(213)		(212)		
18	83	17	63	16	50	15	34	14	15	13		
			(216)						(211)			
82		81		62		49		32		12		
								(213)		(211)		
19	79	20	61	21	48	22	30	23	10	24		
							(213)		(200)			
78		77		60		46		28		8		
						(215)		(198)		(201)		
30	75	29	57	28	44	27	26	26	6	25		
			(216)		(215)		(193)		(201)			
74		72		56		42		25		5		
		(217)				(206)		(195)		(210)		
31	71	32	54	33	40	34	22	35	3	36		
			(215)		(214)			(203)				

Preliminary Oaths in Book B.

PRIVATE LAND CLAIMS
T. 56N., R. 103W.

Tract	Page
67	108
69	109
74	111
37	114
75	115
73	116
64	117 (206)
63	118
68	119
39	120
40	121
61	121
62	122
56	123 (203)
38	125
42	126
70	126 (200)
49	126 (197)
48	127
41	127
59	130
65	130
71	131 (202)
72	136

<i>Tract</i>	<i>Page</i>
51	138
52	138
43	139
50	139
60	143
66	143
80	188
53	144 (190)
44	149
45	149
46	153
47	154
54	156
55	157
52	159
77	163
76	165
37	in book F
57	" " E
58	" " D
{ 78	2 20
Surveyed by Walter E. Hoffman	

<i>Section</i>	<i>Page</i>
33	107
31	113
28	115
34	116
35	120 (194)

Section	Page
36	125
25	125 (197)
26	130 (192) (202)
27	135
24	137
23	142
14	144 (196)
30-56-102	145
19 " "	148
18 " "	150
7 " "	152
13	156
12	160
16	163
9	164
1	165 (184)
8	166
15	166
22	166
Minerals	

*Index to Retracements of
Fourteenth Standard Parallel through
T56 N R103W*

Page

99

100

106

107

77 in Book F

Meanders

Hogan Reservoir page 166

Luce Reservoir page 167

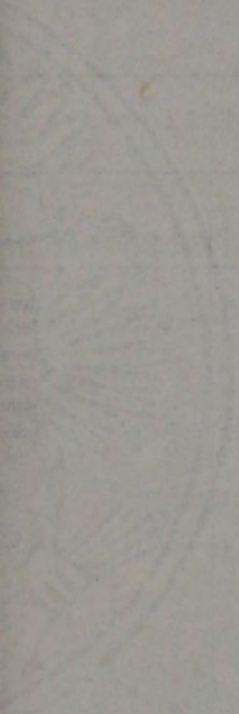

Y230A1
00-43979-00

(a)

ABSTRACT OF ENTRIES IN T. 56 N.,
WITH THEIR DESCRIPTION

Description by Original Survey			
Entry		Entryman	Subdivision
Kind	No.		
Lieu Sel	List 2	Northern Pacific Railway Company	Lots 1, 2, 3.
SL		Wyoming	SE $\frac{1}{4}$ NE $\frac{1}{4}$, N $\frac{1}{2}$ SE $\frac{1}{4}$
SL		Wyoming	W $\frac{1}{2}$ SW $\frac{1}{4}$
SL		Wyoming	W $\frac{1}{2}$ SE $\frac{1}{4}$
Pre Cash	148	Zachariar T. Brown	S $\frac{1}{2}$ NW $\frac{1}{4}$, E $\frac{1}{2}$ SW $\frac{1}{4}$
DE	04056	E. M. Schmidt	S $\frac{1}{2}$ NE $\frac{1}{4}$, W $\frac{1}{2}$ SE $\frac{1}{4}$, NW $\frac{1}{4}$ NE $\frac{1}{4}$
HE	04057	E. J. Johnston	E $\frac{1}{2}$ SW $\frac{1}{4}$, N $\frac{1}{2}$ NW $\frac{1}{4}$
SL		Wyoming	SW $\frac{1}{4}$ NE $\frac{1}{4}$, N $\frac{1}{2}$ SE $\frac{1}{4}$, SW $\frac{1}{4}$ NW $\frac{1}{4}$

(a)

R. 103 W. BY ORIGINAL SURVEY
BY RESURVEY.

			Description
			by
Sec.	Status L. O.	Resurvey	
1	Pat.	Tract 80	
8	Valid	SW $\frac{1}{4}$ NW $\frac{1}{4}$, N $\frac{1}{2}$ SW $\frac{1}{4}$, Sec. 8.	
9	Valid	Lots 4, 7, 8, Sec. 8.	
9	Valid	Lots 5, 6, Sec. 8.	
9	Pat.	Tract 76	
12	Valid	Tract 55	
13			
12	Valid	Tract 54	
13			
13	Valid	Lots 4, 5, 10, sec. 13; lots 1, 2, 6, SE $\frac{1}{4}$ NE $\frac{1}{4}$ sec. 14.	
13	Valid		

ABSTRACT OF ENTRIES IN T. 56 N.,
WITH THEIR DESCRIPTION

Description by Original Survey			
Entry		Entryman	Subdivisor
Kind	No.		
DE	706	Augusta A. Brough	SE $\frac{1}{4}$ NE $\frac{1}{4}$
DE	1006	David H. Teel	SE $\frac{1}{4}$ NW $\frac{1}{4}$, N $\frac{1}{2}$ SW $\frac{1}{4}$, NE $\frac{1}{4}$ SE $\frac{1}{4}$
DE	1056	Joseph C. Brown	S $\frac{1}{2}$ SW $\frac{1}{4}$, SW $\frac{1}{2}$ SE $\frac{1}{4}$
SL		Wyoming	SE $\frac{1}{4}$ SE $\frac{1}{4}$
SL		Wyoming	SW $\frac{1}{4}$ NW $\frac{1}{4}$, N $\frac{1}{2}$ SW $\frac{1}{4}$, S $\frac{1}{2}$ S $\frac{1}{2}$
SS		Wyoming	All
SL		Wyoming	E $\frac{1}{2}$, N $\frac{1}{2}$ NW $\frac{1}{4}$, NE $\frac{1}{4}$ SW $\frac{1}{4}$, SE $\frac{1}{4}$ NW $\frac{1}{4}$
SL		Wyoming	NW $\frac{1}{4}$, N $\frac{1}{2}$ NE $\frac{1}{4}$

R. 103 W. BY ORIGINAL SURVEY
BY RESURVEY.

		Description by Resurvey	
Sec.	Status L. O.		
13	Valid	Tract 78	
13	Can.		
14			
13	Valid	Tract 52	
14	Valid	SW $\frac{1}{4}$ SW $\frac{1}{4}$, sec. 14	
15	Valid	SE $\frac{1}{4}$, SW $\frac{1}{4}$ NW $\frac{1}{4}$, Sec. 15	
16	Valid	Tract 77	
22	Valid	Lots 1, 2, 3, 4, 5, 6, NW $\frac{1}{4}$ NE $\frac{1}{4}$, N $\frac{1}{2}$ NW $\frac{1}{4}$, SW $\frac{1}{4}$ NW $\frac{1}{4}$, NW $\frac{1}{4}$ SW $\frac{1}{4}$, Sec. 22 NE $\frac{1}{4}$, N $\frac{1}{2}$ SE $\frac{1}{4}$, Sec. 21.	
23	Valid	Lots 2, 3, Sec. 23	

ABSTRACT OF ENTRIES IN T. 56 N.,
WITH THEIR DESCRIPTION

Description by Original Survey			
Entry		Entryman	Subdivision
Kind	No.		
HE	1315	Joseph C. Brown	SE $\frac{1}{4}$
DE	845	Annie E. Hogan	SW $\frac{1}{4}$
DE	780	Josephine Brown	S $\frac{1}{2}$ NE $\frac{1}{4}$, NW $\frac{1}{4}$, NW $\frac{1}{2}$ SE $\frac{1}{4}$
SL		Wyoming	N $\frac{1}{2}$ NE $\frac{1}{4}$, SW $\frac{1}{2}$ NE $\frac{1}{4}$
DE	781	Enoch Mc. H. Brown	S $\frac{1}{2}$ SE $\frac{1}{4}$, NW $\frac{1}{4}$ SE $\frac{1}{4}$, SE $\frac{1}{4}$ SW $\frac{1}{4}$
HE	1164	Enoch Mc. H. Brown	SE $\frac{1}{4}$ NE $\frac{1}{4}$, NE $\frac{1}{4}$ SE $\frac{1}{4}$, Lots 2, 3, T. 56 N. R. 102 <u>W.</u>
DE	616	George Schnit- ker	E $\frac{1}{2}$ NE $\frac{1}{4}$ Lot 4, T. 56 N. R. 102 W. Lot 11, T. 56 N. R. 102 W.

R. 103 W. BY ORIGINAL SURVEY
BY RESURVEY.

			Description
Sec.	Status L. O.	by Resurvey	
23	Pat.	Tract 60	
23	Valid	Tract 66	
23 24	Valid	Tract 51	
24	Valid	Lots 11,12, Sec.13 Lot 7, Sec.14, Lots 1,4, Sec.23, Lots 3,4, Sec.24.	
24	Pat.	Tract 50	
24	Pat.	Tract 43	
19			
25 19	Pat.	Tract 42	
30			

ABSTRACT OF ENTRIES IN T. 56 N.,
WITH THEIR DESCRIPTION BY

Description by Original Survey			
Entry		Entryman	Subdivision
Kind	No.		
DE	1071	Laura A. Schnitker	NW $\frac{1}{4}$
HE	2024	Owen C. Bevelhymer	NW $\frac{1}{4}$ SE $\frac{1}{4}$, NE $\frac{1}{4}$ SW $\frac{1}{4}$, S $\frac{1}{2}$ SW $\frac{1}{4}$
HE	0905	Jacob Bevelhymer	E $\frac{1}{2}$ SE $\frac{1}{4}$, SW $\frac{1}{4}$ SE $\frac{1}{4}$ Lot 4, T. 56 N.R. <u>102 W.</u>
DE	1059	Frank Richards	W $\frac{1}{2}$ NE $\frac{1}{4}$
DE	922	John E. Brown	N $\frac{1}{2}$ NE $\frac{1}{4}$, SW $\frac{1}{4}$ NE $\frac{1}{4}$ NE $\frac{1}{4}$ NW $\frac{1}{4}$
DE	1111	Alonza Bozarth	SE $\frac{1}{4}$ NE $\frac{1}{4}$
DE	1253	Julia Leonhard	NW $\frac{1}{4}$ SE $\frac{1}{4}$, E $\frac{1}{2}$ SW $\frac{1}{4}$, NE $\frac{1}{4}$ NW $\frac{1}{4}$
DE	1055	Frank A. Wapples	NW $\frac{1}{4}$ SW $\frac{1}{4}$ E $\frac{1}{2}$ SE $\frac{1}{4}$ NE $\frac{1}{4}$ NE $\frac{1}{4}$
DE	1005	Edwin Manning	SW $\frac{1}{4}$ SE $\frac{1}{4}$ W $\frac{1}{2}$ NE $\frac{1}{4}$, SE $\frac{1}{4}$ NW $\frac{1}{4}$

8

R.103 W. BY ORIGINAL SURVEY

BY RESURVEY,

			Description
	Sec.	Status L. O.	by Resurvey
	25	Can.	
	25	Valid	Tract 48
	25 30	Valid	Tract 41
	25	Can.	
	26	Valid	Tract 59
	26	Can.	
	26 35	Valid	Tract 62
	25 26 35	Can.	
	26 35	Can. Valid	Tract 61

ABSTRACT OF ENTRIES IN T. 56 N.,
WITH THEIR DESCRIPTION

Description by Original Survey			
Entry		Entryman	Subdivision
Kind	No.		
DE	1054	Emma Manning	W $\frac{1}{2}$ SW $\frac{1}{4}$ SE $\frac{1}{4}$ SE $\frac{1}{4}$ NE $\frac{1}{4}$ NE $\frac{1}{4}$
HE	150	William O. Pound	NW $\frac{1}{4}$ NW $\frac{1}{4}$ E $\frac{1}{2}$ NE $\frac{1}{4}$, NE $\frac{1}{4}$ SE $\frac{1}{4}$
SL		Wyoming	SW $\frac{1}{2}$ SE $\frac{1}{4}$
SL		Wyoming	S $\frac{1}{2}$ S $\frac{1}{2}$
Lieu Sel	03534	Northern Pacific Railway Com- pany	NE $\frac{1}{4}$ SW $\frac{1}{4}$
HE	783	Mary J. Palmer	N $\frac{1}{2}$ SW $\frac{1}{4}$, SE $\frac{1}{4}$ SW $\frac{1}{4}$ SE $\frac{1}{4}$ NW $\frac{1}{4}$
HE	732	Archie Beaton	S $\frac{1}{2}$ NE $\frac{1}{4}$, NW $\frac{1}{4}$ NE $\frac{1}{4}$ NE $\frac{1}{4}$ NW $\frac{1}{4}$
SL		Wyoming	NE $\frac{1}{4}$ NE $\frac{1}{4}$
SL		Wyoming	N $\frac{1}{2}$ NW $\frac{1}{4}$, NW $\frac{1}{4}$ NE $\frac{1}{4}$
HE	1617	Edwin Manning	S $\frac{1}{2}$ NE $\frac{1}{4}$ W $\frac{1}{2}$ NW $\frac{1}{4}$

R. 103 W. BY ORIGINAL SURVEY
BY RESURVEY.

		Description	
Sec.	Status L. O.	by Resurvey	
26. 27 34	Can.		
26 27	Pat.	Tract 65	
27	Pat.	Tract 72	
28	Pat.	Tract 75	
31	Valid	Tract 37 <u>T. 56 N.R. 104 W.</u>	
33	Pat.	Tract 67	
33	Pat.	Tract 69	
33	Valid	Tract 74	
34	Pat.	Tract 73	
34 35	Valid	Tract 63	

ABSTRACT OF ENTRIES IN T. 56 N.,
WITH THEIR DESCRIPTION

Description by Original Survey			
Entry		Entryman	Subdivision
Kind	No.		
DE	838	Milton Gorsuch	SW $\frac{1}{4}$ SW $\frac{1}{4}$ NW $\frac{1}{4}$ SW $\frac{1}{4}$, Lot 4. SW $\frac{1}{4}$ NW $\frac{1}{4}$, T. 55 N., R. 103 W.
DE	1036	Maud G. Luce	SW $\frac{1}{4}$, NW $\frac{1}{4}$ SE $\frac{1}{4}$
HE	982	John Smith	SE $\frac{1}{4}$ NE $\frac{1}{4}$, E $\frac{1}{2}$ SE $\frac{1}{4}$. SW $\frac{1}{4}$ SE $\frac{1}{4}$
SS		Wyoming	All

12
R. 103 W. BY ORIGINAL SURVEY
BY RESURVEY.

		Description by Resurvey	
Sec.	Status L. O.		
34 3	Pat.	Tract 68	
35	Valid	Tract 40	
35	Pat.	Tract 39	
36	Valid	Tract 38	

598

596-597

Blank

COPY.

OFFICE OF COMMISSIONER
OF PUBLIC LANDS,
CHEYENNE, WYOMING.

I, S. G. HOPKINS, Commissioner of Public Lands of the State of Wyoming, do hereby waive the right of the State of Wyoming to require that the Carey Act lands embraced in approved Segregation List No. 39, and lying in Township 56 North, Range 103 West, shall be set off in their original locations in the resurvey executed by Albert B. Bartlett under Contract No. 341, and hereby accept for the State

of Wyoming, in lieu thereof, the list hereinafter shown, which said list approximates the original location of the lands as segregated.

Township 56 North, Range 103 West.

Original Survey			Resurvey as desired by the State of Wyoming.		
Description	Sec.	Acreage	Description	Sec.	Acreage
SE $\frac{1}{4}$ NE $\frac{1}{4}$	8	40.00	SW $\frac{1}{4}$ NW $\frac{1}{4}$	8	40.00
N $\frac{1}{2}$ SE $\frac{1}{4}$	8	80.00	N $\frac{1}{2}$ SW $\frac{1}{4}$	8	80.00
W $\frac{1}{2}$ SW $\frac{1}{4}$	9	80.00	Lot 4	8	36.00
			Lot 7	8	16.96
			Lot 8	8	38.60
W $\frac{1}{2}$ SE $\frac{1}{4}$	9	80.00	Lot 5	8	23.13
			Lot 6	8	35.54
SW $\frac{1}{4}$ NE $\frac{1}{4}$	13	160.00	Lot 4	13	10.09
N $\frac{1}{2}$ SE $\frac{1}{4}$	13		Lot 5	13	29.93
SW $\frac{1}{4}$ NW $\frac{1}{4}$	13		Lot 10	13	30.43
			Lot 2	14	19.72
			Lot 1	14	20.08
			Lot 6	14	20.85
			SE $\frac{1}{4}$ NE $\frac{1}{4}$	14	40.00

Township 56 North, Range 103 West.

Original Survey			Resurvey as desired by the State of Wyoming.		
Descrip- tion	Sec.	Acre- age	Descrip- tion	Sec.	Acre- age
SE $\frac{1}{4}$ SE $\frac{1}{4}$	14	40.00	SW $\frac{1}{4}$ SW $\frac{1}{4}$	14	40.00
S $\frac{1}{2}$ SE $\frac{1}{4}$	15	280.00	S $\frac{1}{2}$	15	320.00
SW $\frac{1}{4}$	15		SW $\frac{1}{4}$ NW $\frac{1}{4}$	15	40.00
SW $\frac{1}{4}$ NW $\frac{1}{4}$	15				
E $\frac{1}{2}$	22	480.00	Lot 1	22	30.81
N $\frac{1}{2}$ NW $\frac{1}{4}$	22		Lot 2	22	34.08
SE $\frac{1}{4}$ NW $\frac{1}{4}$	22		Lot 3	22	31.06
NE $\frac{1}{4}$ SW $\frac{1}{4}$	22		Lot 4	22	18.72
			Lot 5	22	11.37
			Lot 6	22	31.62
			NW $\frac{1}{4}$ NE $\frac{1}{4}$	22	40.00
			N $\frac{1}{2}$ NW $\frac{1}{4}$	22	80.00
			SW $\frac{1}{4}$ NW $\frac{1}{4}$	22	40.00
			NW $\frac{1}{4}$ SW $\frac{1}{4}$	22	40.00
			NE $\frac{1}{4}$	21	160.00
			N $\frac{1}{2}$ SE $\frac{1}{4}$	21	80.00
NW $\frac{1}{4}$	23	240.00	Lot 2	23	10.78
N $\frac{1}{2}$ NE $\frac{1}{4}$	23		Lot 3	23	22.53
N $\frac{1}{2}$ NE $\frac{1}{4}$	24	120.00	Lot 11	13	29.50
SW $\frac{1}{4}$ NE $\frac{1}{4}$	24		Lot 12	13	20.00
			Lot 7	14	9.54
			Lot 1	23	20.39
			Lot 4	23	11.34
			Lot 3	24	10.66
			Lot 4	24	30.64
Total.....		1,600.00	Total.....		1,604.37

IN WITNESS WHEREOF, I have hereunto
set my hand and seal this fourth day
of November, A. D. 1913.

S. G. Hopkins,

Commissioner of Public Lands

(SEAL)

Commissioner of Public Lands.

SEAL.

Wyoming.

Subdivision of Twp 56 N., R. 103 W.

chains.

Survey commenced May 25, 1911, and executed with a Young and Sons Light Mountain Transit No. 7524, fitted with Smith Solar Attachment. The horizontal limb is provided with two double opposite verniers each reading to single minutes of arc, which is also the least count of the latitude and declination arcs.

The instrument was examined, tested on the true meridian at Cheyenne, found correct, and was approved by the Surveyor General for Wyoming, August 31, 1910.

I examine the adjustments of the transit and find them correct; then to test the solar apparatus, by comparing its indication resulting from solar observations made during a.m. and p.m. hours with a meridian determined by observations on Polaris, I proceed as follows:

At camp in the NW $\frac{1}{4}$ of NW $\frac{1}{4}$ of Sec 27, Twp 56 N., R. 103 W. in lat. $44^{\circ} 48\frac{1}{2}'$ N., longitude $109^{\circ} 15'$ W., I set off $44^{\circ} 48\frac{1}{2}'$ N. on the lat. arc; $20^{\circ} 56\frac{1}{2}'$ N. on the decl. arc; and at

Chains.

6h 00_m p.m. l.m.t. determine with the solar a true meridian and mark a point thereof on a stake firmly driven in the ground 5 chs. N. of my station.

May 25, 1911.

May 26: At 3h 20_m a.m. l.m.t. I observe Polaris at eastern elongation in accordance with Manual of Instructions and mark a point in the line thus determined on a stake driven firmly in the ground 5 chs. N. of my station.

At 5h 45_m a.m. l.m.t. I lay off the azimuth of Polaris $1^{\circ} 39'$ to the west and mark the meridian thus determined by a tack in the stake set May 25, on which the meridian falls 0.3 ins. west of the mark determined by the solar.

At 6h 00_m a.m. l.m.t. I set off $44^{\circ} 48\frac{1}{2}'$ N. on the lat. arc; $21^{\circ} 02'$ N. on the decl. arc; and mark a point in the meridian determined with the solar on the stake already set 5 chs. N. of my station; this mark falls

3.
Resurvey of

Subdivision of Twp 56 N., R. 103 W.

Chains.

0.2 ins. west of the meridian established by the Polaris observation. The solar apparatus by p.m. and a.m. observations determines positions for meridians, respectively about 0' 16" east and 0' 10" west of the meridian established by Polaris observations; therefore, I conclude that the adjustments of the instrument are satisfactory.

The magnetic bearing of the true meridian at 7h^{a.m.l.m.t.} 30^m is N. 18° 55' W., the angle thus determined gives the mag. decl. 18° 55' E.

I begin at the cor. of secs. 1, 2, 35, and 36, ^{on the S. bdy. of Twp.} which I set November 1, 1910.

June 7: At 6h.00^m. a.m. l.m.t. I set off 44° 47' N. on the lat. arc; 22° 43' N. on the decl. arc; and determine with the solar a true meridian at this cor.

Thence I run

N. 0° 01' W. bet. secs. 35 and 36.

Asc. on hilly SE slope.

6.52

Intersect line 3-4 TR 38 at a point from which cor. No. 4 bears N. 89° 55' E.

See page 217

606

Resurvey of

Subdivision of Twp 56 N., R. 103 W.

Chains.

29.83 chs. dist.

Set an iron post, 3 ft. long, 1 in. in dia., 26 ins. in the ground for closing Cor. of fractl secs. 35 and 36, marked on brass cap

T 56 N R 103 W TR 38 CC in N. half

S 36 in SE and

S 35 in SW quadrant.

Thence across TR 38

II.10 Fence ^{bears} NE and SW

15.00 Desc. on N. slope.

40.00 Set an iron post, 3 ft. long, 1 in. in dia., 26 ins. in the ground for $\frac{1}{4}$ Sec Cor., marked on brass cap $\frac{1}{4}$ S 35 on W. half and S 36 on E. half, and raise a mound of stone, 2 ft. base, $1\frac{1}{2}$ ft. high W. of Cor. Pits impracticable.

80.00 Set an iron post, 3 ft. long, 2 ins. in dia., 24 ins. in the ground for Cor. of secs. 25, 26, 35, and 36, marked on brass cap

T 56 N S 26 in NW

R 103 W S 25 in NE

S 36 in SE and

S 35 in SW quadrant, and raise a mound of stone, 2 ft. base, $1\frac{1}{2}$ ft.

Subdivision of Twp 56 N., R. 103 W.

chains.

high, W. of Con Pits impracticable.
Land, hilly.

Soil, rocky, 3rd rate.

Vegetation, sagebrush and grass.

S. $89^{\circ} 59'$ E. on a random line bet.
secs. 25 and 36.

40.00 Set temp. $\frac{1}{4}$ Sec Con

30.12 Intersect E. bdy. of Twp at con of secs.
25, 30, 31, and 36, which I set
November 24, 1910.

Thence I run

N. $89^{\circ} 59'$ W. on a true line bet. secs.
25 and 36.

Asc. on rolling E. slope.

8.50 Desc. on hilly W. slope.

0.06 Set an iron post, 3 ft. long, 1 in.
in dia., 26 ins. in the ground for
 $\frac{1}{4}$ Sec Con, marked on brass cap $\frac{1}{4}$ S 25
on N. half and S 36 on S. half, and
raise a mound of stone, 2 ft. base,
 $1\frac{1}{2}$ ft. high, N. of Con Pits impracti-
cable.

0.11 Intersect line 4-I TR 38 at a point
from which con No. 1 bears N. $0^{\circ} 02'$
E. 7.54 chs. dist.

See page 210

Set an iron post, 3 ft. long, 1 in. in

TRANSCRIBED COPY OF
ORIGINAL FIELD NOTES

607

Resurvey of

Subdivision of Twp 56 N., R. 103 W.

chains.

high, W. of Cor. Pits impracticable.
Land, hilly.
Soil, rocky, 3rd rate.
Vegetation, sagebrush and grass.

S. 89° 59' E. on a random line bet.
secs. 25 and 36.

40.00

Set temp. $\frac{1}{4}$ Sec Cor.

80.12

Intersect E. bdy. of Twp at Cor. of secs.
25, 30, 31, and 36, which I set
November 24, 1910.

Thence I run

N. 89° 59' W. on a true line bet. secs.
25 and 36.

Asc. on rolling E. slope.

38.50

Desc. on hilly W. slope.

40.06

Set an iron post, 3 ft. long, 1 in.
in dia., 26 ins. in the ground for
 $\frac{1}{4}$ Sec Cor, marked on brass cap $\frac{1}{4}$ S 25
on N. half and S 36 on S. half, and
raise a mound of stone, 2 ft. base,
1 $\frac{1}{2}$ ft. high, N. of Cor. Pits impracti-
cable.

50.11

40.06

Intersect line 4-I TR 33 at a point
from which Cor. No. 1 bears N. 0° 02'
E. 7.54 chs. dist.

Set an iron post, 3 ft. long, 1 in. in

608

Resurvey of

Subdivision of Twp 56 N., R. 103 W.

Chains.

dia., 26 ins. in the ground for
closing cor of fract. secs. 25 and
36, marked on brass cap

T 56 N TR 38 CC in W. half

R 103 W S 25 in NE

S 36 in SE quadrant.

Thence across TR 38 on black line.

76.00 Draw, course N. 60° W., asc.

80.12 The cor of secs. 25, 26, 35, and 36.

Land, rolling 38.50 chs., hilly 41.65
chs.

Soil, loam and rocky, 2nd and 3rd rate.

Vegetation, sagebrush and grass.

N. 0° 01' W. bet. secs. 25 and 26.

Across TR 38 on black line.

Desc. on hilly land.

3.80 Draw, course S. 60° W., asc.

6.45 Fence ^{bears} E. and W.

7.46 Intersect line 5-6 TR 41 at a point
from which Cor No. 5 bears S. 89° 49'
W. 10.16 chs. dist.

Thence across TR 41 on black line.

8.70 Desc. on rocky bench.

25.00 Desc. on hilly land.

27.68 Intersect line 7-8 TR 48 at a point
from which Cor No. 8 bears N. 89°

7.
Reaurrey of
Subdivision of Twp 56 N., R. 103 W.

Chains.

48' E. 9.88 chs. dist.

Thence across TR 48

27.95 Fence N. 60° E. and S. 60° W. ^{bears}

30.43 Fence ^{bears} NW and SE.

31.40 Ditch, 3 lks. wide, course E.

32.30 Paint Creek, 15 lks. wide, course N. 60° E., enter cultivated land, asc.

34.23 Ditch, 4 lks. wide, course N. 60° E., enter alfalfa.

40.00 Set an iron post, 3 ft. long, 1 in. in dia., 26 ins. in the ground for $\frac{1}{4}$ Sec. Cor., marked on brass cap $\frac{1}{4}$ S 26 on W. half and S 25 on E. half; dig pits 18X18X12 ins. N. and S. of post, 3 ft. dist; and raise a mound of earth, $3\frac{1}{2}$ ft. base, $1\frac{1}{2}$ ft. high, W. of Cor.

O. C. Bevelhymer's ranch house bears N. 17° E. 3.00 chs. dist.

J. Bevelheymer's ranch house bears N. $71\frac{1}{2}$ ° E. approximately 15.00 chs. dist.

2.60 O. C. Bevelhymer's cellar.

45.40 Ditch, 3 lks. wide, course N. 60° E.

47.30 Fence ^{bears} E. and W., leave alfalfa ^{bears} E. and SW. Desc. rolling N. slope.

7.92 Intersect line 3-4 TR 70 at a point

610

Recovery of

Subdivision of Twp 56 N., R. 103 W.

Chains.

see page 201

from which Cor No. 4 bears N. 89°
46' E. 9.89 chs. dist.

see page 200

~~Thence across TR 70. on black line.~~

54.40

Ditch, 5 lks. wide, course E.

80.00

Set an iron post, 3 ft. long, 2 ins.
in dia., 24 ins. in the ground for
Cor of secs. 23, 24, 25, and 26,
marked on brass cap

T 56 N S 23 in NW

R 103 W S 24 in NE

S 25 in SE and

S 26 in SW quadrant, and raise a

mound of stone, 2 ft. base, 1½ ft.
high, W. of Cor. Pits impracticable.

Land, hilly 31.00 chs.; rolling 49.00
chs.

Soil, loam and rocky, 2nd and 3rd rate.
Vegetation, sagebrush, alfalfa and
grass.

S. 89° 59' E. on a random line bet.
secs. 24 and 25.

40.00

Set temp. ¼ Sec Cor

80.08

Intersect E. bdy. of Twp 2 lks. S. of
Cor of secs. 19, 24, 25, and 30,
which I set November 24, 1910.

Thence I run

Chains.

West on a true line bet. secs. 24 and 25.

Asc. over hilly E. slope.

19.08 Road ^{bears} S. 30° E. and N. 30° W.

20.08 Fence ^{bears} N. 30° E. and S. 30° W.

29.00 Desc. W. slope.

31.97 Intersect line 8-9 TR 42 at a point from which Cor. No. 9 bears N. 0° II' W. 8.52 chs. dist.

See page 210
Set an iron post, 3 ft. long, 1 in. in dia., 26 ins. in the ground for closing Cor. of fract. secs. 24 and 25, marked on brass cap.

T 56 N TR 42 CC in W. half

R 103 W S 24 in NE and

S 25 in SE quadrant.

Thence across TR 42

36.58 Paint Creek, 15 lks. wide, course N., asc. on rolling land.

40.04 Set an iron post, 3 ft. long, 1 in. in dia., 26 ins. in the ground for $\frac{1}{4}$ Sec Cor., marked on brass cap $\frac{1}{4}$ S 24 on N. half and S 25 on S. half; dig pits 18X18X12 ins. E. and W. of post 3 ft. dist; and raise a mound of earth, $3\frac{1}{2}$ ft. base, $1\frac{1}{2}$ ft. high, N. of Cor.

Chains.

- 9 G. Schnitker's ranch house bears N.
31½° W. 17.00 chs. dist.
- E.M. Brown's ranch house bears N. 5° W.
approximately 35.00 chs. dist.
- 40.38 Fence ^{bears} N. and S., enter alfalfa.
- 53.15 Ditch, 4 lks. wide, course N. 15° E.,
leave alfalfa.
- 53.48 Road, ^{bears} N. 15° E. and S. 15° W.
- 54.00 Desc. on bench, N. slope.
- 70.08 Fence ^{bears} N. and S.
- 70.19 Intersect line 4-1 TR 70 at a point
from which Cor No. 1 bears N. 0° 01'
E. 8.47 chs. dist..
- See page 209*
~~Thence across TR 70 on line 4-1 TR 70.~~
- 80.08 The Cor. of secs. 23, 24, 25, and 26.
Land, hilly 36.58 chs., rolling 43.50
chs.
Soil, loam and rocky, 2nd and 3rd rate.
Vegetation, sagebrush, alfalfa and
grass.
-
- See page 200*
N. 0° 01' W. bet. secs. 23 and 24.
~~Across TR 70 on line 4-1 TR 70.~~
Desc. on rolling N. slope.
- 1.50 Road ^{bears} SW and NE.
- 8.42 Intersect line I-2 TR 70 at a point
from which Cor No. 1 bears N. 39° 42'

Subdivision of Twp 56 N., R. 103 W.

Chains.

- E. 9.89 chs. dist.
 Thence across TR 50 ~~to the~~ ^{bears}
- 13.15 Fence E. and W.
- 18.00 Ditch, 4 lks. wide, course E., enter cultivated land.
- 25.00 Enter pond extending 3.00 chs. E. and 5.00 chs. W. of line, E. and W.
- 33.00 Leave pond N. 80° E. and S. 80° W., asc
- 36.00 Road, ^{bears} E. and W.
- 40.00 Set an iron post, 3 ft. long, 1 in. in dia., 26 ins. in the ground for $\frac{1}{4}$ Sec Cor, marked on brass cap $\frac{1}{4}$ S 23 on W. half and S 24 on E. half, and raise a mound of stone, 2 ft. base, $1\frac{1}{2}$ ft. high, W. of Cor. Pits impracticable.
- 42.30 Ditch, 4 lks. wide, course N. 30° E., leave cultivated land.
- 48.90 Intersect line I-2 TR 50 at a point from which Cor No. I bears N. 89° 39' E. 9.89 chs. dist.
 Set an iron post, 3 ft. long, 1 in. in dia., 26 ins. in the ground for closing Cor of fract. secs. 23 and 24, marked on brass cap
 T 56 N S 23 in NW
 R 103 W S 24 in NE quadrant and

See page 210

614

I2.
Recovery B

Subdivision of Twp 56 N., R. 103 W.

Chains.

CC TR 50 in S. half.

Thence bet. secs. 23 and 24.

51.20 Fence ^{bears} E. and W.

55.00 Desc.

80.00 Set an iron post, 3 ft. long, 2 ins.
in dia., 24 ins. in the ground for
Cor of secs. 13, 14, 23, and 24,
marked on brass cap

T 56 N S 14 in NW

R 103 W S 13 in NE

S 24 in SE and

S 23 in SW quadrant, and raise a
mound of stone, 2 ft. base, 1½ ft.
high, W. of Cor. Pits impracticable.

Land, rolling.

Soil, loam and rocky, 2nd and 3rd rate.

Vegetation, sagebrush and grass.

East on a random line bet. secs. 13
and 24.

40.00 Set temp ¼ Sec Cor.

80.00 Intersect E. bdy. of Twp at Cor of secs.
13, 18, 19, and 24, which I set
November 24, 1910.

Thence I run

West on a true line bet. secs. 13 and
24.

Resurvey of

Subdivision of Twp 56 N., R. 103 W.

Chains.

Desc. over hilly land.

8.77 Creek, 1 lk. wide, course N. 30° W.,
asc.10.73 ✓ Intersect line 5-6 TR 44 at a point
from which Cor No. 5 bears S. 0° 48'
W. 9.75 chs. dist.

See page 211

Set an iron post, 3 ft. long, 1 in.
in dia., 26 ins. in the ground for
closing Cor of fract. secs. 13 and
24, marked on brass cap

T 56 N TR 44 CC in W. half

R 103 W S 13 in NE and

S 24 in SE quadrant.

Thence across TR 44 ~~to black line~~

21.00 Desc.

26.50 Road, ^{bears} N. 20° E. and S. 20° W.26.70 Fence, ^{bears} N. 20° E. and S. 20° W., and
enter rolling bottom land.29.50 Paint Creek, 15 lks. wide, $1\frac{1}{2}$ ft. deep,
course N. 20° E., asc.31.35 Intersect line 4-5 TR 45 at a point
from which Cor No. 5 bears N. 0°
30' E. **10.13** chs. dist.Thence across TR 45 ~~to black line~~.40.00 Set an iron post, 3 ft. long, 1 in.
in dia., 26 ins. in the ground for
 $\frac{1}{4}$ Sec Cor, marked on brass cap $\frac{1}{4}$ S 13

Chains.

- on N. half and S 24 on S. half, and raise a mound of stone, 2 ft. base, 1½ ft. high, N. of Cor Pits impracticable.
- 42.00 Enter hilly land ^{bearing} N. and S.
- 48.50 Fence ^{bars} N. and S.
- 50.01 ✓ Intersect line 2-3 TR 45 at a point from which Cor. No. 3 bears S. 0° 02' W. 10.64 chs. dist.
- See page 211
Set an iron post, 3 ft. long, 1 in. in dia., 26 ins. in the ground for closing Cor. of fract. secs. 13 and 24, marked on brass cap
T 56 N S 13 in NW.
S 24 in SW quadrant and
R 103 W TR 45 CC in E. half.
- Thence bet. secs. 13 and 24.
- 58.20 Ditch, 4 lks. wide, course N. 30° E.
- 61.25 Road, ^{bars} NE and SW.
- 77.50 Fence ^{bars} NW and SE.
- 80.00 The Cor. of secs. 13, 14, 23, and 24. Land, hilly 64.70 chs., rolling 15.30 chs.
Soil, alkaline loam and rocky, 3rd and 4th rate.
Vegetation, sagebrush and grass.

I 5.
Re survey of

Subdivision of Twp 56 N., R. 103 W.

Chains.

June 7: At this Cor. I set off $22^{\circ} 42\frac{1}{2}'$ N. on the decl. arc; and at 11h. 58m. a.m.l.m.t. observe the sun on the meridian, the resulting lat. is $44^{\circ} 50' N.$ or within $30''$ of the proper lat.

N. $0^{\circ} 01' W.$ bet. secs. 13 and 14.

Desc. on rocky bench.

2.90 Fence ^{bears} NW and SE.

9.40 Intersect line 3-4 TR 52 at a point from which Cor. No. 4 bears N. $89^{\circ} 35' E.$ 9.90 chs. dist.

See page 211

Set an iron post, 3 ft. long, 1 in. in dia., 26 ins. in the ground for closing Cor. of fracl. secs. 13 and 14, marked on brass cap

T 56 N R 103 W TR 52 CC in N. half
S 13 in SE and
S 14 in SW quadrant.

Thence across TR 52

29.66 Intersect line 1-2 TR 52 at a point from which Cor. No. 1 bears N. $89^{\circ} 34' E.$ 9.91 chs. dist.

See page 212

Set an iron post, 3 ft. long, 1 in. in dia., 26 ins. in the ground for closing Cor. of fracl. secs. 13 and 14, marked on brass cap

618

Recovery of ^{16.}

Subdivision of Twp 56 N., R. 103 W.

Chains.

	T 56 N S I4 in NW
	R 103 W S I3 in NE quadrant and CC TR 52 in S. half.
	Thence bet. secs. I3 and I4.
38.65	Road, ^{bears} NE and SW.
40.00	Set an iron post, 3 ft. long, 1 in. in dia., 26 ins. in the ground for $\frac{1}{4}$ Sec Cor., marked on brass cap $\frac{1}{4}$ S I4 on W. half and S I3 on E. half, and raise a mound of stone, 2 ft. base, $1\frac{1}{2}$ ft. high, W. of cor. Pits imprac- ticable.
70.00	Clark's Fork River 2.50 chs. wide, course E., asc.
70.13	Intersect line 3-4 TR 55 at a point from which ^{true} point for Cor. No. 4 bears N. 89° 30' E. 9.92 chs. dist. Point for closing cor. of fracl. secs. I3 and I4 falls in Clarks Fork River.
	Thence across TR 55
71.46	Set an iron post, 3 ft. long, 1 in. in dia., 26 ins. in the ground for wit- ness closing cor. of fracl. secs. I3 and I4, marked on brass cap T 56 N R 103 W TR 55 WC CC in N. hal S I3 in SE and S I4 in SW quadrant.

See page 212

17.
Recovery of
 Subdivision of Twp 56 N., R. 103 W.

Chains.

- 30.00 Set an iron post, 3 ft. long, 2 ins. in dia., 24 ins. in the ground for Cor of secs. 11, 12, 13, and 14, marked on brass cap
 T 56 N S II in NW
 R 103 W S 12 in NE
 S 13 in SE and
 S 14 in SW quadrant, and raise a mound of stone, 2 ft. base, $1\frac{1}{2}$ ft. high, W. of Cor. Pits impracticable.
 Land, rolling.
 Soil, rocky, 3rd rate.
 Vegetation, sagebrush and grass.
-
- East on a random line bet. secs. 12 and 13.
- 40.00 Set temp. $\frac{1}{4}$ Sec Cor.
- 80.00 Intersect E. bdy. of Twp 2 lks N. of Cor of secs. 7, 12, 13, and 18, which I set November 24, 1910.
 Thence I run
 N. $89^{\circ} 59'$ W. on a true line bet. secs. 12 and 13.
 Desc. over rolling W. slope.
- 7.00 Road ^{bears} N. 60° E., and S. 60° W.
- 0.00 Clark's Fork River 2.50 chs. wide, course N. 60° E., asc.

620

Recovery of

18.

Subdivision of Twp 56 N., R. 103 W.

Chains.

- 40.00 Set an iron post, 3 ft. long, 1 in. in dia., 26 ins. in the ground for $\frac{1}{4}$ Sec Cor., marked on brass cap $\frac{1}{4}$ S I2 on N. half and S I3 on S. half, and raise a mound of stone, 2 ft. base, $1\frac{1}{2}$ ft. high, N. of Cor. Pits impracticable.
- M. Wagner's ranch house bears N. 47° E. approximately 40.00 chs. dist.
- 48.21 Fence ^{bears} NE and SW.
- 48.96 Fence ^{bears} N. and S.
- 70.08 Intersect line 4-5 TR 55 at a point from which ^{true point for} Cor. No. 4 bears S. 0° 01' W. **9.78** chs. dist.
- Set an iron post, 3 ft. long, 1 in. in dia., 26 ins. in the ground for closing Cor. of fracl. secs. I2 and I3, marked on brass cap
- T 56 N TR 55 CC in W. half
R 103 W S I2 in NE and
S I3 in SE quadrant.
- Thence across TR 55
- 80.00 The Cor. of secs. II, I2, I3, and I4. Land, rolling.
Soil, rocky, 3rd rate.
Vegetation, sagebrush and grass.

See page 213

Subdivision of Twp 56 N., R. 103 W.

Chains.

N. 0° 01' W. bet. secs. II and I2.

Across TR 55

Asc. over rolling land.

30.00 Desc.

40.00 Set an iron post, 3 ft. long, 1 in. in dia., 26 ins. in the ground for $\frac{1}{4}$ Sec Cor, marked on brass cap $\frac{1}{4}$ S II on W. half and S I2 on E. half, and raise a mound of stone, 2 ft. base, $1\frac{1}{2}$ ft. high, W. of Cor. Pits impracticable.

45.50 Road ^{bears} NE and SW.

50.15 Fence ^{bears} N. 80° E. and S. 80° W.

50.65 Ditch, 5 lks. wide, course E.

54.10 Lake Creek, 6 lks. wide, course N. 80° E., asc.

65.40 Road ^{bears} N. 80° E. and S. 80° W.

67.80 Fence ^{bears} E. and W.

71.10 Intersect line I-2 TR 55 at a point from which Cor No. 2 bears S. 89° 23' W. 10.21 chs. dist.

See page 212

Set an iron post, 3 ft. long, 1 in. in dia., 26 ins. in the ground for closing Cor. of fract. secs. II and I2, marked on brass cap

T 56 N S II in NW

R 103 W S I2 in NE quadrant and

622

20.

Recovery of

Subdivision of Twp 56 N., R. 103 W.

Chains.

- CC TR 55 in S. half.
- 71.15 ^{bays} Road E. and S. 80° W.
- 80.00 ¹ Set an iron post, 3 ft. long, 2 ins. in dia., 24 ins. in the ground for Cor. of secs. I, 2, II, and I2, marked on brass cap
T 56 N S 2 in NW
R 103 W S I in NE
S I2 in SE and
S II in SW quadrant, and raise a mound of stone, 2 ft. base, 1½ ft. high, W. of Cor. Pits impracticable.
Land, rolling.
Soil, rocky, 3rd rate.
Vegetation, sagebrush and grass.
-
- S. 89° 59' E. on a random line bet. secs. I and I2.
- 40.00 Set temp. ¼ Sec Cor.
- 79.98 Intersect E. bdy. of Twp at Cor. of secs. I, 6, 7, and I2, which I set November 24, 1910.
- Thence I run
N. 89° 59' W. on a true line bet. secs. I and I2.
Desc. over rolling N. slope.
- 32.00 Clark's Fork River, 2.30 chs. wide,

21.
Resurvey of

Subdivision of Twp 56 N., R. 103 W.

Chains.

course N., asc.

39.99 Set an iron post, 3 ft. long, 1 in. in dia., 26 ins. in the ground for $\frac{1}{4}$ Sec Cor, marked on brass cap $\frac{1}{4}$ S 1 on N. half and S 12 on S. half, and raise a mound of stone, 2 ft. base, $1\frac{1}{2}$ ft. high, N. of Cor Pits impracticable.

40.15 Road ^{bears} N. and S.

70.40 Road ^{bears} NE. and SW.

79.98 The Cor. of secs. 1, 2, 11, and 12. Land, rolling.

Soil, boulders, 3rd and 4th rate. Vegetation, sagebrush and grass.

N. 0° 01' W. bet. secs. 1 and 2. Asc. over rolling land.

40.00 Set an iron post, 3 ft. long, 1 in. in dia., 26 ins. in the ground for $\frac{1}{4}$ Sec Cor, marked on brass cap $\frac{1}{4}$ S 2 on W. half and S 1 on E. half, and raise a mound of stone, 2 ft. base, $1\frac{1}{2}$ ft. high, W. of Cor Pits impracticable.

49.50 Road ^{bears} NW. and SE.

91.63 Intersect Fourteenth Standard Parallel North at a point from which the

See Page 192

624

22.
Re-survey of

Subdivision of Twp 56 N., R. 103 W.

Chains.

stan. Cor. of secs. 31 and 32, Twp 57
N., R. 102 W., bears N. $89^{\circ} 36'$ E.
2.33 chs. dist.

Set an iron post, 3 ft. long, 2 ins.
in dia., 24 ins. in the ground for
closing Cor. of secs. 1 and 2, marked
on brass cap

T 57 N R 102 W in N.

S 31 CC in NW.

S 32 in NE.

S 1 in SE.

S 2 in SW quadrant and

T 56 N in S., and raise a mound
of stone, 2 ft. base, $1\frac{1}{2}$ ft. high,
S. of Cor. Pits impracticable.

Land, rolling.

Soil, boulders, 4th rate.

Vegetation, sagebrush and grass.

June 7, 1911.

June 8: At 6^h.00^m. a.m. l.m.t. I set off
 $44^{\circ} 47'$ N. on the lat. arc; $22^{\circ} 49'$
N. on the decl. arc; and determine
with the solar a true meridian at
the Cor. of secs. 2, 3, 34, and 35,
which I set November 1, 1910.

Thence I run

23.
Recovery of

Subdivision of Twp 56 N., R. 103 W.

Chains.

N. $0^{\circ} 02'$ W. bet. secs. 34 and 35.Across TR 58 on ~~30~~ line.

Desc. on bottom land.

6.00 Paint Creek, 20 lks. wide, course NW

6.20 Road ^{bears} E. and W.6.53 Intersect line 5-6 TR 39 at a point
from which Cor. No. ~~1/38~~ bears N. $89^{\circ} 55'$
E. **9.83** chs. dist.*Thence across TR 39*7.80 Paint Creek, 20 lks. wide, course E.,
asc. on hilly land.~~Thence across TR 39 on 30~~ line.

12.50 Desc. on bench, N. slope.

20.85 Ditch, 5 lks. wide, course N. 30° E.26.70 Intersect line 5-6 TR 40 at a point
from which Cor. No. 6 bears N. 89°
55' E. **9.82** chs. dist.Thence across TR 40 on ~~30~~ line.40.00 Set an iron post, 3 ft. long, 1 in.
dia., 26 ins. in the ground for $\frac{1}{4}$
Sec Cor., marked on brass cap $\frac{1}{4}$ S 34
on W. half and S 35 on E. half, and
raise a mound of stone, 2 ft. base,
1 $\frac{1}{2}$ ft. high, W. of Cor. Pits impracti-
cable.H. A. Luce's ranch house bears approxi-
mately S. 63° E. 20.00 chs. dist.0.20 Road ^{bears} NE and SW.

Chains.

- 41.50 Fence ^{bears} S. 60° E. and N. 60° W.
- 41.70 Road ^{bears} S. 60° E. and N. 60° W.
- 43.65 Fence ^{bears} N. 30° E. and S. 30° W.
- 43.80 Road ^{bears} N. 30° E. and S. 30° W.
- 46.88 Intersect line 5-6 TR 6I at a point
from which Cor No. 6 bears N. 89°
55' E. 9.80 chs. dist.
Thence across TR 6I
- 47.00 Ditch, 3 lks. wide, course N. 30° E.
- 47.15 Fence ^{bears} E. and W.
- 50.50 Road ^{bears} NE and SW.
- 73.00 Road ^{bears} N. 15° W. and S. 15° E.
- 80.00 Set an iron post, 3 ft. long, 2 ins.
in dia., 24 ins. in the ground for
cor of secs. 26, 27, 34, and 35,
marked on brass cap
T 56 N S 27 in NW
R 103 W S 26 in NE
S 35 in SE and
S 34 in SW quadrant, and raise a
mound of stone, 2 ft. base, 1½ ft.
high, W. of Cor.
- Land, rolling ^{75.30} ~~85.30~~ chs., hilly 4.70
chs.
- Soil, rocky, 3rd rate.
- Vegetation, sagebrush and grass.
- From this Cor E. Manning's ranch house

^{25.}
Reaurney &

627

Subdivision of Twp 56 N., R. 103 W.

Chains.

bears S. $58\frac{1}{2}^{\circ}$ W., approximately 17.00
chs. dist.

The school house bears N. $2\frac{1}{2}^{\circ}$ W. 10.00
chs. dist.

S. $89^{\circ} 59'$ E. on a random line bet.
secs. 26 and 35.

40.00 Set temp. $\frac{1}{4}$ Sec Cor.

79.98 Intersect N. and S. line 2 lks. N. of
cor of secs. 25, 26, 35, and 36.

Thence I run

N. $89^{\circ} 58'$ W. on a true line bet. secs.
26 and 35.

Across TR 38

Asc. on hilly E. slope.

21.00 Ditch, 5 lks. wide, course N.

22.50 Desc.

25.00 Fence ^{bears} 13. 60° W. and N. 60° E.

31.00 Paint Creek, 12 lks. wide, course N.
 30° E., asc. on rolling land.

57.25 Enter cultivated land ^{bearing} N. 20° E. and
S. 20° W.

39.99 Set an iron post, 3 ft. long, 1 in. in
dia., 26 ins. in the ground for $\frac{1}{4}$
Sec Cor., marked on brass cap $\frac{1}{4}$ S 26
on N. half and S 35 on S. half, and
raise a mound of stone, 2 ft. base,

Chains.

$1\frac{1}{2}$ ft. high, N. of Cor. Pits impracticable.

42.50 Enter alfalfa ^{bearing} N. 30° E. and S. 30° W.

46.00 Leave alfalfa ^{bearing} N. 30° E. and S. 30° W.

50.26 Intersect line 5-6 TR 56 at a point
from which Cor. No. $\frac{2}{38}$ bears N. $0^{\circ} 02' W.$
7.30 chs. dist.

See page 203 Thence ~~across TR 56 on Ditch line.~~
Desc.

53.30 Fence ^{bears} S. 30° W. and N. 30° E.

53.38 Road ^{bears} S. 30° W. and N. 30° E.

55.75 Ditch, course N. 30° E.

See page 195 70.26 Intersect line 6-I TR 6I at a point
from which Cor. No. $\frac{4}{56}$ bears S. $0^{\circ} 03'$
E. 12.94 chs. dist.

Thence across TR 6I on Ditch line.

79.98 The Cor. of secs. 26, 27, 34, and 35.
Land, hilly 31.00 chs, rolling 48.98
chs.

Soil, rocky, 2nd and 3rd rate.

Vegetation, sagebrush, alfalfa and
grass.

N. $0^{\circ} 02'$ W. bet. secs. 26 and 27.

Across TR 6I on Ditch line.

Desc. on rolling land.

1.90 Ditch, 4 lks. wide; course N. 10° E.,

Chains.

- asc. E. slope.
- 2.20 Ditch, 6 lks. wide, course N. 20° E.
- 23.00 Desc. hilly NW slope.
- 7.45[✓] Intersect line I-2-TR-61 at a point
 from which Cor. No. I bears N. 89° 54'
 E. 9.69 chs. dist.
 Thence across TR 62 on ~~the~~ line.
- 34.30 Fence ^{bears} NE and SW.
- 34.65 Ditch, 4 lks. wide, course NW. leave
 hilly land and enter cultivated land.
- 40.00 Set an iron post, 3 ft. long, 1 in. in
 dia., 26 ins. in the ground for $\frac{1}{4}$
 Sec Cor, marked on brass cap $\frac{1}{4}$ S 27
 on W. half and S 26 on E. half, and
 raise a mound of stone, 2 ft. base,
 1 $\frac{1}{2}$ ft. high, W. of Cor Pits impracti-
 cable.
- 2.95 Fence ^{bears} SW and NE, leave cultivated land.
- 7.64 Intersect line 5-6 TR 59 at a point
 from which Cor. No. 6 bears N. 89° 53'
 E. 9.67 chs. dist.
 Thence across TR 59 on ~~the~~ line.
- 3.50 Fence ^{bears} E. and W.
- 9.00 Fence ^{bears} N. 20° E. and S. 20° W.
- 7.65 Ditch, 4 lks. wide, course N. 30° E.
- 4.20 Ditch, 4 lks. wide, course west.
- 4.20 Fence ^{bears} E. and W., enter alfalfa.

See page 193

TRANSCRIBED COPY OF ORIGINAL ²⁷ FIELD NOTES

629

Subdivision of Twp 56 N., R. 103 W.

Chains.

asc. E. slope.

2.20 Ditch, 6 lks. wide, course N. 20° E.

23.00 Desc. hilly NW slope

27.45 ^{supers} Intersect line 1-2 TR 61 at a point
from which cor. No. 1 bears N. 89° 54'
E. 9.69 chs. dist.

Thence across TR 62

34.30 Fence ^{bears} NE and SW

34.65 Ditch, 4 lks. wide, course NW. leave
hilly land and enter cultivated land.

40.00 Set an iron post, 3 ft. long, 1 in. in
dia., 26 ins. in the ground for $\frac{1}{4}$
Sec Cor, marked on brass cap $\frac{1}{4}$ S 27
on W. half and S 26 on E. half, and
raise a mound of stone, 2 ft. base,
1 $\frac{1}{2}$ ft. high, W. of cor. Pits impracti-
cable.

42.95 Fence ^{bears} SW and NE, leave cultivated land.

47.64 Intersect line 5-6 TR 59 at a point
from which cor. No. 6 bears N. 89° 53'
E. 9.67 chs. dist.

Thence across TR 59

48.50 Fence ^{bears} E. and W.

50.00 Fence ^{bears} N. 20° E. and S. 20° W.

57.65 Ditch, 4 lks. wide, course N. 30° E.

64.20 Ditch, 4 lks. wide, course west.

67.20 Fence ^{bears} E. and W., enter alfalfa.

Subdivision of Twp 56 N., R. 103 W.

Chains.

- 78.60 Ditch, course N. 60° E., leave alfalfa.
- 80.00 Set an iron post, 3 ft. long, 2 ins. in dia., 24 ins. in the ground for cor of secs. 22, 23, 26, and 27, marked on brass cap
 T 56 N S 22 in NW
 R 103 W S 23 in NE
 S 26 in SE and
 S 27 in SW quadrant, and raise a mound of stone, 2 ft. base, 1½ ft. high, W. of cor. Pits impracticable.
- Land, rolling 68.35 chs., hilly 11.65 chs.
- Soil, loam and rocky, 2nd and 3rd rate.
- Vegetation, sagebrush, alfalfa, and grass.
-
- S. 89° 58' E. on a random line bet. secs. 23 and 26.
- 40.00 Set temp. ¼ Sec Cor
- 80.02 Intersect N. and S. line at cor of secs. 23, 24, 25, and 26.
- Thence I run
 N. 89° 58' W. on a true line bet. secs. 23 and 26.
- See page 200*
~~Across TR 70 on~~
- Asc. on rolling N. slope.
- 1.50 Road ^{bears} NE and SW

**TRANSCRIBED COPY OF
630 ORIGINAL FIELD NOTES**

Subdivision of Twp 56 N., R. 103 W.

chains.	
78.60	Ditch, course N. 60° E., leave alfalfa.
80.00	Set an iron post, 3 ft. long, 2 ins. in dia., 24 ins. in the ground for cor. of secs. 22, 23, 26, and 27, marked on brass cap T 56 N S 22 in NW R 103 W S 23 in NE S 26 in SE and S 27 in SW quadrant, and raise a mound of stone, 2 ft. base, 1½ ft. high, W. of cor. Pits impracticable.
	Land, rolling 68.35 chs., hilly 11.65 chs.
	Soil, loam and rocky, 2nd and 3rd rate. Vegetation, sagebrush, alfalfa, and grass.
	S. 89° 58' E. on a random line bet. secs. 23 and 26.
40.00	Set temp. ¼ Sec Cor.
80.02	Intersect N. and S. line at cor. of secs. 23, 24, 25, and 26. Thence I run N. 89° 58' W. on a true line bet. secs. 23 and 26.
	Across TR 70 on rolling N. slope. Asc. on rolling N. slope. Road NE and SW

29.
Reurrey B

Subdivision of Twp 56 N., R. 103 W.

Chains.

- See page 199*
10.18 ~~Intersect line 4-I TR 49 at a point
from which Cor. No. 1 bears North
8.36 chs. dist.
Thence across TR 49~~
- 33.00 Ditch, 5 lks. wide, course N.
- 38.00 Road ^{bears} N. and S.
- 40.01 Set an iron post, 3 ft. long, 1 in.
in dia., 26 ins. in the ground for
 $\frac{1}{4}$ Sec Cor., marked on brass cap $\frac{1}{4}$ S 23
on N. half and S 26 on S. half, and
raise a mound of stone, 2 ft. base,
1 $\frac{1}{2}$ ft. high, N. of Cor. Pits impracti-
cable.
- See page 198*
50.34 Intersect line 8-I TR 59 at a point
from which Cor. No. 1 bears N. 0° 02'
W. 8.14 chs. dist.
Thence across TR 59 on ~~land~~ line.
- 7.20 Desc. on hilly W. slope.
- 2.85 Fence ^{bears} N. and S., leave hilly land,
enter alfalfa.
- 5.00 Ditch, 4 lks. wide, course NE, leave
alfalfa, asc.
- 10.02 The Cor. of secs. 22, 23, 26, and 27.
Land, rolling 64.37 chs., hilly 15.65
chs.
Soil, loam, and rocky, 2nd and 3rd rate.
Vegetation, sagebrush, alfalfa and grass

TRANSCRIBED COPY OF
ORIGINAL FIELD NOTES 631

Subdivision of Twp 56 N., R. 103 W.

Chains

See page 199
~~10.18 Intersect line 4 I TR 49 at a point
from which Cor. No. 1 bears North
8.36 chs. dist.~~

~~Thence across TR 49~~

33.00 Ditch, 5 lks. wide, course N.

38.00 Road, ^{bears} N. and S.

40.01 Set an iron post, 3 ft. long, 1 in.
in dia., 26 ins. in the ground for
 $\frac{1}{4}$ Sec Cor., marked on brass cap $\frac{1}{4}$ S 23
on N. half and S 26 on S. half, and
raise a mound of stone, 2 ft. base,
 $1\frac{1}{2}$ ft. high, N. of Cor. Pits impracti-
cable.

See page 198
50.34 Intersect line 8-I TR 59 at a point
from which Cor. No. 1 bears N. $0^{\circ} 02'$
W. 8.14 chs. dist.

Thence across TR 59

57.20 Desc. on hilly W. slope.

62.85 Fence, ^{bears} N. and S., leave hilly land,
enter alfalfa.

75.00 Ditch, 4 lks. wide, course NE, leave
alfalfa, asc.

80.02 The Cor. of secs. 22, 23, 26, and 27.
Land, rolling 64.37 chs., hilly 15.65
chs.

Soil, loam, and rocky, 2nd and 3rd rate.
Vegetation, sagebrush, alfalfa and grass.

632

30.

Resurvey of

Subdivision of Twp 56 N., R. 103 W.

Chains.

	N. $0^{\circ} 02'$ W. bet. secs. 22 and 23. Across TR 59 on line .
	Asc. over rolling land.
.26'	Road ^{bears} S. 70° W. and N. 60° E.
2.00	Desc.
8.06	Intersect line 3-4 TR 60 at a point from which Cor No. 3 bears S. 89° $52'$ W. 10.45 chs. dist.
	Thence across TR 60 on line .
9.50	Fence ^{bears} E. and W.
10.45	Ditch, 4 lks. wide, course W., enter cultivated land.
16.70	Ditch, 4 lks. wide, course E., leave cultivated land.
21.05	Ditch, 4 lks. wide, course W., enter cultivated land.
38.20	Fence ^{bears} N. 70° E. and S. 70° W.
38.65	Ditch, 4 lks. wide, course N. 70° E., leave cultivated land.
40.00	Set an iron post, 3 ft. long, 1 in. in dia., 26 ins. in the ground for $\frac{1}{4}$ Sec Cor., marked on brass cap $\frac{1}{4}$ S 22 on W. half and S 23 on E. half, and raise a mound of stone, 2 ft. base, $1\frac{1}{2}$ ft. high, W. of Cor. Pits imprac- ticable.
	J. C. Brown's ranch house bears S. 35°

31.
Reurvey of

Subdivision of Twp 56 N., R. 103 W.

Chains

- E. approximately 30.00 chs. dist.
- 48.49 Intersect line 5-6 TR 51 at a point from which Cor. No. 5 bears S. 89° 51' W. 10.53 chs. dist.
Thence across TR 51 on glass line.
- 68.71 Intersect line 3-4 TR 51 at a point from which Cor. No. 4 bears S. 89° 51' W. 10.57 chs. dist.
Set an iron post, 3 ft. long, 1 in. in dia., 26 ins. in the ground for closing Cor. of fract. secs. 22 and 23, marked on brass cap
T 56 N S 22 in NW
R 103 W S 23 in NE quadrant and
CC TR 51 in S. half.
Thence bet. secs. 22 and 23.
- 74.40 Clark's Fork River 2.50 chs. wide, course East, asc.
- 80.00 Set an iron post, 3 ft. long, 2 ins. in dia., 24 ins. in the ground for Cor. of secs. 14, 15, 22, and 23, marked on brass cap
T 56 N S 15 in NW
R 103 S I4 in NE
S 23 in SE and
S 22 in SW quadrant, and raise a mound of stone, 2 ft. base, 1½ ft.

See page 213

Chains.

high, W. of Cor Pits impracticable.
 Land, rolling.
 Soil, loam and rocky, 2nd and 3rd rate.
 Vegetation, sagebrush and grass.
 June 8: At this cor I set off $22^{\circ} 48\frac{1}{2}'$
 N. on the decl. arc; and at 11^h 59^m.
 a.m.l.m.t. observe the sun on the
 meridian, the resulting lat. is 44°
 $49'$ N. or within 30" of the proper
 lat.

S. $89^{\circ} 58'$ E. on a random line bet.
 secs. 14 and 23.

40.00 Set temp. $\frac{1}{4}$ Sec Cor

80.06 Intersect N. and S. line 7 lks. S. of
 Cor of secs. 13, 14, 23, and 24.

Thence I run

S. $89^{\circ} 59'$ W. on a true line bet. secs
 14 and 23.

Desc. over hilly land.

10.20 Intersect line 10-1 TR 51 at a point
 from which Cor No. 1 bears North
 9.32 chs. dist.

Set an iron post, 3 ft. long, 1 in.
 in dia., 26 ins. in the ground for
 closing Cor of fract. secs. 14 and
 23, marked on brass cap

See page 218

Subdivision of Twp 56 N., R. 103 W.

Chains.

T 56 N TR 51 CC in W. half
R 103 W S 14 in NE and
S 23 in SE quadrant.

Thence across TR 51 on

- | | |
|-------|---|
| II.30 | Road ^{bears} N. 30° E. and S. 30° W. |
| 12.00 | Fence ^{bears} N. 30° E. and S. 30° W. |
| 12.60 | Ditch, 4 lks. wide, course N. 30° E.,
enter alfalfa and rolling land. |
| 40.03 | Set an iron post, 3 ft. long, 1 in.
in dia., 26 ins. in the ground for
$\frac{1}{4}$ Sec Cor, marked on brass cap $\frac{1}{4}$ S 14
on N. half and S 23 on S. half, and
raise a mound of stone, 2 ft. base,
1 $\frac{1}{2}$ ft. high, N. of Cor Pits imprac-
ticable. |
| 41.50 | Ditch, 4 lks. wide, course N., leave
alfalfa and asc. on hilly land. |
| 47.75 | Desc. W. slope. |
| 50.43 | Intersect line 2-3 TR 51 at a point
from which Cor No. 2 bears N. 0°
02' W. 9.01 chs. dist.
Set an iron post, 3 ft. long, 1 in.
in dia., 26 ins. in the ground for
closing cor of fract. secs. 14 and
23, marked on brass cap
T 56 N S 14 in NW
S 23 in SW quadrant and |

See page 213

636

Resurvey of ^{34.}

Subdivision of Twp 56 N., R. 103 W.

Chains.

- R 103 W TR 51 CC in E. half.
Thence bet. secs. 14 and 23.
- 50.43 Fence ^{bears} N. 30° W. and S. 30° E.
- 66.00 Clark's Fork River 2.50 chs. wide,
course N. 30° E., asc.
- 80.06 The cor. of secs. 14, 15, 22, and 23.
Land, hilly 51.16 chs., rolling, 28.90
chs.
Soil, loam and rocky, 2nd ^{and} 3rd rate.
Vegetation, sagebrush, alfalfa, and
grass.
-
- N. 0° 02' W. bet. secs. 14 and 15.
Asc. over rolling land.
- 40.00 Set an iron post, 3 ft. long, 1 in.
in dia., 26 ins. in the ground for
 $\frac{1}{4}$ Sec cor., marked on brass cap $\frac{1}{4}$ S 15
on W. half and S 14 on E. half, and
raise a mound of stone, 2 ft. base,
1 $\frac{1}{2}$ ft. high, W. of cor. Pits impracti-
cable.
- 51.90 Road, ^{bears} N. 80° W. and S. 80° E., asc. on
hilly S. slope.
- 80.00 Set an iron post, 3 ft. long, 2 ins.
in dia., 24 ins. in the ground for
cor. of secs. 10, 11, 14, and 15,
marked on brass cap

35.
Recovery of

637

Subdivision of Twp 56 N., R. 103 W.

chains.

T 56 N S 10 in NW

R 103 W S II in NE

S 14 in SE and

S 15 in SW quadrant, and raise a mound of stone, 2 ft. base, $1\frac{1}{2}$ ft. high, W. of Cor. Pits impracticable.

Land, rolling 51.90 chs., hilly 28.10 chs.

Soil, rocky, 2nd and 3rd rate.

Vegetation, sagebrush and grass.

N. $89^{\circ} 59'$ E. on a random line bet. secs. II and I4.

40.00 Set temp. $\frac{1}{4}$ Sec Cor.

79.98 Intersect N. and S. line 7 lks. N. of Cor. of secs. II, I2, I3, and I4.

Thence I run

N. $89^{\circ} 58'$ W. on a true line bet. secs. II and I4.

Across TR 55 on ~~TR 55~~ line

Asc. on hilly land.

10.21 Intersect line 6-I TR 54 at a point from which ~~true point for~~ Cor. No. 6 bears South 9.96 chs. dist.

Thence across TR 54 on ~~TR 54~~ line

20.23 Road ^{bears} NE and S. 60° W.

39.99 Set an iron post, 3 ft. long, 1 in. in

Chains.

dia., 26 ins. in the ground for $\frac{1}{4}$
 Sec Cor, marked on brass cap $\frac{1}{4}$ S II
 on N. half and S I4 on S. half, and
 raise a mound of stone, 2 ft. base,
 $1\frac{1}{2}$ ft. high, N. of cor. Pits impracti-
 cable.

A coal slope running NW 2.00 chs. bears
 N. 56° W., approximately 20.00 chs.
 dist.

50.44 Intersect line 4-5 TR 54 at a point
 from which Cor No. 4 bears N. $0^{\circ} 02'$
 W. 9.90 chs. dist.

See page 213

Set an iron post, 3 ft. long, 1 in.
 in dia., 26 ins. in the ground for
 closing cor of fracl. secs. II and
 I4, marked on brass cap

T 56 N S II in NW

S I4 in SW quadrant and

R 103 W TR 54 CO in E. half.

Thence bet. secs. II and I4.

79.98 The Cor of secs. 10, II, I4, and I5.
 Land, hilly.

Soil, rocky, 3rd and 4th rate.

Vegetation, sagebrush and grass.

N. $0^{\circ} 02'$ W. bet. secs. 10 and II.

Asc. on hilly S. slope.

Subdivision of Twp 56 N., R. 103 W.

ains.

- 40.00 Set an iron post, 3 ft. long, 1 in. in dia., 26 ins. in the ground for $\frac{1}{2}$ Sec Cor, marked on brass cap $\frac{1}{2}$ S 10 on W. half and S II on E. half, and raise a mound of stone, 2 ft. base, $1\frac{1}{2}$ ft. high, W. of Cor Pits impracticable.
- 43.00 Ridge, ^{bears} N. 60° W. and E., desc. N. slope.
- 64.00 Gully, course NE asc.
- 80.00 Set an iron post, 3ft. long, 2 ins. in dia., 24 ins. in the ground for Cor of secs. 2, 3, 10, and II, marked on brass cap
 T 56 N S 3 in NW
 R 103 W S 2 in NE
 S II in SE and
 S 10 in SW quadrant, and raise a mound of stone, 2 ft. base, $1\frac{1}{2}$ ft. high, W. of Cor Pits impracticable.
- Land, hilly.
 Soil, rocky, 3rd and 4th rate.
 Vegetation, sagebrush and grass.
 Formation, conglomerate, shale, sandstone and boulders.
-
- S. 89° 58' E. on a random line bet. secs. 2 and II.

640

Resurvey of ³⁸

Subdivision of Twp 56 N., R. 103 W.

Chains.

- 40.00 Set temp. $\frac{1}{4}$ Sec Cor.
- 79.96 Intersect N. and S. line, 2 lks. S. of
Cor. of secs. I, 2, II, and I2.
Thence I run
N. $89^{\circ} 59'$ W. on a true line bet. secs.
2 and II.
Desc. over rolling land.
- 35.20 Road ^{bears} NW and SE.
- 39.98 Set an iron post, 3 ft. long, 1 in.
in dia., 26 ins. in the ground for
 $\frac{1}{4}$ Sec Cor., marked on brass cap $\frac{1}{4}$ S 2
on N. half and S II on S. half, and
raise a mound of stone, 2 ft. base,
 $1\frac{1}{2}$ ft. high, N. of Cor. Pits impracti-
cable.
- 44.15 Lake Creek, 5 lks. wide, course S. 60°
E., asc.
- 52.50 Ditch, 5 lks. wide, course SE, enter
broken land.
- 79.96 The Cor. of secs. 2, 3, IO, and II.
Land, rolling 52.50 chs., broken
27.46 chs.
Soil, rocky, 3rd and 4th rate.
Vegetation, sagebrush and grass.
-
- N. $0^{\circ} 02'$ W. bet. secs. 2 and 3.
Asc. on rolling land, E. slope.

Chains.

Chains.	Desc.
15.00	Desc.
40.00	Set an iron post, 3 ft. long 1 in. in dia., 26 ins. in the ground for $\frac{1}{4}$ Sec Cor., marked on brass cap $\frac{1}{4}$ S 3 on W. half and S 2 on E. half, and raise a mound of stone, 2 ft. base, $1\frac{1}{2}$ ft. high, W. of Cor. Pits impracticable.
54.25	Ditch, 5 lks. wide, course S. 30° E.
59.60	Enter lake extending NW 10.00 chs. and SE 2.00 chs.
71.00	Leave lake ^{bear 119} NW and SE, asc.
91.14	Intersect Fourteenth Standard Parallel North at a point from which the stan. Cor. of Twp 57 N., Rgs. 102 and 103 W. bears N. $89^{\circ} 36'$ E. 1.47 chs. dist. Set an iron post, 3 ft. long, 2 ins. in dia., 24 ins. in the ground for closing Cor. of secs. 2 and 3, marked on brass cap T 57 N in N R 103 W S 36 CC in NW R 102 W S 31 in NE S 2 in SE S 3 in SW quadrant and T 56 N in S., and raise a mound of stone, 2 ft. base, $1\frac{1}{2}$ ft. high

Subdivision of Twp 56 N., R. 103 W.

Chains.

S. of Cor Pits impracticable.
 Land, rolling.
 Soil, rocky, 2nd, 3rd, and 4th rate.
 Vegetation, sagebrush and grass.

June 8, 1911.

June 9: At 6^h00^ma.m. I set off
 44° 47' N. on the lat. arc; 22°
 55' N. on the decl. arc; and deter-
 mine a true meridian at the Cor. of
 secs. 3, 4, 33, and 34, ^{on S. body of the Tr.} which I set
 November 1, 1910.

Thence I run

N. 0° 02' W. bet. secs. 33 and 34.

Asc. on hilly land.

8.00 Road ^{bears} S. 60° W. and N. 60° E., desc.20.65 High Water level Hogan Reservoir N.
 30½° W. and S. 52° E., area 45 acres

Set an iron post, 3 ft. long, 1 in.
 in dia., 26 ins. in the ground for
 meander Cor. of fracl. secs. 33 and
 34, marked on brass cap

T 56 N R 103 W in N. half

S 34 in SE and

M C S 33 in SW quadrant.

35.20 High Water level Hogan Reservoir S.
 56° E. and N. 73° W., asc.

See page 214

Subdivision of Twp 56 N., R. 103 W.

Chains.

See page 214
Set an iron post, 3 ft. long, 1 in.
in dia., 26 ins. in the ground for
meander cor of fracl. secs. 33 and 34,
marked on brass cap

S 33 in NW

S 34 M C in NE quadrant and

T 56 N R 103 W in S. half.

40.00 Set an iron post, 3 ft. long, 1 in.
in dia., 26 ins. in the ground for
 $\frac{1}{4}$ Sec Cor., marked on brass cap $\frac{1}{4}$ S 33
on W. half and S 34 on E. half, and
raise a mound of stone, 2 ft. base,
 $1\frac{1}{2}$ ft. high, W. of Cor. Pits impracti-
cable.

46.77 Intersect line 5-6 TR 63 at a point
from which Cor No. 5 bears S. 89°
53' W. 10.25 chs. dist.

See page 214
Set an iron post, 3 ft. long, 1 in.
in dia., 26 ins. in the ground for
closing cor of fracl. secs. 33 and
34, marked on brass cap
T 56 N R 103 W TR 63 CC in N. half
S 34 in SE and
S 33 in SW quadrant.

Thence across TR 63

Desc.

60.00

66.92

Intersect line 3-4 TR 73 at a point

644

Resurvey of ^{42.}

Subdivision of Twp 56 N., R. 103 W.

Chains.

from which Cor. No. 4 bears N. 89°
51' E. 9.64 chs. dist.

Thence across TR 73

69.50

Road ^{bears} S. 60° W. and N. 60° E.

80.00

Set an iron post, 3 ft. long, 2 ins.
in dia., 24 ins. in the ground for
Cor. of secs. 27, 28, 33, and 34,
marked on brass cap

T 56 N S 28 in NW

R 103 W S 27 in NE

S 34 in SE and

S 33 in SW quadrant, and raise a

mound of stone, 2 ft. base, 1½ ft.

high, W. of Cor. Pits impracticable.

Land, hilly.

Soil, loam and rocky, 2nd and 3rd rate.

Vegetation, sagebrush and grass.

S. 89° 59' E. on a random line bet.
secs. 27 and 34.

40.00

Set temp. ¼ Sec Cor.

79.98

Intersect N. and S. line at the Cor. of
secs. 26, 27, 34, and 35.

Thence I run

N. 89° 59' W. on a true line bet. secs.
27 and 34.

Across TR 61 on

Resurvey of ^{43.}

Subdivision of Twp 56 N., R. 103 W.

chains.

Asc. on rolling land.

1.00 Ditch, 5 lks. wide, course N: 15° E.

4.82 Road ^{bears} N. 30° E. and S. 30° W.10.29 *See page 194* Intersect line 4-5 TR 62 at a point
from which Cor. No. 4 bears S. 0°
05' E. 12.96 chs. dist.

15.50 Ditch, 4 lks. wide, course NW.

17.00 Desc.

18.20 Ditch, course S. 60° W.

30.31 Intersect line 7-1 TR 63 at a point
from which Cor. No. 1 bears N. 0° 06'
W. 7.23 chs. dist.Thence across TR 63 on ~~rolling land~~.32-37 Road and ditch ^{bearing} N. 60° E. and S. 60° W.,
asc.39.99 Set an iron post, 3 ft. long, 1 in. in
dia., 26 ins. in the ground for $\frac{1}{4}$
Sec Cor., marked on brass cap $\frac{1}{4}$ S 27
on N. half and S 34 on S. half, and
raise a mound of stone, 2 ft. base,
1 $\frac{1}{2}$ ft. high, N. of Cor. Pits impracti-
cable.50.36 *See page 206* Intersect line 6-7 TR 64 at a point
from which Cor. No. 7 bears N. 0° 03'
W. 7.21 chs. dist.~~Thence across TR 64~~

62.63 Ditch, 4 lks. wide, course N. 10° W.

chains.

70.38 Intersect line 4-I TR 73 at a point
from which Cor. No. 1 bears N. $0^{\circ} 10'$
W. 7.14 chs. dist.

Thence across TR 73 on rolling land.

71.43 Road, ^{bears} N. 30° E. and S. 60° W.

79.98 The cor. of secs. 27, 28, 33, and 34.
Land, rolling.

Soil, rocky, 2nd and 3rd rate.

Vegetation, sagebrush and grass.

N. $0^{\circ} 02'$ W. bet. secs. 27 and 28.

Across TR 73 on rolling land.

Desc. on rolling land.

7.11 Intersect line 3-4 TR 72 at a point
from which Cor. No. 4 bears N. 89°
 $50'$ E. 9.58 chs. dist.

Thence across TR 72 on rolling land.

12.50 Fence, ^{bears} N. 30° E. and S. 30° W.

15.30 Newmeyer Creek, 3 lks. wide, course
N. 30° E.

19.00 Desc.

27.31 Intersect line I-2 TR 72 at a point
from which Cor. No. 1 bears N. 89°
 $49'$ E. 9.54 chs. dist.

Set an iron post, 3 ft. long, 1 in. in
dia., 26 ins. in the ground for
closing Cor. of fract. secs. 27 and

See page 208

See page 215

Subdivision of Twp 56 N., R. 103 W.

Chains

	28, marked on brass cap T 56 N S 28 in NW R 103 W S 27 in NE quadrant and CC TR 72 in S. half. Thence bet. secs. 27 and 28.
40.00	Set an iron post, 3 ft. long, 1 in. in dia., 26 ins. in the ground for $\frac{1}{4}$ Sec Cor, marked on brass cap $\frac{1}{4}$ S 28 on W. half and S 27 on E. half, and raise a mound of stone, 2 ft. base, 1 $\frac{1}{2}$ ft. high, W. of Cor. Pits impracti- cable.
59.50	Draw, course N. 60° E., asc.
80 .00	Set an iron post 3 ft. long, 2 ins. in dia., 24 ins. in the ground for Cor of secs. 21, 22, 27, and 28, marked on brass cap T 56 N S 21 in NW R 103 W S 22 in NE S 27 in SE and S 28 in SW quadrant, and raise a mound of stone, 2 ft. base, 1 $\frac{1}{2}$ ft. high, W. of Cor Pits impracticable. <i>From this Cor A.E. Hogan's ranch house bears S 27° 30' E. 24.00 chs. dist.</i> Land, hilly. Soil, rocky, 3rd rate. Vegetation, sagebrush and grass.

648

Resurvey of ^{46.}

Subdivision of Twp 56 N., R. 103 W.

Chains

S. $89^{\circ} 59'$ E. on a random line bet.
secs. 22 and 27.

40.00 Set temp. $\frac{1}{4}$ Sec Cor.79.96 Intersect N. and S. line at Cor. of
secs. 22, 23, 26, and 27.

Thence I run

N. $89^{\circ} 59'$ W. on a true line bet. secs.
22 and 27.

Across TR 59 on ~~line~~ line.

Desc. on rolling land.

.50 Road ^{bears} S. 60° W. and N. 60° E.18.50 J. E. Brown's ranch house is 2.00 chs.
S. of line.21.00 Fence ^{bears} N. and S.23.20 Fence ^{bears} S. 70° E. and N. 70° W.

24.90 Asc., enter willows NE and SW.

28.45 Fence ^{bears} N. and S.30.48 Intersect line 7-I TR 65 at a point
from which Cor. No. 1 bears N. $0^{\circ} 06'$
W. 8.00 chs. dist.Thence across TR 65 on ~~line~~ line.32.00 Leave willows ^{bearing} NE and SW.39.98 Set an iron post, 3 ft. long, 1 in.
in dia., 26 ins. in the ground for
 $\frac{1}{4}$ Sec Cor., marked on brass cap $\frac{1}{4}$ S 22

Resurvey of

Subdivision of Twp 56 N., R. 103 W.

Mains.

- on N. half and S 27 on S. half; dig pits 18X18X12 ins. E. and W. of post, 3 ft. dist; and raise a mound of earth $3\frac{1}{2}$ ft. base, $1\frac{1}{2}$ ft. high, N. of Cor.
- 40.75 Newmeyer Creek, 3 lks. wide, course NE
- 58.00 Creek, 2 lks. wide, course N. 20° E., asc. on hilly land.
- 58.50 Fence ^{bears} N. 15° E. and S. 15° W.
- 59.00 Road, ^{bears} N. and S.
- 70.59 Intersect line 3-4 TR 65 at a point from which Cor. No. 3 bears N. 0° $10'$ W. 7.36 chs. dist.
- Set an iron post, 3 ft. long, 1 in. in dia., 26 ins. in the ground for closing Cor. of fract. secs. 22 and 27, marked on brass cap
- T 56 N S 22 in NW
- S 27 in SW quadrant and
- R 103 W TR 65 CC in E. half.
- Thence bet. secs. 22 and 27.
- 79.96 The Cor. of secs. 21, 22, 27, and 28. Land, rolling 58.00 chs., hilly 21.96 chs.
- Soil, loam and rocky, 2nd and 3rd rate. Vegetation, sagebrush, willows, and grass.

See page 215

650

Resurvey⁴⁰ of

Subdivision of Twp 56 N., R. 103 W.

Chains.

N. $0^{\circ} 02'$ W. bet. secs. 21 and 22.

Asc. over hilly land.

8.60 Desc. N. slope.

40.00 Set an iron post, 3 ft. long, 1 in. in dia., 26 ins. in the ground for $\frac{1}{4}$ Sec Cor, marked on brass cap $\frac{1}{4}$ S 21 on W. half and S 22 on E. half, and raise a mound of stone, 2 ft. base, $1\frac{1}{2}$ ft. high, W. of Cor Pits impracticable.

Enter rolling land ^{beats} E. and W.60.50 Road, ^{beats} N. 30° W. and S. 30° E.

80.00 Set an iron post, 3 ft. long, 2 ins. in dia., 24 ins. in the ground for Cor of secs. 15, 16, 21, and 22, marked on brass cap

T 56 N S 16 in NW

R 103 W S 15 in NE

S 22 in SE and

S 21 in SW quadrant, and raise a mound of stone, 2 ft. base, $1\frac{1}{2}$ ft. high, W. of Cor Pits impracticable.

Land, hilly 40.00 chs., rolling 40.00 chs.

Soil, rocky, 3rd rate.

Vegetation, sagebrush and grass.

June 9: At this cor I set off $22^{\circ} 54\frac{1}{2}'$

Reaurey J

Subdivision of Twp 56 N., R. 103 W.

ains.

- N. on the decl. arc; and at 11h.59m. a.m.l.m.t. observe the sun on the meridian, the resulting lat. is $44^{\circ} 50'$ N. or within $30''$ of the proper lat.
-
- S. $89^{\circ} 59'$ E. on a random line bet. secs. 15 and 22.
- 40.00 Set temp. $\frac{1}{4}$ Sec Cor.
- 79.90 Intersect N. and S. line at a point 2 lks. N. of Cor of secs. 14, 15, 22, and 23.
- Thence I run
- N. $89^{\circ} 58'$ W. on a true line bet. secs. 15 and 22.
- Asc. over rolling land.
- 39.95 Set an iron post, 3 ft. long, 1 in. in dia., 26 ins. in the ground for $\frac{1}{4}$ Sec Cor, marked on brass cap $\frac{1}{4}$ S 15 on N. half and S 22 on S. half, and raise a mound of stone, 2 ft. base, $1\frac{1}{2}$ ft. high, N. of Cor. Pits impracticable.
- 45.50 Desc.
- 52.40 Clarks Fork River 225 lks. wide, course S. 60° E., asc.
- 79.90 The Cor of secs. 15, 16, 21, and 22.

652

Resurvey of

Subdivision of Twp 56 N., R. 103 W.

Chains.

Land, rolling.
Soil, rocky, 3rd rate.
Vegetation, sagebrush and grass.

N. 0° 02' W. bet. secs. 15 and 16.
Desc. over rolling land.

26.00 Clark's Fork River 2.50 *chs.* wide,
course S. 80° E., asc.

40.00 Set an iron post, 3 ft. long, 1 in.
in dia., 26 ins. in the ground for
 $\frac{1}{4}$ Sec. Cor., marked on brass cap $\frac{1}{4}$ S 16
on W. half and S 15 on E. half, and
raise a mound of stone, 2 ft. base,
1 $\frac{1}{2}$ ft. high, W. of Cor. Pits impracti-
cable.

75.75 Road, ^{barrs} S. 70° E. and N. 70° W.

80.00 Set an iron post, 3 ft. long, 2 ins.
in dia., 24 ins. in the ground for
Cor. of secs. 9, 10, 15, and 16,
marked on brass cap
T 56 N S 9 in NW
R 103 W S 10 in NE
S 15 in SE and
S 16 in SW quadrant, and raise a
mound of stone, 2 ft. base, 1 $\frac{1}{2}$ ft.
high, W. of Cor. Pits impracticable.
Land, rolling.

Subdivision of Twp 56 N., R. 103 W.

Mains.

Soil, ~~pebbly~~^{pebbly} loam and rocky, 2nd and 3rd rate.

Vegetation, sagebrush and grass.

S. 89° 58' E. on a random line bet. secs. 10 and 15.

40.00 Set temp. $\frac{1}{4}$ Sec. Cor.

80.04 Intersect N. and S. line at the Cor. of secs. 10, 11, 14, and 15.

Thence I run

N. 89° 58' W. on a true line bet. secs. 10 and 15.

Asc. on hilly S. slope.

40.02 Set an iron post, 3 ft. long, 1 in. in dia., 26 ins. in the ground for $\frac{1}{4}$ Sec Cor, marked on brass cap $\frac{1}{4}$ S 10 on N. half and S 15 on S. half, and raise a mound of stone, 2 ft. base, $1\frac{1}{2}$ ft. high, N. of Cor. Pits impracticable.

50.00 Desc.

80.04 The Cor. of secs. 9, 10, 15, and 16.

Land, hilly.

Soil, rocky, 3rd rate.

Vegetation, sagebrush, yucca and grass.

N. 0° 02' W. bet. secs. 9 and 10.

Chains.

- Asc. over hilly W. slope.
- 40.00 Set an iron post, 3 ft. long, 1 in. in dia., 26 ins. in the ground for $\frac{1}{4}$ Sec Cor, marked on brass cap $\frac{1}{4}$ S 9 on W. half, and S 10 on E. half, and raise a mound of stone, 2 ft. base, $1\frac{1}{2}$ ft. high, W. of Cor Pits impracticable.
- 66.50 Desc. on N. slope.
- 80.00 Set an iron post, 3 ft. long, 2 ins. in dia., 24 ins. in the ground for Cor of secs. 3, 4, 9, and 10, marked on brass cap
 T 56 N S 4 in NE.
 R 103 W S 3 in NE.
 S 10 in SE and
 S 9 in SW quadrant, and raise a mound of stone, 2 ft. base, $1\frac{1}{2}$ ft. high, W. of Cor Pits impracticable.
 Land, hilly.
 Soil, rocky, 3rd rate.
 Vegetation, sagebrush and grass.
-
- S. $89^{\circ} 58'$ E. on a random line bet. secs. 3 and 10.
- 40.00 Set temp. $\frac{1}{4}$ Sec Cor
- 80.14 Intersect N. and S. line 2 lks. S. of

53
Resurvey of

Subdivision of Twp 56 N., R. 103 W.

ains.

Cor of secs. 2, 3, 10, and 11.

Thence I run

N. 89° 59' W. on a true line bet. secs.
3 and 10.

Asc. on hilly E. slope.

0.07. Set an iron post, 3 ft. long, 1 in. in
dia., 26 ins. in the ground for $\frac{1}{4}$
Sec Cor, marked on brass cap $\frac{1}{4}$ S 3
on N. half and S 10 on S. half, and
raise a mound of stone, 2 ft. base,
1 $\frac{1}{2}$ ft. high, N. of Cor. Pits impracti-
cable.

48.65 Ridge, ^{bears} N. 10° W and SE., desc. on W.
slope.

30.14 The cor of secs. 3, 4, 9, and 10.
Land, hilly.
Soil, rocky, 3rd and 4th rate.
Formation, sandstone, conglomerate,
shale, and boulders.
Vegetation, sagebrush and grass.

N. 0° 02' W. bet. secs. 3 and 4.

Desc. on rolling W. slope.

40.00 Set an iron post, 3 ft. long, 1 in. in
dia., 26 ins. in the ground for $\frac{1}{4}$
Sec Cor, marked on brass cap $\frac{1}{4}$ S 4
on W. half and S 3 on E. half, and

656

Recurvey ^{54.} J.

Subdivision of Twp 56 N., R. 103 W.

Chains

raise a mound of stone, 2 ft. base,
 $1\frac{1}{2}$ ft. high, W. of Cor Pits impracti-
 cable.

86.50 Road ^{bears} S. 60° W. and N. 60° E.

90.47 Intersect Fourteenth Standard Parallel
 North at a point from which the
 stan. cor. of secs. 35 and 36 bears
 N. $89^\circ 29'$ E. .56 chs. dist.

Set an iron post, 3 ft. long, 2 ins.
 in dia., 24 ins. in the ground for
 closing cor. of secs. 3 and 4, marked
 on brass cap

T 57 N R 103 W in N

T 56 N 17 S

S 35 CC in NW.

S 36 in NE

S 3 in SE and

S 4 in SW quadrant, and raise a
 mound of stone, 2 ft. base, $1\frac{1}{2}$ ft.
 high, S. of Cor Pits impracticable.

Land, rolling.

Soil, rocky, 3rd rate.

Vegetation, sagebrush and grass.

June 9, 1911.

June 10: At 6h.00m a.m. l.m.t. I set off
 $44^\circ 47'$ N. on the lat. arc; $22^\circ 59\frac{1}{2}'$
 N. on the decl. arc; and determine

chains.

with the solar a true meridian at the
Cor of secs. 4, 5, 32, and 33, which
I set November 1, 1910.

Thence I run

N. 0° 03' W. bet. secs. 32 and 33.

Desc. on mountainous E. slope.

39.20

Fence ^{bears} E. and W.

40.00

Set an iron post, 3 ft. long, 1 in. in
dia., 26 ins. in the ground for $\frac{1}{4}$
Sec Cor., marked on brass cap $\frac{1}{4}$ S 32
on W. half and S 33 on E. half, and
raise a mound of stone, 2 ft. base,
 $1\frac{1}{2}$ ft. high, W. of Cor. Pits impracti-
cable.

46.61

Intersect line 5-6 TR 69 at a point
from which Cor No. 5 bears S. 89°
55' W. 10.40 chs. dist.

Set an iron post, 3 ft. long, 1 in. in
dia., 26 ins. in the ground for
closing Cor. of fract. secs. 32 and
33, marked on brass cap

T 56 N R103W TR 69 ec in N half
S 33 in SE and
S 32 in SW quadrant

Thence across TR 69

78.00 Road, bears 580°E and 580°W, enter willow undergrowth.

80.00 Set an iron post 3 ft long, 2 ins. in dia, 24 ins. in the
ground for cor of secs 28, 29, 32, and 33 marked
on brass cap

MOU T56N S 29 in NW. Base, 2 ft.
R103W S 28 in NE
high S 33 in SE and ^{is} impracticable.
S 32 in SW quadrant, and raise a mound

See page 215

658

Resurvey of ^{56.}

Subdivision of Twp 56 N., R. 103 W.

Chains.

*of stone 2 ft. base, 1 1/2 ft. high, W of cor.
Pits impracticable.*

Land, mountainous.

Soil, rocky, 3rd and 4th rate.

Formation, sandstone.

Vegetation, sagebrush, grass, and willows

A log cabin bears S. 50° W. 6.00 chs.
dist.

A dugout bears N. 68° W. 5.00 chs. dist.

A log barn bears N. 26 1/2° E. 4.50 chs.
dist.S. 89° 59' E. on a random line bet. secs.
28 and 33.

40.00 Set temp. 1/4 Sec Cor.

80.18 Intersect N. and S. line 16 lks. S. of
Cor of secs. 27, 28, 33, and 34.

Thence I run

S. 89° 54' W. on a true line bet. secs.
28 and 33.

Across TR 73 on 1/2 Sec line.

Asc. on rolling land.

14.50 Desc.

20.50 Fence ^{bears} N. 60° E. and S. 60° W.22.00 Newmeyer Creek, 3 lks. wide, course
N. 60° E., asc. on hilly land.40.09 Set an iron post, 3 ft. long, 1 in.
in dia., 26 ins. in the ground for
1/4 Sec Cor, marked on brass cap 1/4 S 28

Chains.

on N. half and S 33 on S. half, and raise a mound of stone, 2 ft. base, $1\frac{1}{2}$ ft. high, N. of Con Pits impracticable.

50.58 Intersect line 4-1 TR 74 at a point from which Con. No. 1 bears N. $0^{\circ} 15'$ W. 7.05 chs. dist.

Thence across TR 74 on ~~same line~~.

58.70 Road ^{bears} S. 70° W. and NE.

70.28 Fence ^{bears} N. and S., leave hilly land.

70.63 Intersect line 8-1 TR 69 at a point from which Con. No. 1 bears N. $0^{\circ} 15'$ W. 7.02 chs. dist.

Thence across TR 69 on ~~same line~~.

71.88 Fence ^{bears} N. 60° W. and S. 60° E.

79.43 Corral fence ^{bears} N. and S.

79.70 Newmeyer Creek, 2 lks. wide, course S. 60° E.

80.18 The Con. of secs. 28, 29, 32, and 33.

Land, rolling 31.90 chs., hilly 48.28 chs.

Soil, loam and rocky, 2nd and 3rd rate. Vegetation, sagebrush and grass.

N. $0^{\circ} 03'$ W. bet. secs. 28 and 29.

Across TR 69 on ~~same line~~.

Desc. in bottom land, hilly.

660

Resurvey of ⁵⁸

Subdivision of Twp 56 N., R. 103 W.

Chains.

- .10 Newmeyer Creek, 2 lks. wide, course
S. 60° E., asc.
- .25 Corral fence ^{bears} E. and W.
- 1.20 Corral fence ^{bears} E. and W.
- 4.00 Desc. E. slope.
- 6.95 Fence ^{bears} E. and W.
- 7.00 Intersect line 3-4 TR 75 at a point
from which Cor. No. ~~169~~ bears N. 89°
55' E. **2.52** chs. dist.
Thence across TR 75
Fence ^{bears} E. and W.
- 10.20 Fence ^{bears} N. 60° E. and S. 60° W., asc.
S. slope.
- 12.15 Fence ^{bears} NW. and SE.
- 26.50 Desc. N. slope.
- 27.19** Intersect line I-2 TR 75 at a point
from which Cor. No. I bears N. 89°
55' E. 29.45 chs. dist.
Set an iron post, 3 ft. long, 1 in.
in dia., 26 ins. in the ground for
closing Cor. of fract. secs. 28 and
29, marked on brass cap
T 56N S 29 in NW.
R 103 W S 28 in NE quadrant and
CC TR 75 in S. half.
Thence bet. secs. 28 and 29.
- 37.00 Asc. mountainous E. slope.

See page 216

Chains.

40.00	Set an iron post, 3 ft. long, 1 in. in dia., 26 ins. in the ground for $\frac{1}{4}$ Sec Cor., marked on brass cap $\frac{1}{4}$ S 29 on W. half and S 28 on E. half, and raise a mound of stone, 2 ft. base, $1\frac{1}{2}$ ft. high, W. of Cor Pits impracticable.
58.50	Desc.
66.00	Asc.
70.00	Desc.
80.00	Set an iron post, 3 ft. long, 2 ins. in dia., 24 ins. in the ground for Cor. of secs. 20, 21, 28, and 29, marked on brass cap T 56 N S 20 in NW R 103 W S 21 in NE S 28 in SE and S 29 in SW quadrant, and raise a mound of stone, 2 ft. base, $1\frac{1}{2}$ ft. high, W. of Cor Pits impracticable.
	Land, hilly 37.00 chs., mountainous 43.00 chs.
	Soil, rocky, 3rd and 4th rate.
	Formation, red sandstone and limestone.
	Vegetation, sagebrush and grass.
	June 10: At this Cor I set off $22^{\circ} 59'$ N. on the decl. arc; and at 11h.59m. a.m.

662

Resurvey of

Subdivision of Twp 56 N., R. 103 W.

Chains.

1.m.t. observe the sun on the meridian, the resulting lat. is $44^{\circ} 49' N.$ or within 30" of the proper lat.

N. $89^{\circ} 54'$ E. on a random line bet. secs. 21 and 28.

40.00 Set temp. $\frac{1}{4}$ Sec Cor.

80.40 To a point 5 lks. S. of Cor. of secs. 21, 22, 27, and 28.

Thence I run

S. $89^{\circ} 52'$ W. on a true line bet. secs. 21 and 28.

Asc. over rolling E. slope.

40.20 Set an iron post, 3 ft. long, 1 in. in dia., 26 ins. in the ground for $\frac{1}{4}$ Sec Cor., marked on brass cap $\frac{1}{4}$ S 21 on N. half and S 28 on S. half, and raise a mound of stone, 2 ft. base, $1\frac{1}{2}$ ft. high, N. of Cor. Pits impracticable.

53.00 Enter mountainous land ^{bearing} N. and S.

80.40 The Cor. of secs. 20, 21, 28, and 29.

Land, rolling 53.00 chs., mountainous 27.40 chs.

Soil, rocky, 3rd and 4th rate.

Formation, boulders, shale, and sandstone.

Chains.

Vegetation, sagebrush and grass.

N. 0° 03' W. bet. secs. 20 and 21.

Asc. on mountainous E. slope.

28.00 Desc.

31.00 Enter scattering juniper and pinion ^{bearing}
W. and NE.

38.00 Gulch, course E., asc.

40.00 Set an iron post, 3 ft. long, 1 in.
in dia., 26 ins. in the ground for
 $\frac{1}{4}$ Sec Cor., marked on brass cap $\frac{1}{4}$ S 20
on W. half and S 21 on E. half, and
raise a mound of stone, 2 ft. base,
1 $\frac{1}{2}$ ft. high, W. of Cor Pits impracti-
cable.

53.00 Desc.

66.00 Creek, 3 lks. wide, course E., asc.

80.00 Set an iron post, 3 ft. long, 2 ins.
in dia., 24 ins. in the ground for
Cor of secs. 16, 17, 20, and 21,
marked on brass cap

T 56 N S 17 in NW

R 103 W S 16 in NE

S 21 in SE and

S 20 in SW quadrant, and raise a
mound of stone, 2 ft. base, 1 $\frac{1}{2}$ ft.
high, W. of Cor Pits impracticable,

664

Resurvey of ⁶²

Subdivision of Twp 56 N., R. 103 W.

Chains.

from which

A pine, 4 ins. in dia., bears
N. 60° W., 35 lks. dist., marked
T 56 N R 103 W S 17 BT.

A pine, 4 ins. in dia., bears
S. 70° W. 64 lks. dist., marked
T 56 N R 103 W S 20 BT.

No other bearings available.

Land, mountainous.

Soil, rocky, 3rd and 4th rate.

Vegetation, sagebrush and grass.

Formation, limestone, sandstone, and shale.

Scattering pinion timber and juniper
49.00 chs.

June 10, 1911.

June 12: At 7h.00ma.m.l.m.t. I set off
44° 49½' N. on the lat. arc; 23°
08' N. on the decl. arc; and deter-
mine a true meridian at the cor. of
secs. 16, 17, 20, and 21.

Thence I run.

N. 89° 52' E. on a random line bet.
secs. 16 and 21.

40.00 Set temp. $\frac{1}{4}$ Sec Cor

80.26 Intersect N. and S. line 7 lks. S. of

Chains.

- Cor of secs. 15, 16, 21, and 22.
 Thence I run
 S. 89° 49' W. on a true line bet. secs.
 16 and 21.
 Asc. on rolling N. slope.
bearing
 Road N. 30° W. and S. 30° E.
 11.26 Enter hilly land NW and SE.
 20.20
 40.13 Set an iron post, 3 ft. long, 1 in. in
 dia., 26 ins. in the ground for $\frac{1}{4}$
 Sec Cor, marked on brass cap $\frac{1}{4}$ S 16 ~~on~~
 on N. half and S 21 on S. half, and
 raise a mound of stone, 2 ft. base,
 1 $\frac{1}{2}$ ft. high, N. of Cor Pits impracti-
 cable.
 47.76 Desc.
 49.56 Creek, 3 lks. wide, course N. 40° E.
 asc. on mountainous land.
 80.26 The Cor of secs. 16, 17, 20, and 21.
 Land, rolling 20.20 chs., hilly 29.36
 chs., mountainous 30.70 chs.
 Soil, pebbly loam and rocky, 2nd, 3rd,
 and 4th rate.
 Formation, wash and sandstone.
 Vegetation, sagebrush and grass.
 N. 0° 03' W. bet. secs. 16 and 17
 Asc. on mountainous E. slope in scat-

Chains.

tering small pine, pinion, and juniper.

8.45 ✓ Intersect line 3-4 TR 77 at a point from which Cor No. 4 bears East 28.79 chs. dist.

See page 216

Set an iron post, 3 ft. long, 1 in. in dia., 26 ins. in the ground for closing Cor of fracl. secs. 16 and 17, marked on brass cap

T 56 N R 103 W TR 77 CC in N. half S 16 in SE and

S 17 in SW quadrant.

Thence across TR 77 on ~~the~~ line.

15.50 Desc.

33.00 Creek, 1 lk. wide, course E., asc.

40.00 Set an iron post, 3 ft. long, 1 in. in dia., 26 ins. in the ground for $\frac{1}{4}$ Sec Cor, marked on brass cap $\frac{1}{4}$ S 17 on W. half and S 16 on E. half, and raise a mound of stone, 2 ft. base, $1\frac{1}{2}$ ft. high, W. of Cor Pits impracticable.

43.00 Desc.

80.00 Set an iron post, 3 ft. long, 2 ins. in dia., 24 ins. in the ground for cor of secs. ^{8, 9} 16, and 17, marked on brass cap

65.
Resurvey of

Subdivision of Twp 56 N., R. 103 W.

Chains.

T 56 N S 8 in NW
R 103 W S 9 in NE
S 16 in SE. and
S 17 in SW quadrant, and raise a
mound of stone, 2 ft. base, $1\frac{1}{2}$ ft.
high, W. of Cor. Pits impracticable,
from which

A pine, 10 ins. in dia., bears N.
 83° W. 127 lks. dist., marked

T 56 N R 103 W S 8 BT.

A pine, 4 ins. in dia., bears S.
 $2\frac{3}{4}^{\circ}$ E. 269 lks. dist., marked

T 56 N R 103 W S 16 BT.

A pine, 6 ins. in dia., bears S.
 $23\frac{3}{4}^{\circ}$ W. 149 lks. dist., marked

T 56 N R 103 W S 17 BT.

No other bearings available.

Land, mountainous.

Soil, rocky, 3rd and 4th rate.

Formation, red sandstone and limestone.

Vegetation, sagebrush and grass.

Scattering small pine and pinion tim-
ber and juniper.

June 12: At this Cor. I set off $23^{\circ} 08'$
N. on the decl. arc; and at 11^h 59^m
a.m.l.m.t. observe the sun on the
meridian, the resulting lat. is 44°

Chains.

51' N. or within 30" of the proper
lat.

N. 89° 49' E. on a random line bet. sec
9 and 16.

40.00 Set temp. $\frac{1}{4}$ Sec Cor.

80.04 Intersect N. and S. line at Cor of Secs.
9, 10, 15, and 16.

Thence I run

S. 89° 49' W. on a true line bet. Secs.
9 and 16.

Desc. on rolling land.

4.00 Road bears NW and SE.

40.02 Set an iron post, 3 ft. long, 1 in. in
dia., 26 ins. in the ground for $\frac{1}{4}$ Sec
Cor marked on brass cap $\frac{1}{4}$ S 9 on N.
half, and S 16 on S. half and raise a
mound of stone, 2 ft. base, $1\frac{1}{2}$ ft.
high, N. of Cor. Pits impracticable.

51.49 Intersect line 4-1 TR 77 at a point
from ^{which} Cor No. 1 bears N. 0° 15' W.
9.03 chs. dist.

Set an iron post, 3 ft. long, 1 in. in
dia., 26 ins. in the ground for clos-
ing Cor of fract. secs. 9 and 16,
marked on brass cap

T 56 N TR 77 CC in W. half

R 103 W S 9 in NE and

see page 2/6

Subdivisions of Twp. 56 N., R. 103 W.

Chains.

S 16 in SE quadrant.

Thence across TR 77

73.00 Clark's Fork River 200 lks. wide, course
SE., asc.

75.00 Road bears NW and SE., asc. hilly land.

80.04 The Cor. of Secs. 8, 9, 16 and 17.
Land, rolling 75.00 chs., hilly 5.04 chs.
Soil, rocky, 3rd rate.Vegetation, sagebrush and grass.N. $0^{\circ} 03'$ W. bet. Secs. 8 and 9.

Across TR 77

Desc. on hilly land.

7.70

*Road bears SE and NW.*Point for closing Cor. of fract. secs. 8
and 9 falls in Clark's Fork River,
therefore at84.00 Set an iron post 3 ft. long, 1 in. in
dia., 26 ins. in the ground for wit-
ness closing Cor. of fract. Secs. 8
and 9, marked on brass cap

T 56 N S 8 in NW

R 103 W S 9 in NE quadrant and
W C CC TR 77 in S. half.Thence offset East 3.00 chs. across
Clark's Fork River 2.50 chs. wide;
then run on offset line N. $0^{\circ} 03'$ W.8.25 On true line, enter Clark's Fork River.
2.50 chs. wide, course SE

See page 217

670

68. Resurvey of

Subdivision of Twp 56 N., R. 103 W.

Chains.

9.17 Intersect line 1-2 TR 77 at a point from which Cor. No. 6/76 bears West 11.51 chs. dist. from true line.

Thence bet. Secs. 8 and 9.

40.00 Point for $\frac{1}{4}$ Sec Cor. on true line would fall in Clark's Fork River.

47.34 Offset West 3.00 chs. to true line to margin of Clark's Fork River, course South.

Set an iron post, 3 ft. long, 1 in. in dia., 26 ins. in the ground for witness ^{cor. for} $\frac{1}{4}$ Sec Cor., marked on brass cap $\frac{1}{4}$ S 3 on W. half and W C S 9 on E. half, and raise a mound of stone, 2 ft. base, $1\frac{1}{2}$ ft. high, W. of Cor Pits impracticable.

Asc.

80.00 Set an iron post 3 ft. long, 2 ins. in dia., 24 ins. in the ground for Cor. of Secs. 4, 5, 8, and 9, marked on brass cap

T 56 N S 5 in NW

R 103 W S 4 in NE

S 9 in SE. and

S 8 in SW quadrant, and raise a mound of stone, 2 ft. base, $1\frac{1}{2}$ ft.

Subdivision of Twp 56 N., R. 103 W.

Chains.

high, W. of Cor Pits impracticable.
Land, hilly 8.00 chs., rolling 32.66
chs. in Clark's Fork River, 3 ft.
deep, 39.34 chs.
Soil, rocky, 3rd rate.
Vegetation, sagebrush and grass.

N. 89° 49' E. on a random line bet.
secs. 4 and 9.

40.00
80.08

Set temp. $\frac{1}{4}$ sec. cor

Intersect N. and S. line 2 lks. S. of
Cor of secs. 3, 4, 9, and 10.

Thence I run

S: 89° 48' W. on a true line bet. secs.
4 and 9.

Desc. on rolling land.

29.00

^{bears}
Road $\frac{1}{4}$ NW and SE.

40.04

Set an iron post, 3 ft. long, 1 in.
in dia., 26 ins. in the ground for
 $\frac{1}{4}$ Sec Cor, marked on brass cap $\frac{1}{4}$ 3 4
on N. half and 3 9 on S. half, and
raise a mound of stone, 2 ft. base,
1 $\frac{1}{2}$ ft. high, N. of Cor Pits impracti-
cable.

80.08

The Cor of secs. 4, 5, 8, and 9.
Land, rolling.
Soil, rocky, 3rd rate.

672

Resurvey of ⁷⁰

Subdivision of Twp 56 N., R. 103 W.

Chains.

Vegetation, sagebrush and grass.

N. 0° 03' W. bet secs. 4 and 5.

Asc. over rolling land.

15.00

Road ^{bears} NW and SE.

20.00

Desc.

40.00

Set an iron post, 3 ft. long, 1 in. in dia., 26 ins. in the ground for $\frac{1}{4}$ Sec Cor., marked on brass cap $\frac{1}{4}$ S 5 on W. half and S 4 on E. half, and raise a mound of stone, 2 ft. base, $1\frac{1}{2}$ ft. high, W. of Cor. Pits impracticable.

55.25

Road ^{bears} SW and N. 60° E.

57.50

Road ^{bears} S. 60° W. and NE.

89.88

Intersect Fourteenth Standard Parallel North at a point from which the stan. Cor. of secs. 34, and 35 bears S. 89° 29' W. .09 chs. dist.

Set an iron post, 3 ft. long, 2 ins. in dia., 24 ins. in the ground for closing Cor. of secs. 4 and 5, marked on brass cap

T 57 N R 103 W in N

T 56 N in S

S 34 in NW.

S 35 CC in NE.

S 4 in SE and

71.
Resurvey of

subdivision of Twp 56 N., R. 103 W.

Chains.

S 5 in SW quadrant, and raise a mound of stone, 2 ft. base, $1\frac{1}{2}$ ft.

high, S. of Con Pits impracticable. Land, rolling.

Soil, gravelly, 2nd and 3rd rate.

Vegetation, sagebrush and grass.

June 12, 1911

June 13: At 7h.00^{a.m.}1.m.t. I set off $44^{\circ} 47'$ N. on the lat. arc; $23^{\circ} 11\frac{1}{2}'$ N. on the decl. arc; and determine with the solar a true meridian at the cor. of secs. 5, 6, 31, and 32, which I set November 1, 1910.

Thence I run

N. $0^{\circ} 04'$ W. bet. secs. 31 and 32.

Asc. mountainous E. slope of Bald Ridge.

3.70 Wood trail ^{bears} E. and W.

26.50 Desc., enter scattering pine timber, ^{bearing} E. and W.

39.00 Dry Creek, bed 2 lks. wide in sandstone canyon 300 ft. deep, course E., asc.

40.00 Set an iron post, 3 ft. long 1 in. in dia., 26 ins. in the ground for $\frac{1}{4}$

Sec Cor., marked on brass cap $\frac{1}{4}$ S 31

on W. half and S 32 on E. half, and raise a mound of stone, 2 ft. base,

Subdivision of Twp 56 N., R. 103 W.

Chains.

$1\frac{1}{2}$ ft. high, W. of Cor. Pits impracticable.

- 73.00 Desc.
- 79.25 Gulch, course S. 70° E., asc.
- 80.00 Set an iron post, 3 ft. long, 2 ins. in dia., 24 ins. in the ground for Cor. of secs. 29, 30, 31, and 32, marked on brass cap
 T 56 N S 30 in NW
 R 103 W S 29 in NE
 S 32 in SE and
 S 31 in SW quadrant, and raise a mound of stone, 2 ft. base, $1\frac{1}{2}$ ft. high, W. of Cor. Pits impracticable.
- Land, mountainous.
 Soil, rocky, 3rd and 4th rate.
 Formation, limestone and sandstone.
 Vegetation, sagebrush, grass, moss, and wild flowers.
-
- S. $89^{\circ} 59'$ E. on a random line bet. secs. 29 and 32.
- 40.00 Set temp. $\frac{1}{4}$ Sec Cor
- 79.82 Intersect N. and S. line 12 lks. N. of Cor. of secs. 28, 29, 32, and 33, Thence I run N. $89^{\circ} 54'$ W. on a true line bet. secs.

Subdivision of Twp 56 N., R. 103 W.

Chains.

- 29 and 32.
Across TR 69 on 103 W. line.
Desc. in bottom land in willows.
- .20. Newmeyer Creek, 4 lks. wide, course
N. 60° E., asc.
- 10.50 Newmeyer Creek, 3 lks. wide, course
S. 60° E.
- 14.00 Leave willows, asc. on mountainous N.
slope.
- 30.44 ✓ Intersect line 2-3 TR 69 at a point
from which Cor. No. 2 bears N. 0° 15'
W. 6.92 chs. dist.
Set an iron post, 3 ft. long, 1 in. in
dia., 26 ins. in the ground for clos-
ing Cor. of fract. secs. 29 and 32,
marked on brass cap
T 56 N S 29 in NW
S 32 in SW quadrant and
R 103 W TR 69 CC in E. half.
Thence bet. secs. 29 and 32.
- 37.18 Fence ^{bears} N. and S.
- 39.91 Set an iron post, 3 ft. long, 1 in. in
dia., 26 ins. in the ground for $\frac{1}{4}$ sec
Cor., marked on brass cap $\frac{1}{4}$ S 29 on
N. half and S 32 on S. half, and
raise a mound of stone, 2 ft. base,
1 $\frac{1}{2}$ ft. high, N. of Cor. Pits impracti-

See page 217

676

Resurvey of ⁷⁴

Subdivision of Twp 56 N., R. 103 W.

Chains.

cable.

67.00

Wood trail ^{bears} SE and NW.

79.82

The Cor. of secs. 29, 30, 31, and 32.

Land, rolling 14.00 chs., mountainous
65.82 chs.

Soil, loam and rocky, 2nd and 3rd rate.

Vegetation, willows, sagebrush and
grass.June 13: At this Cor I set off $23^{\circ} 11\frac{1}{2}'$
N. on the decl. arc; and at 12h00 m.
m.l.m.t. observe the sun on the
meridian, the resulting lat. is 44°
 $48'$ N. the proper lat.N. $89^{\circ} 59'$ W. on a random line bet.
secs. 30 and 31.

40.00

Set temp. $\frac{1}{4}$ Sec Cor.

77.78

Intersect W. bdy. of Twp 14 lks. N. of
Cor of secs. 25, 30, 31, and 36, which
I set May 26, 1911.

Thence I run

N. $89^{\circ} 55'$ E. on a true line bet. secs.
30 and 31.Desc. mountainous E. slope in scattering
dead timber.

26.80

Asc. N. slope.

37.78

Set an iron post, 3 ft. long, 1 in. in

Subdivision of Twp 56 N., R. 103 W.

Chains.

dia., 26 ins. in the ground for $\frac{1}{4}$ Sec Cor., marked on brass cap $\frac{1}{4}$ S 30 on N. half and S 31 on S. half, and raise a mound of stone, 2 ft. base, $1\frac{1}{2}$ ft. high, N. of cor. Pits impracticable.

42.40 Desc. E. slope.

72.80 Gulch, course S. 80° E.

77.78 The cor. of secs. 29, 30, 31, and 32.

Land, mountainous.

Soil, rocky, 4th rate.

Formation, sandstone.

Vegetation, grass.

Dead scattering timber.

N. $0^{\circ} 04'$ W. bet. secs. 29 and 30.

Asc. mountainous E. slope in scattering pine and juniper.

5.25 Wood trail, ^{bears} N. 70° E. and S. 70° W.

16.00 Desc.

24.00 Creek, 2 lks. wide, course S. 80° E., asc.

40.00 Set an iron post, 3 ft. long, 1 in. in dia., 26 ins. in the ground for $\frac{1}{4}$ Sec Cor., marked on brass cap $\frac{1}{4}$ S 30 on W. half and S 29 on E. half, from which

678

Resurvey⁷⁶ B

Subdivision of Twp 56 N., R. 103 W.

Chains.

A pine, 4 ins. in dia., bears
S. 16° W., 65 lks. dist., marked
 $\frac{1}{4}$ S 30 BT.

A pine, 8 ins. in dia., bears
S. 79° E. 131 lks. dist., marked
 $\frac{1}{4}$ S 29 BT.

Desc. abruptly on N. slope.

55.90 Creek, 1 lk. wide, course S. 70° E.,
asc.

80.00 Set an iron post, 3 ft. long, 2 ins.
in dia., 24 ins. in the ground for
Cor of secs. 19, 20, 29, and 30,
marked on brass cap
T 56 N S 19 in NW
R 103 W S 20 in NE
S 29 in SE and
S 30 in SW quadrant, and raise a
mound of stone, 2 ft. base, 1 $\frac{1}{2}$ ft.
high, W. of Cor Pits impracticable,
from which
A pine, 4 ins. in dia., bears
S. 39° E 110 lks. dist., marked
T 56 N R 103 W S 29 BT.
No other bearings available.

Land, mountainous.

Soil, rocky, 4th rate.

Formation, sandstone and limestone.

chains.

Vegetation, grass and juniper.
Scattering pine and dead timber.

June 13, 1911.

June 14: At 7^h.00^m. a.m. l.m.t. I set off
44° 48½' N. on the lat. arc; 23° 15'
N. on the decl. arc; and determine
with the solar a true meridian at the
cor. of secs. 19, 20, 29, and 30.

Thence I run

S. 39° 54' E. on a random line bet.
secs. 20 and 29.

40.00 Set temp. ¼ Sec Cor.

79.92 Intersect N. and S. line I4 lks. S. of
cor. of secs. 20, 21, 28, and 29.

Thence I run

West on a true line bet. secs. 20 and
29.

Asc. on hilly E. slope.

20.00 Enter scattering balsam and juniper ^{bearing} N.
and S.

39.96 Set an iron post, 3 ft. long, 1 in. in
dia., 26 ins. in the ground for ¼ Sec
Cor., marked on brass cap ¼ S 20 on
N. half and S 29 on S. half, from which
A balsam, 3 ins. in dia., bears
N. 36° W. 21 lks. dist., marked

680

Resurvey of ^{78.}

Subdivision of Twp 56 N., R. 103 W.

Chains.

 $\frac{1}{4}$ S 20 BT.A balsam, 4 ins. in dia., bears
S. 24° W. 45 lks. dist., marked $\frac{1}{4}$ S 29 BT.Enter mountainous land ^{bears} N. and S.79.92 The cor of secs. 19, 20, 29, and 30.
Land, hilly 39.96 chs., mountainous
39.96 chs.

Soil, rocky, 3rd and 4th rate.

Formation, sandstone.

Vegetation, sagebrush and grass.

Scattering balsam timber and juniper
59.92 chs.S. 89° 55' W. on a random line bet.
secs. 19 and 30.40.00 Set temp. $\frac{1}{4}$ Sec Cor77.59 Intersect W. bdy. of Twp 32 lks. S. of
Cor of secs. 19, 24, 25, and 30,
which I set May 26, 1911.

Thence I run

S. 89° 51' E. on a true line bet. secs.
19 and 30.Desc. on mountainous E. slope in scat-
tering dead timber.37.59 Set an iron post, 3 ft. long, 1 in.
in dia., 26 ins. in the ground for

Subdivision of Twp 56 N., R. 103 W.

Chains.

$\frac{1}{4}$ Sec Cor., marked on brass cap $\frac{1}{4}$ S 19 on N. half and S 30 on S. half, and raise a mound of stone, 2 ft. base, $1\frac{1}{2}$ ft. high, N. of Cor. Pits impracticable.

65.60 Gulch, course S. 60° E., asc.

71.10 Desc.

77.59 The Cor of secs. 19, 20, 29, and 30.

Land, mountainous.

Soil, rocky, 4th rate.

Formation, limestone.

Vegetation, grass.

Scattering dead timber.

June 14: At this Cor I set off $23^{\circ} 15\frac{1}{2}'$ N. on the decl. arc; and at 12h00m m.l.m.t. observe the sun on the meridian, the resulting lat. is $44^{\circ} 49'$ N. or within $30''$ of the proper lat.

N. $0^{\circ} 04'$ W. bet. secs. 19 and 20.

Asc. on mountainous E. slope in scattering pine, fir and dead timber.

40.00 Set an iron post, 3 ft. long, 1 in. in dia., 26 ins. in the ground for $\frac{1}{4}$ Sec Cor., marked on brass cap $\frac{1}{4}$ S 19 on W. half and S 20 on E. half, from

682

Resurvey of

Subdivision of Twp 56 N., R. 103 W.

Chains.

which

A pine, 4 ins. in dia., bears
N. 79° W. 40 lks. dist., marked
 $\frac{1}{4}$ S 19 BT.

A fir, 6 ins. in dia., bears
S. 18° E. 160 lks. dist., marked
 $\frac{1}{4}$ S 20 BT.

52.00

Desc.

62.00

Gulch, course S. 60° E., asc.

72.00

Desc.

77.70

Gulch, course S. 70° E., asc.

80.00

Set an iron post, 3 ft. long, 2 ins.
in dia., 24 ins. in the ground for
Cor. of secs. 17, 18, 19, and 20,
marked on brass cap

T 56 N S 18 in NW

R 103 W S 17 in NE

S 20 in SE and

S 19 in SW quadrant, and raise a
mound of stone, 2 ft. base, 1½ ft.
high, W. of Cor. Pits impracticable.

Land, mountainous.

Soil, rocky, 4th rate.

Formation, limestone and sandstone.

Vegetation, grass.

Scattering pine, fir, and dead timber.

June 14, 1911.

Resurvey ^{SI.} B

Subdivision of Twp 56 N., R. 103 W.

mains.

June 15: At 8h.00_ma.m.l.m.t. I set off
 $44^{\circ} 49\frac{1}{2}^{\circ}$ N. on the lat. arc; $23^{\circ} 18'$
 N. on the decl. arc; and determine
 with the solar a true meridian at
 the Cor. of secs. 17, 18, 19, and 20;

Thence I run

East on a random line bet. secs. 17
 and 20.

40.00 Set temp $\frac{1}{4}$ Sec Cor.

80.28 Intersect N. and S. line 2 lks. N. of
 Cor. of secs. 16, 17, 20, and 21.

Thence I run

N. $89^{\circ} 59'$ W. on a true line bet. secs.
 17 and 20.

Asc. mountainous E. slope in scattering
 small pine timber and juniper.

40.14 Set an iron post, 3 ft. long, 1 in. in
 dia., 26 ins. in the ground for $\frac{1}{4}$
 Sec Cor., marked on brass cap $\frac{1}{4}$ S 17
 on N. half and S 20 on S. half, from
 which

A pine, 5 ins. in dia., bears
 S. 19° E., 27 lks. dist., marked

$\frac{1}{4}$ S 20, BT.

0.00. Leave ^{A pine, 6 ins. in dia., bears N 19° E., 26 lks. dist, marked} live timber and enter dead timber
^{43 17 BT}
 bearing
 N. and S.

80.28 The Cor. of secs. 17, 18, 19, and 20.

684

Resurvey of ⁸²

Subdivision of Twp 56 N., R. 103 W.

Chains.

Land, mountainous.

Soil, rocky, 3rd and 4th rate.

Vegetation, grass and juniper.

Formation, sandstone and limestone.

Scattering pine timber 60.00 chs.,

dead timber 20.28 chs.

June 15: At this cor. I set off $23^{\circ} 18'$

N. on the decl. arc; and at 12h.00 m.

m.l.m.t. observe the sun on the me-

ridian, the resulting lat. is 44° $50'$ or within $30''$ of the proper lat.

 N. $89^{\circ} 51'$ W. on a random line bet.
secs. 18 and 19.
40.00 Set temp $\frac{1}{4}$ Sec Cor.77.59 Intersect W. bdy. of Twp 7 lks. S. of
cor. of secs. 13, 18, 19, and 24,
which I set May 27, 1911.

Thence I run

S. $89^{\circ} 48'$ E. on a true line bet. secs
18 and 19.Asc. mountainous N. slope in scatter-
ing dead timber over limestone cliffs
and slides.34.55 Crest of mountain, ^{bars} NE and SW desc. E.
slope.

37.59 Set an iron post, 3 ft. long, 1 in. in

Subdivision of Twp 56 N., R. 103 W.

Chains.

dia., 26 ins. in the ground for $\frac{1}{4}$
Sec Cor., marked on brass cap $\frac{1}{4}$ S 18 on
N. half and S 19 on S. half, and
raise a mound of stone, 2 ft. base,
 $1\frac{1}{2}$ ft. high, N. of Cor. Pits impracti-
cable.

77.59 The Cor. of secs. 17, 18, 19, and 20.

Land, very mountainous.

Soil, rocky, 4th rate.

Formation, limestone.

Vegetation, grass.

Scattering dead timber.

June 15, 1911.

June 16: At 8h.00 a.m. 1.m t. I set off
 $44^{\circ} 49\frac{1}{2}'$ N. on the lat. arc; 23°
 $21'$ N. on the decl. arc; and deter-
mine with the solar a true meridian
at the Cor. of secs. 17, 18, 19, and
20.

Thence I run

N. $0^{\circ} 04'$ W. bet. secs. 17 and 18.

Asc. on mountainous E. slope in scat-
tering dead timber.

23.00 Desc.

40.00 Set an iron post, 3 ft. long, 1 in.

in dia., 26 ins. in the ground for $\frac{1}{4}$

686

Resurvey of

Subdivision of Twp 56 N., R. 103 W.

Chains.

Sec Cor., marked on brass cap $\frac{1}{4}$ S I8
on W. half and S I7 on E. half, from
which

A pine, 5 ins. in dia., bears
N. 21° W. 198 lks. dist., marked
 $\frac{1}{4}$ S I8 BT.

A pine, 4 ins. in dia., bears
N. 13° E. 218 lks. dist., marked
 $\frac{1}{4}$ S I7 BT.

41.00

Asc.

42.00

Desc. over cliffs and rock slides and
enter scattering small pine timber
bearing
NE and SW. Ridge, bears NE. and SW.

80.00

Set an iron post, 3 ft. long, 2 ins. in
dia., 24 ins. in the ground for Cor.
of secs. 7, 8, 17, and 18, marked on
brass cap

T 56 N S 7 in NW

R 103 W S 8 in NE

S I7 in SE and

S I8 in SW quadrant, from which

A pine, 6 ins. in dia., bears
N. 70° W. 32 lks. dist., marked

T 56 N R 103 W S 7 BT.

A pine, 10 ins. in dia., bears

N. 52° E. 46 lks. dist., marked

T 56 N R 103 W S 8 BT.

A pine, 8 ins. in dia., bears

85.

Resurvey of

Subdivision of Twp 56 N., R. 103 W.

mains.

S. 56° E. 53 lks. dist., marked
T 56 N R 103 W S 17 BT.

A pine, 12 ins. in dia., bears
S. $16\frac{1}{2}^{\circ}$ W. 83 lks. dist., marked
T 56 N R 103 W S 18 BT.

Land, very mountainous.

Soil, rocky, 4th rate.

Formation, limestone.

Vegetation, grass.

Scattering dead timber 42.00 chs., pine
timber 38.00 chs.

June 16: At this cor. I set off $23^{\circ} 21'$
N. on the decl. arc; and at 12h.00m.
m.l.m.t. observe the sun on the
meridian, the resulting lat. is 44°
 $50'$ N. or within $30''$ of the proper
lat.

S. $89^{\circ} 59'$ E. on a random line bet.
secs. 8 and 17.

40.00 Set temp. $\frac{1}{4}$ Sec Cor.
79.84 Intersect N. and S. line 2 lks. N. of
Cor. of secs. 8, 9, 16, and 17.

Thence I run

N. $89^{\circ} 58'$ W. on a true line bet. secs.
8 and 17.

Across TR 77 on

Chains.

- Asc. on mountainous N. slope in limestone rock slides in scattering pine timber.
- 39.92 Set an iron post, 3 ft. long, 1 in. in dia., 26 ins. in the ground for $\frac{1}{4}$ Sec. Cor., marked on brass cap $\frac{1}{4}$ S 8 on N. half and S 17 on S. half, from which
 A pine, 8 ins. in dia., bears N. 25° E. 33 lks. dist., marked $\frac{1}{4}$ S 8 BT.
 A pine, 8 ins. in dia., bears S. 14° E. 21 lks. dist., marked $\frac{1}{4}$ S 17 BT.
- 43.00 Offset North 2.27 chs. to avoid limestone cliff; then run on offset line N. 89° 58' W.
- 51.54 Intersect line 2-3 TR 77 at a point from which Cor. No. 2 bears North 9.14 chs. dist. *from true line.*
 Set an iron post, 3 ft. long, 1 in. in dia., 26 ins. in the ground for witness closing Cor. of fract. secs. 8 and 17, marked on brass cap
 T 56 N S 8 in NW
 S 17 in SW quadrant and
 R 103 W TR 77 W C CC in E. half.
 Thence bet. secs. 8 and 17.

See page 217

87.
Resurvey of

Subdivision of Twp 56 N., R. 103 W.

chains.	Desc.
60.00	Desc.
63.00	Offset South 2.27 chs. to true line.
79.84	The Cor. of secs. 7, 8, 17, and 18. Land, very mountainous. Soil, rocky, 4th rate. Vegetation, sagebrush and grass. Formation, limestone. Scattering pine timber.
	June 16, 1911.
	June 17: At 7h.00 ^{ma} .m.l.m.t. I set off 44° 50½' N. on the lat. arc; 23° 23' N. on the decl. arc.; and determine with the solar a true meridian at the Cor. of secs. 7, 8, 17, and 18. Thence I run N. 89° 48' W. on a random line bet. secs. 7 and 18.
40.00	Set temp. ¼ Sec Cor.
77.57	Intersect W. bdy. of Twp 7 lks. N. of Cor. of secs. 7, 12, 13, and 18, which I set May 27, 1911. Thence I run S. 89° 51' E. on a true line bet. secs. 7 and 18. Asc. over hilly N. slope in scattering pine timber.

Chains.

- 37.57 Set an iron post, 3 ft. long, 1 in. in dia., 26 ins. in the ground for $\frac{1}{4}$ Sec Cor, marked on brass cap $\frac{1}{4}$ S 7 on N. half and S 18 on S. half, from which
- A pine, 5 ins. in dia., bears N. 85° W 45 lks. dist., marked $\frac{1}{4}$ S 7 BT.
- A pine, 5 ins. in dia., bears S. $59\frac{1}{2}^{\circ}$ W. 51 lks. dist., marked $\frac{1}{4}$ S 18 BT.
- 52.10 Asc. granite slides and cliffs ^{bear} NE and SW. Rock spur falls N., desc. on N. slope.
- 77.57 The cor of secs. 7, 8, 17, and 18.
- Land, hilly 37.57 chs., mountainous 40.00 chs.
- Soil, rocky, 4th rate.
- Formation, red granite.
- Vegetation, sagebrush and grass.
- Scattering pine timber.
- June 17: At this cor I set off $23^{\circ} 23'$ N. on the decl. arc; and at 12h.00 m. m.l.m.t. observe the sun on the meridian, the resulting lat. is $44^{\circ} 50'$ N. or within 30" of the proper lat.

Resurvey of ^{89.}

Subdivision of Twp 56 N., R. 103 W.

chains.

N. 0° 04' W. bet. secs. 7 and 8.

Desc. on mountainous N. slope in scattering pine timber.

Enter Clark's Fork River, 275 chs. wide, course N.

40.00

The point for $\frac{1}{4}$ Sec Cor falls in Clark's Fork River, therefore at

34.00

Set an iron post, 3 ft. long, 1 in. in dia., 26 ins. in the ground for witness $\frac{1}{4}$ Sec Cor, marked on brass cap $\frac{1}{4}$ S 7 on W. half and W C S 8 on E. half, from whichA willow, 6 ins. in dia., bears N. 84° W. 28 lks. dist., marked W C $\frac{1}{4}$ S 7 BT.A willow, 6 ins. in dia., bears N. 2° E. 136 lks. dist., marked W C $\frac{1}{4}$ S 8 BT.

34.50

Enter Clark's Fork River, 275 chs. wide, course N.

50.00

Leave Clark's Fork River, course NE asc.

80.00

Set an iron post, 3 ft. long, 2 ins. in dia., 24 ins. in the ground for Cor of secs. 5, 6, 7, and 8, marked on brass cap

T 56 N S 6 in NW

R 103 W S 5 in NE

S 8 in SE and

692

Resurvey of

90.

Subdivision of Twp 56 N., R. 103 W.

Chains.

S 7 in SW quadrant, and raise a mound of stone, 2 ft. base, $1\frac{1}{2}$ ft. high, W. of Cor. Pits impracticable, from which

A pine, 9 ins. in dia., bears
N. 54° E. 135 lks. dist., marked
T 56 N R 103 W S 5 BT.

A pine, 12 ins. in dia., bears
S. $51\frac{3}{4}^{\circ}$ E. 77 lks. dist., marked
T 56 N R 103 W S 8 BT.

A pine, 12 ins. in dia., bears
S. 80° W. 62 lks. dist., marked
T 56 N R 103 W S 7 BT.

No other bearing available.

Land, mountainous 64.50 chs., in Clark's
Fork River 15.50 chs.

Soil, rocky, 4th rate.

Vegetation, sagebrush and grass.

Formation, limestone.

Scattering pine timber and juniper.

S. $89^{\circ} 58'$ E. on a random line bet.
secs. 5 and 8.

40.00 Set temp. $\frac{1}{4}$ Sec Cor

80.08 Intersect N. and S. line 21 lks. S. of
Cor. of secs. 4, 5, 8, and 9.

Thence I run

Resurvey J
 Subdivision of Twp 56 N., R. 103 W.

chains.

S. $89^{\circ} 53'$ W. on a true line bet. secs.
 5 and 8.

Asc. over rolling land.

40.04 Set an iron post, 3 ft. long, 1 in.
 in dia., 26 ins. in the ground for
 $\frac{1}{4}$ Sec Cor., marked on brass cap $\frac{1}{4}$ S. 5
 on N. half and S 8 on S. half, and
 raise a mound of stone, 2 ft. base,
 $1\frac{1}{2}$ ft. high, N. of Cor. Pits impracti-
 cable.

70.00 Enter mountainous land and scattering
 pine timber ^{bearing} N. and S.

80.08 The Cor of secs. 5, 6, 7, and 8.
 Land, rolling 70.00 chs., mountainous
 10.08 chs.

Soil, rocky, 3rd and 4th rate.

Formation, boulders and limestone.

Vegetation, sagebrush and grass.

Scattering pine timber 10.08 chs.

June 17, 1911.

June 18: At 7h.00m.a.m. l.m.t. I set off
 $44^{\circ} 51'$ N. on the lat. arc; $23^{\circ} 25'$
 S. on the decl. arc; and determine
 with the solar a true meridian at
 the Cor of secs. 5, 6, 7, and 8.

Thence I run

Chains.

	N. $89^{\circ} 51'$ W. on a random line bet. secs. 6 and 7.
40.00	Set temp. $\frac{1}{4}$ Sec Cor.
77.22	Intersect W. bdy. of Twp 7 lks. S. of Cor of secs. 1, 6, 7, and 12, which I set May 29, 1911.
	Thence I run
	S. $89^{\circ} 48'$ E. on a true line bet. secs. 6 and 7.
	Desc. over mountainous E. slope in scattering pine and juniper.
7.20	Creek, 6 lks. wide, course S. 10° E., asc. W. slope.
14.60	Granite spur, course S., desc.
27.00	Asc. SW slope.
37.22	Set an iron post, 3 ft. long, 1 in. in dia., 26 ins. in the ground for $\frac{1}{4}$ Sec Cor, marked on brass cap $\frac{1}{4}$ S 6 on N. half and S 7 on S. half, and raise a mound of stone, 2 ft. base, $1\frac{1}{2}$ ft. high, N. of Cor. Pits impracticable.
57.00	Limestone ridge, ^{bears} N. and S., desc.
77.22	The Cor of secs. 5, 6, 7, and 8.
	Land, very mountainous.
	Soil, rocky, 4th rate.
	Vegetation, sagebrush, juniper and grass.

93.
Resurvey of

Subdivision of Twp 56 N., R. 103 W.

chains.

Scattering small pine timber.

Formation, red granite and limestone.

June 18: At this Cor. I set off $23^{\circ} 24\frac{1}{2}'$

N. on the decl. arc; and at 12 h. 00 m.

m.l.m.t. observe the sun on the

meridian, the resulting lat. is 44°

$51'$ N. the proper lat.

N. $0^{\circ} 04'$ W. bet. secs. 5 and 6.

Asc. on mountainous E. slope on limestone rock slides and cliffs in scattering pine timber.

25.00 Desc.

39.00 Asc.

40.00 Set an iron post, 3 ft. long, 1 in. in

dia., 26 ins. in the ground for $\frac{1}{4}$

Sec Cor., marked on brass cap $\frac{1}{4}$ S 6 on

W. half and S 5 on E. half, from

which

A pine, 4 ins. in dia., bears

S. 88° W. 198 lks. dist., marked

$\frac{1}{4}$ S 6 BT.

A pine, 4 ins. in dia., bears

N. 89° E. 223 lks. dist., marked

$\frac{1}{4}$ S 5 BT.

45.00 Desc.

67.00 Asc.

79.60 Ridge ^{beats} NW and SE, desc.

696

Resurvey of ^{94.}

Subdivision of Twp 56 N., R. 103 W.

Chains.

89.60

Intersect Fourteenth Standard Parallel

North at a point from which the
which is set, marked, and witnessed, as described by the survey or general.
 stan. cor. of secs. 33 and 34, bears

East .05 chs. dist.

Set an iron post, 3 ft. long, 2 ins.
 in dia., 24 ins. in the ground for
 closing cor. of secs. 5, and 6, marked
 on brass cap

T 57 N R 103 W in N

T 56 N in S

S 33 CC in NW.

S 34 in NE

S 5 in SE and

S 6 in SW quadrant, from which

A pine, 8 ins. in dia., bears

S. $38\frac{1}{2}^{\circ}$ E. 31 lks. dist., marked

T 56 N R 103 W S 5 BT.

A fir, 24 ins. in dia., bears

S. 42° W. 21 lks. dist., marked

T 56 N R 103 W S 6 BT.

Land, mountainous.

Soil, rocky, 4th rate.

Formation, limestone and red sandstone.

Vegetation, sagebrush, juniper, and
 grass.

Scattering pine timber.

June 18, 1911.

94 $\frac{1}{2}$
Resurvey of Tp 56 N R 103 W.

Final Test of Instrument.

June 18, 1911. At camp in the SW $\frac{1}{4}$ of Sec 9, T 56 N R 103 W, in latitude 44° 50 $\frac{1}{2}$ ' N., longitude 109° 17' W. ÷ I set off 44° 50 $\frac{1}{2}$ ' N. on the lat. arc: 23° 27 $\frac{1}{2}$ ' N. on the decl. arc; and at 6 h 00 m. p. m. l. m. t. determine with the solar a meridian and mark a point thereof, on a stake firmly driven in the ground 5. chs. N. of my station.

June 19. At 1 h. 46 m. a. m. l. m. t. I observe Polaris at eastern elongation, in accordance with Manual of Instructions, and mark a point in the line thus determined, on a stake driven in the ground, 5. chs. N. of my station.

At 5 h. 45 m. a. m. l. m. t. I lay off the azimuth of Polaris, 1° 39.2' to the west, and mark the meridian thus determined, by a tack in the stake set June 18, on which the meridian falls 0.3 ins. east of the mark determined by the solar.

At 6 h. 00 m. a. m. l. m. t. I set off

94 $\frac{1}{2}$

Resurvey of Tp 56 N R 103 W.

44° 50 $\frac{1}{2}$ ' N. on the lat. arc; 23° 27 $\frac{1}{2}$ ' N. on the decl. arc; and mark a point in the meridian determined with the solar, on the stake already set 5. chs. N. of my station; this mark falls 0.2 ins. east of the meridian established by the Polaris observation.

The solar apparatus, by p. m. and a. m. observations defines positions for meridians, respectively about 0' 16" west and 0' 10" east of the meridian established by the Polaris observations; therefore I conclude that the adjustments of the instrument are satisfactory.

The magnetic bearing of the true meridian at 6 h. 15 m. a. m. is N. 16° 40' W.; the angle thus determined gives the mag. decl. 16° 40' E.

June 19, 1911.

700



The State Land Selections in Secs 8, 9, 13, 14, 15, 22, 23, and 24, are unimproved and unoccupied and, by the consent of the State Commissioner of Public Lands, is left to conform to the resurvey.

June 6, 1911.

MEANDERS.

Meander of Hogan Reservoir.

I commence at the meander Cor of fractl. Secs. 33 and 34 on S bank of Reservoir June 9: At this Cor at 6h30 m.a.m. 1. m. t. I set off $44^{\circ} 47'$ N. on the lat. arc; $22^{\circ} 54\frac{1}{2}'$ N. on the decl. arc; and determine with the solar a true meridian.

Thence I run with meanders in Sec 34. Along S. bank of Reservoir.

S. 52° E. 7.60 chs.

S. 87° E. 4.20 chs.

N. 47° E. 3.50 chs.

N. $32\frac{1}{2}^{\circ}$ E. 4.40 chs.

N. 37° E. 3.60 chs. To S. end of dam.

N. 24° W. 3.90 chs. To N. end of dam.

N. $70\frac{1}{2}^{\circ}$ W. 8.40 chs. Along N. bank.

N. $72\frac{1}{2}^{\circ}$ W. 3.50 chs.

N. 56° W. 5.50 chs. To the meander Cor of fractl. Secs. 33 and 34.

Land, hilly.

Soil, loam and rocky 2nd and 3rd rate.

Vegetation, sagebrush and grass.

Thence in Sec 33.

Along N. bank.

N. 73° W. 5.50 chs.

N. $26\frac{1}{4}^{\circ}$ W. 8.20 chs.

N. 49° W. 6.40 chs.

N. $38\frac{1}{2}^{\circ}$ W. 4.70 chs.

S. 23° W. 9.60 chs.

S. 62° E. 2.60 chs. Along S. bank.

167.

Meanders T. 56N; R. 103W

S. $55\frac{1}{2}^{\circ}$ E. 5.90 chs.
 S. $82\frac{1}{4}^{\circ}$ E. 4.90 chs.
 S. $52\frac{3}{4}^{\circ}$ E. 6.10 chs
 S. 16° E. 3.30 chs. To mouth of supply
 ditch 5 lks. wide.

S. 43° E. 2.00 chs.
 S. $30\frac{1}{2}^{\circ}$ E. 6.20 chs. To meander cor of
 fracl.secs. 33 and 34.

Land, hilly.
 Soil, loam and rocky, 2nd and 3rd rate.
 Vegetation, sagebrush and grass.

Meander of Luce Reservoir.

I commence at the meander cor of fracl.
 secs. 3 and 34 on E. bank of Reservoir.

Thence I run with meanders in Sec 34.

N. $24\frac{1}{2}^{\circ}$ E. 4.10 chs. To E. end of dam.
 N. 64° W. 3.10 chs. To outlet pipe.

N. 64° W. 8.40 chs. To W. end of dam.
 S. $27\frac{1}{4}^{\circ}$ W. 10.00 chs. Along W. bank,
 to meander cor of
 fracl.secs. 3 and 34.

Land, hilly.
 Soil, loam and rocky, 2nd and 3rd rate.
 Vegetation, sagebrush and grass.

June 9, 1911.

General Description.

T. 56 N., R. 103 W.

The land in this township varies from bench and rolling land on the east to the very mountainous and precipitous Clark's Fork Canyon in the west. The soil is mostly 3rd and 4th rate with boulders and rocks except along the stream valleys where it is a 1st and 2nd rate loam.

Bald Ridge, covered with scattering dead timber and some small pine and fir, rises north along the west boundary of the township to an elevation of about 9000 feet above sea level on the west boundary of Sec. 19. Its slopes fall east for about two miles where the land becomes.

General Description.

T 56 N. R. 103 W

hilly. The formation is a limestone, dipping to the east at an angle of about 15° on the top of the mountain, while at the base, the angle of depression is about 40°. At the base also formations of big red and light yellow sandstone overlie the limestone, dipping to the east at about 45° to 60° from the horizontal. In Sec 21 some veins of coal about two feet thick outcrop with a strike north and south, lying nearly vertical. On secs. 17, 18, and 19, are the south walls of Clark's Fork Canyon which rise about 4,000 feet above the river in a series of short cliffs and rock slides. The formation in Sec 18 is a dark red intrusive granite, cut by blank dykes of diorite, and eroded into very steep walls. Above this formation is the basal conglomerate of the sedimentary series above, and here the slopes are steep, but cliffs do not occur and there is a moderately thick growth of medium sized pine, fir, and balsam timber. The highest remaining formation is the limestone of which a thickness

General Description.

T 56 N., R. 103 W

of from 1500 to 2000 feet is revealed in the cliffs and rock slides, running NE through secs. 19, 18, and 17. The North side of the canyon is steep and rocky, but not so abrupt as the south side and the timber, mostly fir, is more dense and larger. The formation is red granite along the west bdy. of secs. 6 and 7, while it is limestone along the east bdys. of these secs.

Clark's Fork River after passing out of this canyon runs in an easterly direction across the township through rolling land strewn with boulders left by the river over these plains during the process of cutting down the canyon. This formation of boulders, which makes it a very difficult matter to till the soil, occurs over practically all of the township not occupied by the mountainous land. Owing to the abundance of water in Paint Creek, irrigation systems of ditches and reservoirs have been built and considerable areas of land have been reclaimed by settlers in the SE part of the township, and yield two crops of alfalfa per season. Good

General Description.

T 56 N R 10 3 W

crops of wheat and oats are also grown. Paint Creek is a stream of pure water about 20 to 50 lks. in width, flowing NE through the Southern portion of the township into Clark's Fork River. Clark's Fork River is from 2.50 to 2.75 chs. in width, not meanderable, about 2 to 3 ft. deep and rather swift; its bed is composed of boulders. As the land along it is too rocky for cultivation, no ditches are taken out. Lake Creek, a small stream from 4 to 6 lks. in width, comes into the township on the north and runs SE into the River. One ditch is taken from it for irrigation purposes.

A high ridge of hills runs through secs. 3, 10, and 11. The formation is sandstone, shale, and boulders. The land is 3rd and 4th rate, the vegetation sagebrush and grass, making good range for stock.

The land not under cultivation, and where not too mountainous, in the entire township, is used as range for cattle, horses, and sheep.

There are settlers in secs 12,

General Description.

T56N., R103W

13, 14, 22, 23, 24, 25, 26, 27, 34,
and 35.

June 18, 1911.

Albert B. Bartlett

U. S. Deputy Surveyor

TOPOGRAPHY
Township 56 North. Range 103 West.

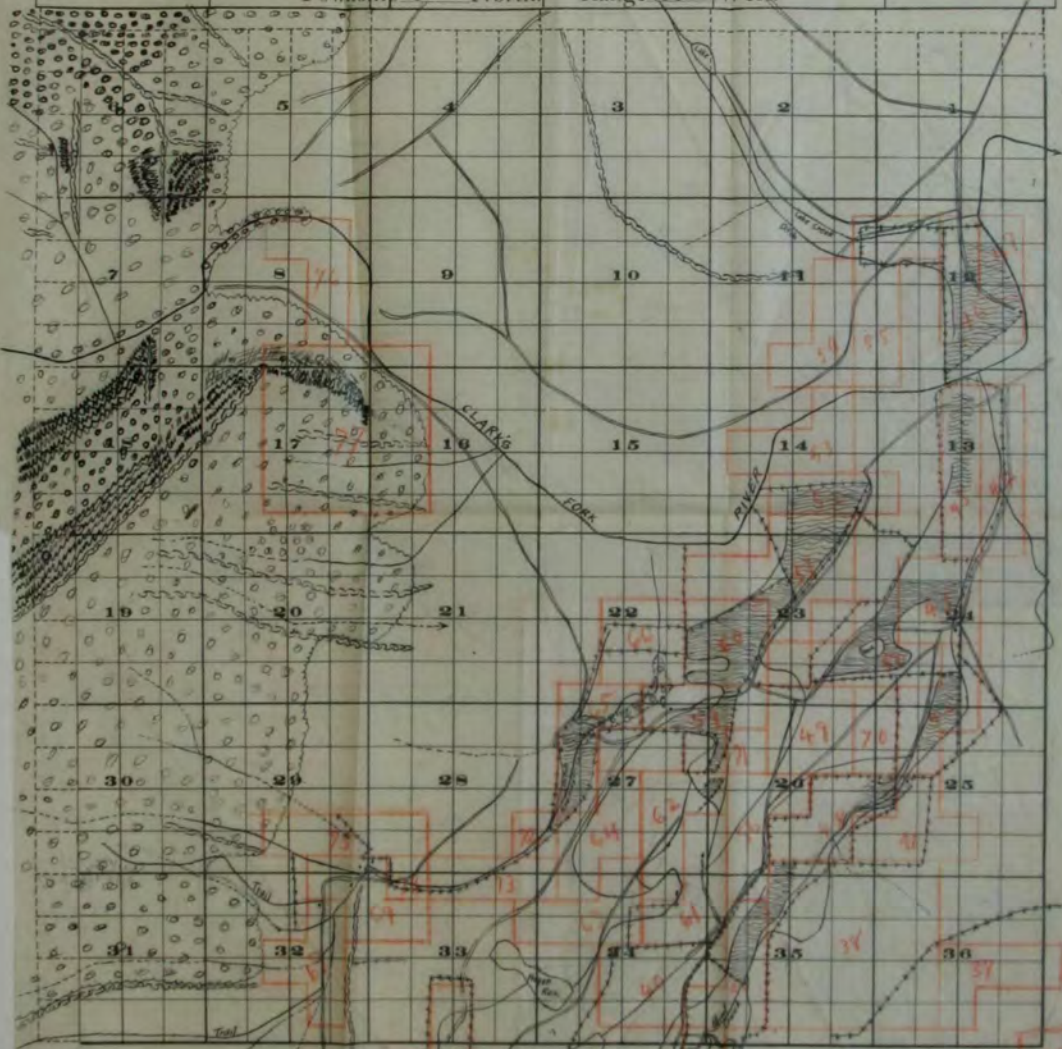

Map of the Prairie and Mountain West

780

Sec 33

Sec 34

Sec 35

Sec 36

Sec 37

Sec 38

Township 756 North, Range 103 West.

589° 29' W 80.92 589° 36' W 80.76 589° 36' W 80.82 589° 38' W 80.78

77.24 80.14 80.27 79.65 79.96 80.00

6 5 4 3 2 1

589° 48' E 589° 53' W 80.03 West 389' 589° 48' W 80.08 N89° 59' W 80.14 N89° 59' W 79.96 N89° 59' W 79.98

37.22 37.22 37.22 37.22 37.22 37.22

7 8 9 10 11 12

589° 51' E 589° 53' W 79.84 N89° 58' W 589° 53' W 80.04 N89° 58' W 80.04 N89° 58' W 79.90 N89° 58' W 79.90

37.57 37.57 37.57 37.57 37.57 37.57

14 15 16 17 18 19

589° 48' E N89° 59' W 80.28 589° 49' W 80.26 N89° 58' W 79.90 N89° 58' W 79.90 N89° 58' W 79.90

37.59 37.59 37.59 37.59 37.59 37.59

19 20 21 22 23 24

589° 51' E W 407' 79.92 589° 52' W 80.40 N89° 58' W 79.90 N89° 58' W 79.90 N89° 58' W 79.90

37.59 37.59 37.59 37.59 37.59 37.59

28 29 30 31 32 33

N89° 58' E 79.82 N89° 58' W 80.12 N89° 58' W 80.12 N89° 58' W 80.12 N89° 58' W 80.12 N89° 58' W 80.12

37.78 37.78 37.78 37.78 37.78 37.78

31 32 33 34 35 36

N89° 58' W N89° 58' W N89° 58' W N89° 58' W N89° 58' W N89° 58' W

37.78 37.78 37.78 37.78 37.78 37.78

N89° 58' W

117

FINAL OATHS FOR SURVEYS.

LIST OF NAMES.

A list of the names of the individuals employed by

Albert B. Bartlett

United States Deputy Surveyor, to assist in running, measuring, and marking the lines and corners described in the foregoing field notes of

the survey of *the subdivision, meander,*

and connecting lines, private land claims, school sections and state land selections, of T 53, 54, ~~55~~, and 55 N R 103 W and T 55 and 56 N R 102

West of the Sixth Principal Meridian, in Wyoming, showing the respective capacities in which they acted.

....., Chainman.

....., Chainman.

....., Chainman.

....., Chainman.

....., Azman.

James A. Brown, Moundsman.*Nelson H. Noonan*, Flagman.

FINAL OATHS OF ASSISTANTS.

We hereby certify that we assisted

Albert B. Bartlett

United States Deputy Surveyor, in surveying all those parts or portions

of the ~~survey of~~ the subdivision, *meander, and connecting lines, private land claims, school sections and state land selections, of T 53, 54, and 55 N R 10 3W and T 55 and 56 N R 11 2*

West of the Sixth Principal Meridian in Wyoming, which are represented in the foregoing field notes as having been ^{to} surveyed by him and under his direction; and that said ^{to} survey has been in all respects, to the best of our knowledge and belief, well and faithfully ^{to} surveyed,

and the corner monuments established, according to the instructions furnished by the United States Surveyor-General for Wyoming.

....., Chainman.
....., Chainman.
....., Chainman.
....., Chainman.
....., Axman.

James A. Brown Moundsman.
Nelson H. Noonan Flagman.

Subscribed and sworn to before me this *15th*

day of *September*, 19*00*

Albert B. Bartlett
U.S. Deputy Surveyor.

FINAL OATH OF U. S. DEPUTY SURVEYOR.

~~I,,
United States Deputy Surveyor, do solemnly swear that in pursuance
of instructions received from
.....
United States Surveyor-General for Wyoming, bearing date of the
..... day of, 190....., I have well, faith-
fully, and truly, in my own proper person, and in strict conformity
with the instructions furnished by the United States Surveyor-General~~

for Wyoming, the Manual of Surveying Instructions and the laws of the United States, surveyed all those parts or portions of

West of the Sixth Principal Meridian in Wyoming, as are represented in the foregoing field notes as having been surveyed by me and under my directions; and I do further solemnly swear that all the corners of said surveys have been established and perpetuated in strict accordance with the Manual of Surveying Instructions and the special written instructions of the United States Surveyor-General for Wyoming, and in the specific manner described in the field notes, and that the foregoing are the true field notes of such surveys.

United States Deputy Surveyor.

Subscribed and sworn to before me this
day of _____, 190

FINAL OATHS FOR SURVEYS.

LIST OF NAMES.

A list of the names of the individuals employed by

Albert B. Bartlett

United States Deputy Surveyor, to assist in running, measuring, and marking the lines and corners described in the foregoing field notes of

the survey of ~~meanders~~ *resurvey of the subdivision,*
and connecting
lines, private land claims, school
sections, and state land selections
of T 53, 54, ~~55~~, and 55 N, R 103 W, and
T 55 ~~56~~ N, R 102

West of the Sixth Principal Meridian, in Wyoming, showing the respective capacities in which they acted.

Albert Park, Chainman.

Eric R. Harley, Chainman.

Clarence C. Busby, Chainman.

, Chainman.

John A. Elgin, Axman.

Walter L. Hoffmann, Moundsman.

Argus E. Jewellen, Flagman.

FINAL OATHS OF ASSISTANTS.

We hereby certify that we assisted

Albert B. Bartlett

United States Deputy Surveyor, in surveying all those parts or portions of the ~~resurvey of the~~ subdivision, meander, and connecting lines, private land claims, school sections, and state land selections of T53, 54, ~~55~~, and 55 N, R103 W, and T35 and 56 N R102

West of the Sixth Principal Meridian in Wyoming, which are represented in the foregoing field notes as having been ^{to} surveyed by him and under his direction; and that said ^{to} survey has been in all respects to the best of our knowledge and belief, well and faithfully ^{to} surveyed

and the corner monuments established, according to the instructions furnished by the United States Surveyor-General for Wyoming.

Albert Park, Chainman.

Eric R. Darley, Chainman.

Clarence C. Luby, Chainman.

Chainman.

John A. Elgin, Axman.

Walter L. Hoffman, Moundsman.

Argus E. Sewall, Flagman.

Subscribed and sworn to before me this

first

day of *December*, 19*80*

Albert B. Bartlett

U.S. Deputy Surveyor.

FINAL OATH OF U. S. DEPUTY SURVEYOR.

I, _____

United States Deputy Surveyor, do solemnly swear that in pursuance of instructions received from _____

United States Surveyor-General for Wyoming, bearing date of the

_____ day of _____, 190____, I have well, faith-

fully, and truly, in my own proper person, and in strict conformity

with the instructions furnished by the United States Surveyor-General

for Wyoming, the Manual of Surveying Instructions and the laws of the United States, surveyed all those parts or portions of

West of the Sixth Principal Meridian in Wyoming, as are represented in the foregoing field notes as having been surveyed by me and under my directions; and I do further solemnly swear that all the corners of said surveys have been established and perpetuated in strict accordance with the Manual of Surveying Instructions and the special written instructions of the United States Surveyor-General for Wyoming, and in the specific manner described in the field notes, and that the foregoing are the true field notes of such surveys.

United States Deputy Surveyor.

Subscribed and sworn to before me this _____
day of _____, 190

FINAL OATHS FOR SURVEYS.

LIST OF NAMES.

A list of the names of the individuals employed by _____

Albert B. Bartlett

United States Deputy Surveyor, to assist in running, measuring, and marking the lines and corners described in the foregoing field notes of

the survey of *the subdivision, meander, and connecting lines, private land claims, school sections, and state land selections, of T 53, 54, 55, and 56 N R 103 and T 55 and 56 N R 102 W*

West of the Sixth Principal Meridian, in Wyoming, showing the respective capacities in which they acted.

Clarence C. Lusby, Chainman.

James A. Cain, Chainman.

....., Chainman.

....., Chainman.

Foster Watkins, Axman.

Albert Park, Moundsman.

Walter L. Hoffmann, Moundsman

Howell F. Haylette, Flagman.

FINAL OATHS OF ASSISTANTS.

We hereby certify that we assisted

Albert B. Bartlett

United States Deputy Surveyor, in surveying all those parts or portions

of the ~~survey of the subdivision men-~~

~~under, and connecting lines, private~~

~~land claims, school sections, and~~

~~state land selections, of T 53, 54,~~

~~and 55 N R 103 W 4 & T 55 and 56~~

~~N R 103~~

West of the Sixth Principal Meridian in Wyoming, which are represented in the foregoing field notes as having been ^{to} surveyed by him and under his direction; and that said ^{to} survey has been in all respects, to the best of our knowledge and belief, well and faithfully ^{to} surveyed,

and the corner monuments established, according to the instructions furnished by the United States Surveyor-General for Wyoming.

Clarence C. Judy Chainman.
James A. Cinn, Chainman.
 _____, Chainman.
 _____, Chainman.

Foster Watkins, Axman.
Albert Park, Moundsman.
Walter L. Hoffman Moundsman
Howell & Hayshille, Flagman.

Subscribed and sworn to before me this *18th* _____

day of *June*, 190*1*

Albert B. Bartlett

U. S. Deputy Surveyor.

FINAL OATH OF U. S. DEPUTY SURVEYOR.

I, *Albert B. Bartlett*

United States Deputy Surveyor, do solemnly swear that in pursuance of instructions received from *Alpheus P. Hanson*

United States Surveyor-General for Wyoming, bearing date of the *16th* day of *August*, 190*1*, I have well, faithfully, and truly, in my own proper person, and in strict conformity with the instructions furnished by the United States Surveyor-General

for Wyoming, the Manual of Surveying Instructions and the laws of the United States, surveyed all those parts or portions of ~~the resurvey of the subdivision, meander, and connecting lines, private land claims, school sections, and State Land Selections of Twp. 53, 54, 55, and 56 N., R. 103 W. and Twp. 55 and 56 N., R. 102 W.~~

West of the Sixth Principal Meridian in Wyoming, as are represented in the foregoing field notes as having been ^{to} surveyed by me and under my directions; and I do further solemnly swear that all the corners of said ^{to} surveys have been established and perpetuated in strict accordance with the Manual of Surveying Instructions and the special written instructions of the United States Surveyor-General for Wyoming, and in the specific manner described in the field notes, and that the foregoing are the true field notes of such ^{to} surveys.

Albert B. Bartlett

United States Deputy Surveyor.

Subscribed and sworn to before me this Thirtieth day of September, 1901.

Alphens, P. Hanson

U. S. Surveyor General for Wyoming.

18-2-11

835

832

U. S. Surveyor-General's Office,

CHEYENNE, WYOMING,

November 21, 1913.

The foregoing Field Notes of the survey of the private
land claims and the resurvey of subdivi-
sion lines of Township 56 North, Range 103

West of the Sixth Principal Meridian in the State of Wyo-
ming, executed by Albert B. Bartlett,

U. S. Deputy Surveyor, under his contract
No. 341 dated Aug. 16, 1909

having been critically examined and the necessary correc-
tions and explanations made, the said Field Notes and the
surveys they describe are hereby approved.

Charles L. Decker

U. S. Surveyor-General for Wyoming.

836

833-835

Blank

BOOK No. G-3

FIELD NOTES

OF THE SURVEY OF

The Private Land Claim, Augusta A. ^{Brough}~~Brough~~, inTownship 56 NorthRange 103

West of the Sixth Principal Meridian in Wyoming.

AS SURVEYED BY

Walter E. Hoffman, United States Surveyor,

Under ~~contract No.~~ ^{instructions}, dated May 22, 1912.Survey commenced June 17, 1912Survey completed June 21, 1912

Platted by _____

_____, 190____

Copied for Washington by _____

_____, 190____

Copied for Register by _____

_____, 190____

Transcribed by RMB _____

_____, 190____

O.K.E.O.T.S.L.

NAMES AND DUTIES OF ASSISTANTS.

James H. Jordan Chainman.

Charles F. Fairchild Chainman.

..... Axman.

..... Moundsman.

Charles O. Capper Flagman.

..... Flagman.

INDEX.

Township 56 North Range 103 West

6	5	4	3	2	1
7	8	9	10	11	12
18	17	16	15	14	13
19	20	21	22	23	24
30	29	28	27	26	25
31	32	33	34	35	36

T. 56 N. R. 103 W.

T. 56 N., R. 103 W.

Private Land Claim No. 78.

Chains

Survey executed June 21, 1912, with Young and Sons light mountain transit No. 8290, with solar attachment, the instrument having been more fully described in my book of the field notes of private land claim surveys in T. 55 N., R. 103 W.

At 9h 30m, a.m. l.m.t., I set off 44° 51' on the lat. arc; and 23° 28' N. on the decl. arc; and determine a meridian with the solar at the cor. No. 2 of private land claim tract No. 45, which is a 1 in. iron post, 21 ins. above ground, firmly set, mkd.

T 56 N
R 103 W
S 13

2
TR 45

As this is to be also cor. No. 1 of tract No. 78, I add to the markings to make it read

T 56 N
R 103 W
S 13

1 | 2
TR 78 | TR 45

See book F., page 81

T. 56 N., R. 103 W.

Private Land Claim, No. 78.

Chains

As the $\frac{1}{4}$ cor. point between old secs. 13 and 18, and the point for the cor. of old secs. 13, 18, 19 and 24, are both lost, I run thence S. $0^{\circ} 2' W.$ on a true line.

20.26 Set a 1 in. iron post, 24 ins. in the ground, for cor. No. 4 of tract No. 78
mkd. T 56 N
R 103 W

T R 78	4	T R
S 13		45

From cor. No. 1 of tract No. 52, I run N. $0^{\circ} 1' E.$ on a random line.

20.25 Marked temporary $\frac{1}{4}$ $\frac{1}{4}$ cor.

41.31. Intersect the ~~W. C.~~^{witness cor.} of cor. No. 4 of tract No. 55, which is a 1 in. iron post, 12 ins. above ground, firmly set, mkd.

T 56 N	
R 103 W	
T R 55	4
W C	S 13

To make it also the ~~W. C.~~^{witness cor.} of cor. No. 2, of tract No. 78, I add marks to it so that it reads

See page 81, book F.

See page 137

T. 56 N., R. 103 W.

Private Land Claim No. 78.

Chains

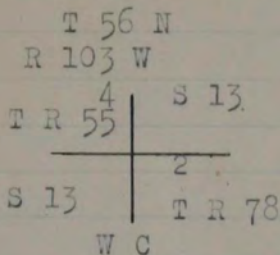

Thence I run

S. 0° 1' W. on a true line.

The true point for cor. No. 2 of tract No. 78 and cor. No. 4 of tract 55

0.81
21.06

Set a 1 in. iron post, 24 ins. in the

ground, for cor. No. 3 of tract
No 78, mkd.

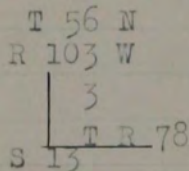

See page 157

41.31 Cor. No. 1 of tract No. 52.

To test my line I run from cor. No. 3
of tract No. 78, N. 89° 32' E.

20.12 Intersect cor. No. 4 of tract No. 78.

June 21, 1912.

Note: For the notes of the survey of private land claim tract No. 79, which lies partly within this township, see book of private land claim surveys, in T. 55 N., R. 103 W.

Walter E. Hoffman,
U.S. Surveyor.

TRANSCRIBED COPY OF ORIGINAL FIELD NOTES 841

T. 56 N., R. 103 W.

Private Land Claim No. 78.

Chains

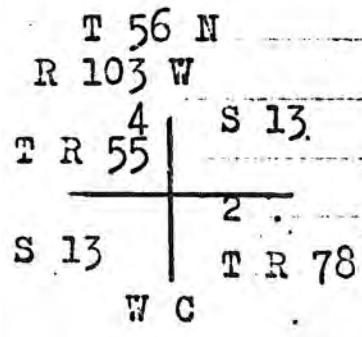

Thence I run

S. $0^{\circ} 1' W.$ on a true line.

The true paid for cor. No. 2 of tract No. 78 and cor. No. 4 of tract 55
Set a 1 in. iron post, 24 ins. in the

ground, for cor. No. 3 of tract
No 78, mkd.

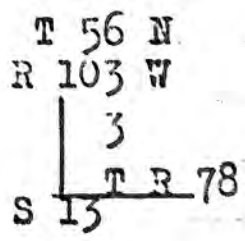

0.81
21.06

See page 157

41.31

Cor. No. 1 of tract No. 52.

To test my line I run from cor. No. 3
of tract No. 78, N. $89^{\circ} 32' E.$

20.12

Intersect cor. No. 4 of tract No. 78.

June 21, 1912.

Note: For the notes of the survey of private land claim tract No. 79, which lies partly within this township, see book of private land claim surveys, in T. 55 N., R. 103 W.

Walter E. Hoffman,
U.S. Surveyor.

846

842-843
Blank

FINAL OATHS FOR SURVEYS.

LIST OF NAMES.

A list of the names of the individuals employed by

Walter E. Hoffman

United States Deputy Surveyor, to assist in running, measuring, and
 marking the lines and corners described in the foregoing field notes of
 the survey of private land claims in Township

56 North, Range 103 West

West of the Sixth Principal Meridian, in Wyoming, showing the
 respective capacities in which they acted.

..... James H. Jordan, *Chainman.*
 Charles F. Fairchild, *Chainman.*
, *Chainman.*
, *Chainman.*
, *Arman.*
, *Moundsman.*
 Charles O. Capper, *Flagman.*

FINAL OATHS OF ASSISTANTS.

We hereby certify that we assisted Walter E. Hoffman

.....
 United States ~~Deputy~~ Surveyor, in surveying all those parts or portions
 of the private land claims in Township 56
North, Range 103 West

.....
 West of the Sixth Principal Meridian in Wyoming, which are repre-
 sented in the foregoing field notes as having been surveyed by him
 and under his direction; and that said survey has been in all respects,
 to the best of our knowledge and belief, well and faithfully surveyed,

and the corner monuments established, according to the instructions furnished by the United States Surveyor-General for Wyoming.

James H. Jordan, Chainman.
Charles F. Fairchild, Chainman.
 _____, Chainman.
 _____, Chainman.
 _____, Axman.
 _____, Moundsman.

Charles O. Capper Flagman.

Subscribed and sworn to before me this 27th

day of June, 1902

Walter E. Hoffman

U. S. Surveyor

FINAL OATH OF U. S. DEPUTY SURVEYOR.

I, Walter E. Hoffman

United States Deputy Surveyor, do solemnly swear that in pursuance of instructions received from Alpheus P. Hanson

United States Surveyor-General for Wyoming, bearing date of the 22nd day of May, 1902, I have well, faithfully, and truly, in my own proper person, and in strict conformity with the instructions furnished by the United States Surveyor-General

for Wyoming, the Manual of Surveying Instructions and the laws of the United States, surveyed all those parts or portions of private land claims in Township ⁵⁶North, Range 103 West

West of the Sixth Principal Meridian in Wyoming, as are represented in the foregoing field notes as having been surveyed by me and under my directions; and I do further solemnly swear that all the corners of said surveys have been established and perpetuated in strict accordance with the Manual of Surveying Instructions and the special written instructions of the United States Surveyor-General for Wyoming, and in the specific manner described in the field notes, and that the foregoing are the true field notes of such surveys.

Walter E. Hoffman
United States Deputy Surveyor.

Subscribed and sworn to before me this

day of

April

, 1903

Charles L. Spencer,

United States Commissioner for the District of Minnesota.

U. S. Surveyor-General's Office,

CHEYENNE, WYOMING,

November 21,....., 1913.

The foregoing Field Notes of the survey of..... of the
private land claim, Augusta A. Brough,
in Township 56 North, Range 103

West of the Sixth Principal Meridian in the State of Wyo-
ming, executed by..... Walter E. Hoffman,.....

U. S. Deputy Surveyor, under instructions.....
dated..... May 22, 1912.....

having been critically examined and the necessary correc-
tions and explanations made, the said Field Notes and the
surveys they describe are hereby approved.

Charles L. Decker

U. S. Surveyor-General for Wyoming.

