

T. 47 N., R. 104 W., Sixth Principal Meridian, Wyoming, Field Note Links

Plat Accession Number(s)	Year(s) of Survey	
		Township Subdivision Plats
3649	1883	https://www.wy.blm.gov/cadastral/countyplats/park/fieldnotes/t47nr104w_c211fn.pdf
		Township Exterior Plats
3675	1883	https://www.wy.blm.gov/cadastral/countyplats/park/fieldnotes/ext3675.pdf
3253	1883	https://www.wy.blm.gov/cadastral/countyplats/hotsprings/fieldnotes/ext3253.pdf
3253	1883	https://www.wy.blm.gov/cadastral/countyplats/hotsprings/fieldnotes/retext2019.pdf
3251	1883	https://www.wy.blm.gov/cadastral/countyplats/fremont/fieldnotes/ext3251.pdf

3649

TOWNSHIP NO 47 NORTH, RANGE NO 104 WEST of the 6TH Principal MERIDIAN.

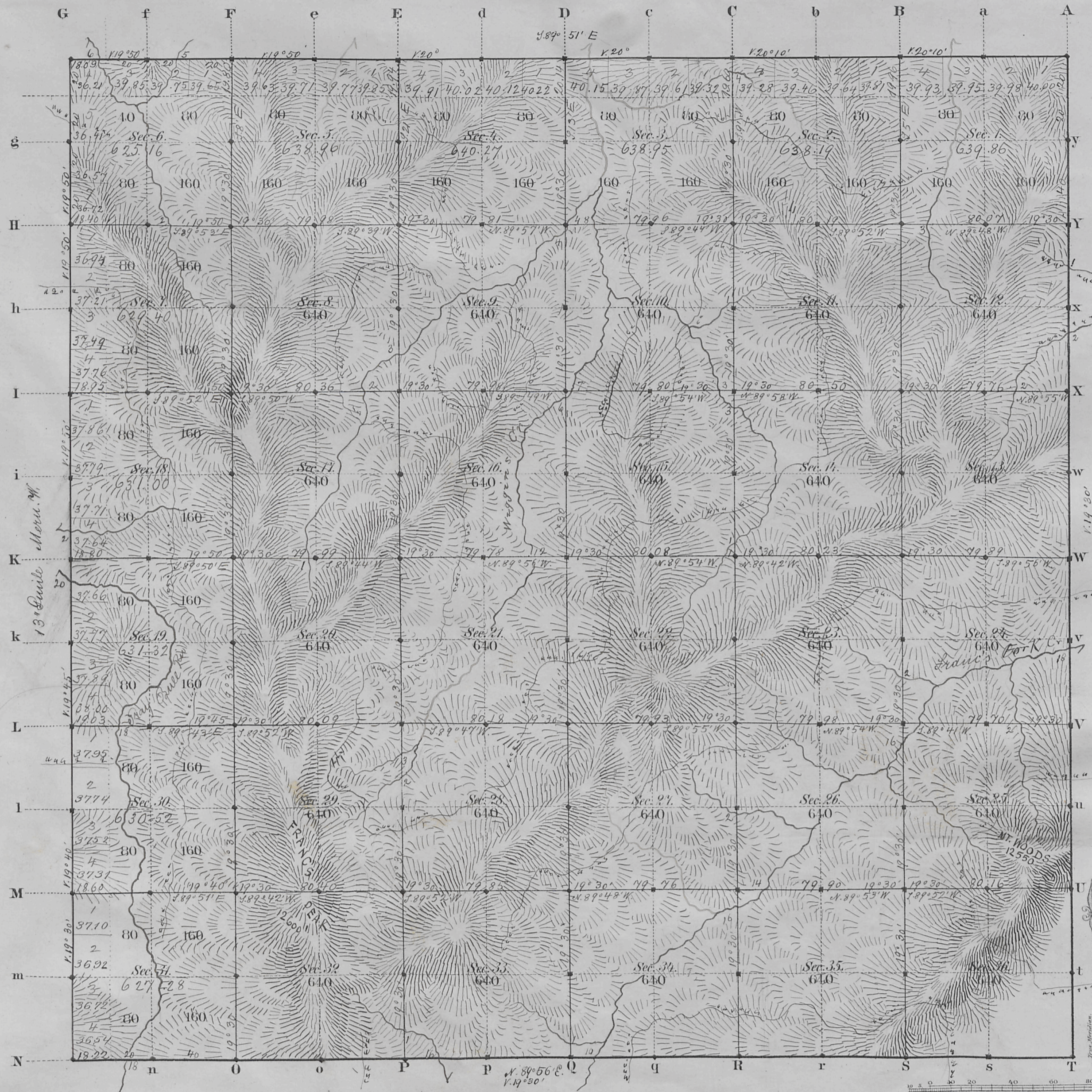

Total number of Acres. 22,970.91

Surveys Designated	By Whom Surveyed	Date of Contract	Amount of Surveys M ² Ch ² L ²	When Surveyed	Magnetic Declination
S. & C. Township lines	N. P. Burnham	July 10, 1882	11 78 22	March 27, 1883	19° 30' East
Subdivisions	W. H. Overton	July 27, 1882	59 73 55	Sept 1-3, 1883	19° 30' "
Connections	"	"	"	"	"
N. Burnham & Co.	"	"	5 78	09 Aug. 20, 1883	"
13 th Quad. N. W.	"	"	6 10 10	March 8, 1883	"

The above Map of Township No 47 North Range No 104 West of the Sixth Principal Meridian Wyoming Territory is strictly conformable to the field notes of the survey thereof on file in this Office, which have been examined and approved

Surveyor General's Office, Edw. C. Davis Supt. Gen.

Cheyenne Wyoming
March 29th 1884

2148

Indexed

Accession no. 3675

EXTERIOR LINES.

Scale 3 miles to 1 inch Magnetic Var. East.

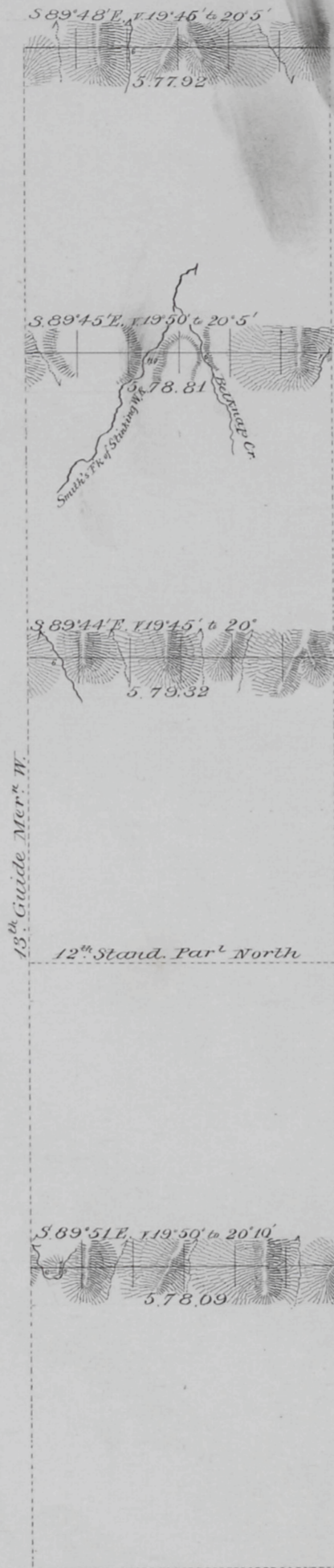

T. 51N.

T. 50N.

T. 49N.

T. 47N.

R. 104W.

Surveys Designated.	By Whom Surveyed.	Date of Contract.	Amount of Surveys			When Surveyed.
			Secs.	Twp.	R.	
Exterior lines	W.H. Proctor	July 22, 1882	23	74	14	Aug. 20-29, 1883

I hereby certify that the above diagram of the Exterior lines of Tps 47, 49, 50 & 51 N. R. 104 W. of the 6th P.M. Wyoming Territory is strictly conformable to the field notes of the survey thereof on file in this office, which have been examined and approved.

Surveyor General's Office,
Cheyenne Wyoming March 29th 1884

Edw. C. David Sur. Gen^l

(25)
Indexed

3253

EXTERIOR LINES.

Scale 3 miles to 1 inch Magnetic Variation, East.

pd
KB
E

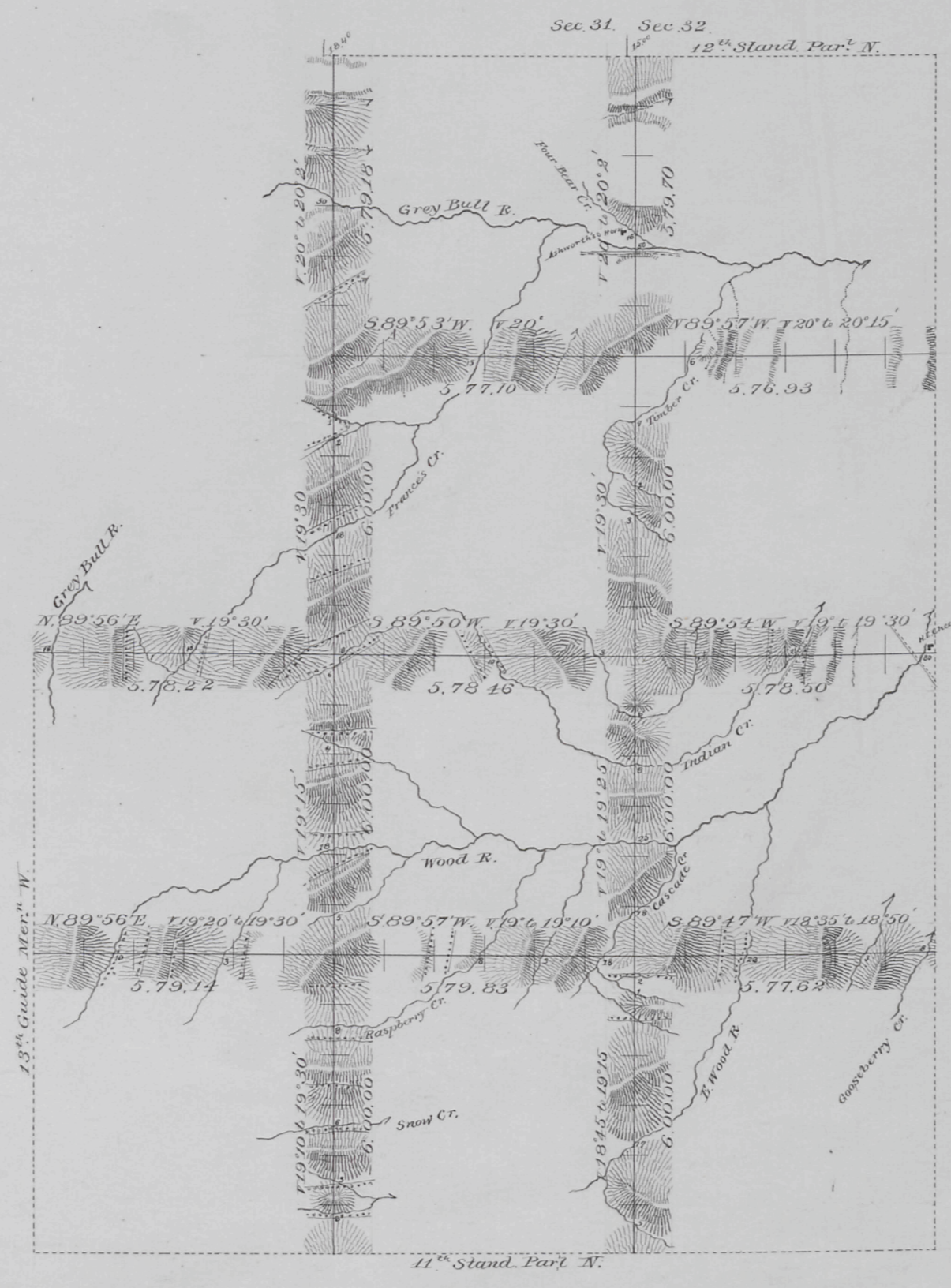

T. 48N.

T. 47N.

T. 46N.

T. 45N.

R. 104W.

R. 103W.

R. 102W.

Surveys Designated.	By Whom Surveyed	Date of Contract.	Amount of Surveys			When Surveyed.
			secs	cts	lks	
Exterior lines	N.J. Burnham	July 10 th 1882	95	64	68	March 12-29 1883
Connections	"	"	33	40	"	"

I hereby certify that the above diagram of the Exterior lines of Townships 45, 46, 47 & 48 N., R's 102 & 103 W., and Tps 45 & 46 N., R. 104 W. of the 6th P.M. Wyo. Ter. is strictly conformable to the field notes of the survey thereof on file in this office, which have been examined and approved.

Surveyor General's Office,
Cheyenne Wyoming February 23 1884
Edw. C. Davis
Surveyor General

(25)
Index

3251

13TH GUIDE MERIDIAN WEST.

Along the West Bound^{ry} of Townships 45, 46, 47 & 48 North Range 104 West of the 6th Prin. Mer. Wyoming Ter.

Mag. Var. East.

Scale 40 Chains to 1 inch.

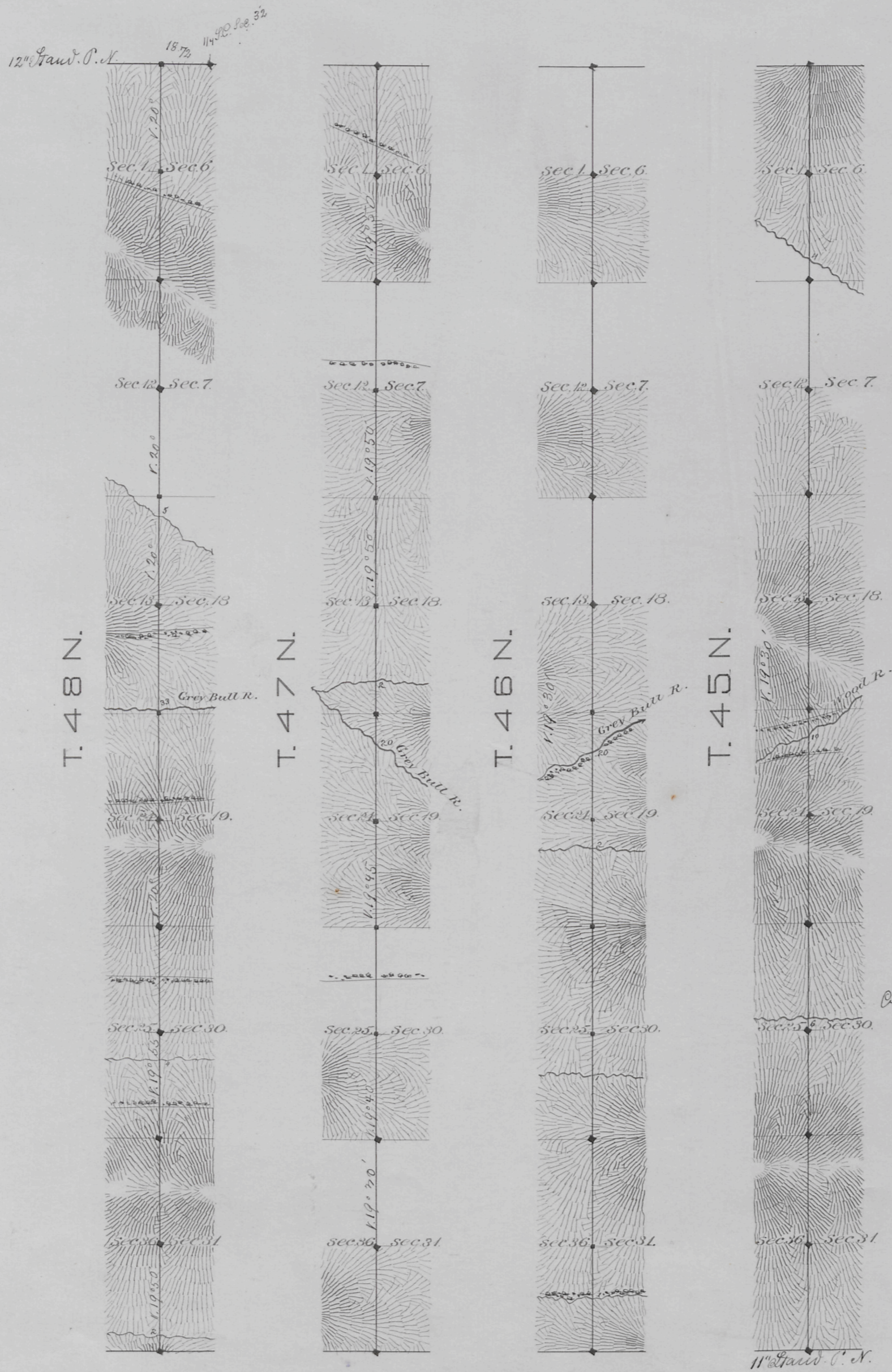

Surveys Designated By Whom Surveyed	Date of Contract	Amount of Surveys			When Surveyed.
		M ^{rs}	C ^{hs}	L ^{ts}	
13 th Guide Mer. W. N. J. Burnham	July 10, 1882	24	0	0	M ^{rs} 7-9, 1883

I hereby certify that the above diagram of the 13th Guide Mer^{idian} West of the 6th Prin. Mer. Wyo. Ter. along the West Bound^{ry} of Tps. 45, 46, 47, 48 North Range 104, is strictly conformable to the field notes of the survey thereof on file in this Office, which have been examined and approved.

Surveyor Gen^l Office
Cheyenne, Wyo. Feb. 23, 1884

Edw. C. David
Sur^{veyor} Gen^l