

T. 47 N., R. 105 W., Sixth Principal Meridian, Wyoming, Field Note Links

Plat Accession Number(s)	Year(s) of Survey	Township Subdivision Plats
3251	1883	https://www.wy.blm.gov/cadastral/countyplats/fremont/fieldnotes/ext3251.pdf
		Yellowstone National Park Boundary
5963	1893	https://www.wy.blm.gov/cadastral/countyplats/fremont/fieldnotes/ynp_0013fn.pdf

DIAGRAM
OF THE
N.E. & S. BOUNDARIES
OF THE
PUBLIC FOREST RESERVATION
AND THE
FRAC.E. BOUNDARY
OF THE
YELLOWSTONE NATIONAL PARK
IN
WYOMING

As surveyed by Philip M. Gallaher U.S. Deputy Surveyor Aug. 3rd to Oct. 22nd 1893, under his contract No. 263 dated Oct. 17, 1894.

Scale 1/2 in = 1 mile
 O indicates corners established
 + indicates proper points for corners but not established

I certify that the above diagram of the N.E. & S. Boundaries of the Public Forest Reservation and the Frac.E. Boundary of the Yellowstone National Park in Wyoming, is strictly conformable to the field notes of the survey thereof on file in this office which have been examined and approved.

U.S. Sur. Gen's Office
 Helena Mont July 17, 1894.

Joseph H. Weil
 Sur. Gen.
 for Montana

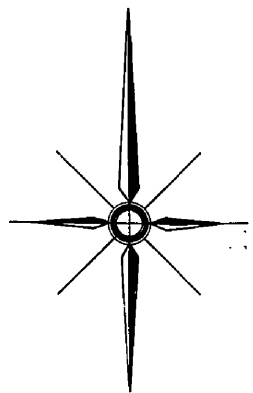

YELLOWSTONE NATIONAL PARK

YELLOWSTONE LAKE

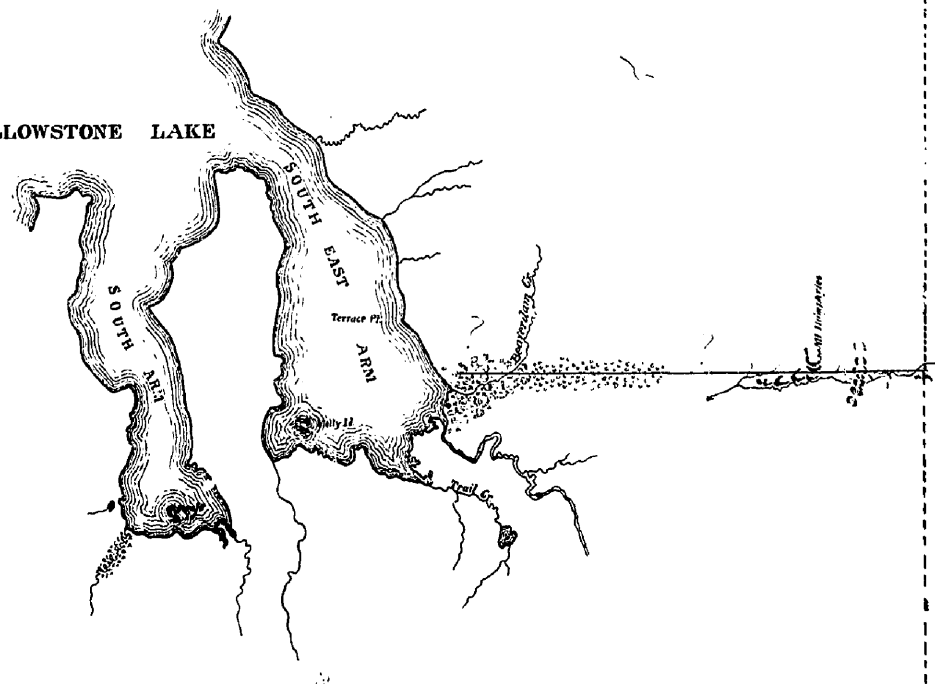

South Boundary Yellowstone National Park

PUBLIC

W Y O M I N G

RESERVATION

FOREST

13
 I D A H O
 W
 Y
 O
 M
 I
 N
 G

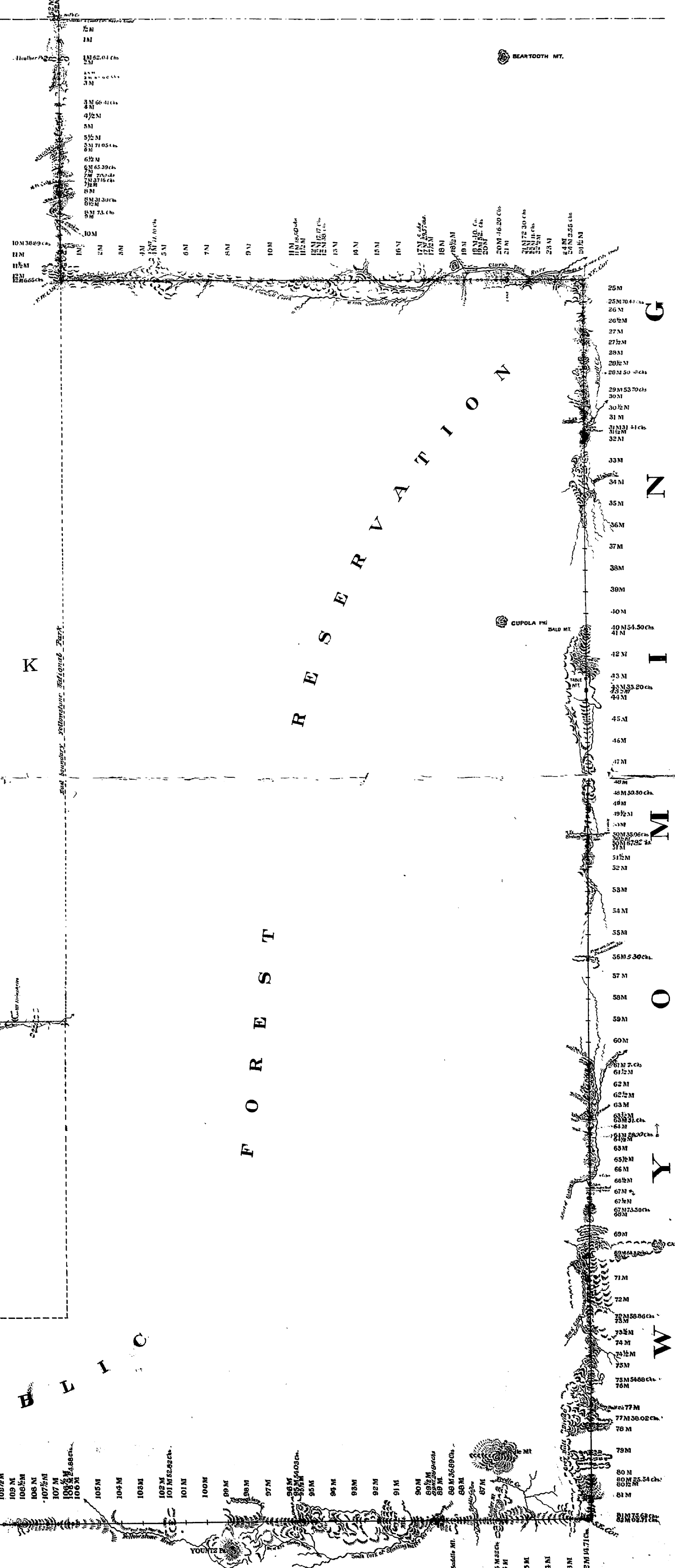

(25)
Index

3251

13TH GUIDE MERIDIAN WEST.

Along the West Bound^{ry} of Townships 45, 46, 47 & 48 North Range 104 West of the 6th Prin. Mer. Wyoming Ter.

Mag. Var. East. Scale 40 Chains to 1 inch.

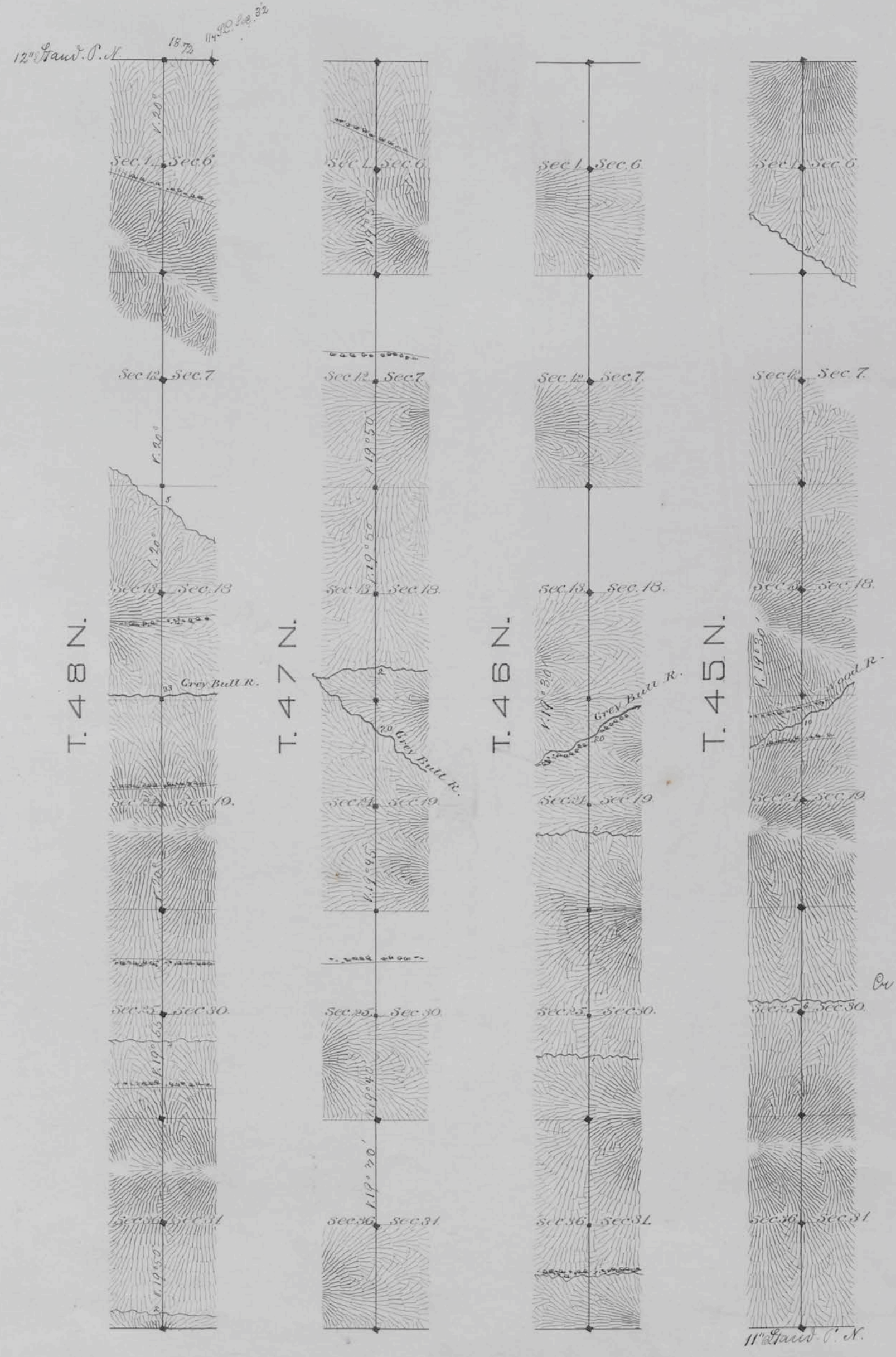

Surveys Designated By Whom Surveyed	Date of Contract	Amount of Surveys		When Surveyed
		Acres	Sq. Rods	
13 th Guide Mer. W. N.J. Burnham	July 10, 1832	24	0	Mar ^{ch} 7-9, 1833

I hereby certify that the above diagram of the 13th Guide Mer^{idian} West of the 6th Prin. Mer. Wyo. Ter. along the West Bound^{ry} of Tps. 45, 46, 47, 48 North Range 104 is strictly conformable to the field notes of the survey thereof on file in this Office, which have been examined and approved.

Surveyor Gen^l Office
Cheyenne, Wyo. Feb. 23, 1834 } Edw. C. David
Sur^{ve} Gen^l