

Yellowstone National Park, North Boundary

Plat Accession Number(s)	Year(s) of Survey	Township Subdivision Plats
-	1931-32	https://www.wy.blm.gov/cadastral/countyplats/park/fieldnotes/ynp_revnbfn_1.pdf
-	1931-32	https://www.wy.blm.gov/cadastral/countyplats/park/fieldnotes/ynp_revnbfn_2.pdf
-	1923	https://www.wy.blm.gov/cadastral/countyplats/park/fieldnotes/t58nr109w_gp233fn_MT.pdf
5953	1903	https://www.wy.blm.gov/cadastral/countyplats/park/fieldnotes/ynp_0003fn.pdf
5952	1901	https://www.wy.blm.gov/cadastral/countyplats/park/fieldnotes/ynp_0002fn.pdf
5952	1897	https://www.wy.blm.gov/cadastral/countyplats/park/fieldnotes/ynp_nbfn.pdf
-	1882	https://www.wy.blm.gov/cadastral/countyplats/crook/fieldnotes/nb_exam.pdf
5965	1879-80	https://www.wy.blm.gov/cadastral/countyplats/park/fieldnotes/nb_mp50-99.pdf
5964	1879-80	https://www.wy.blm.gov/cadastral/countyplats/park/fieldnotes/nb_mp1-49.pdf

North Bdy. Yellowstone N.P.

measured length 4246.56

measured length N. Bdy. of Wyo. within park = 4246.56chs.

North Bdy. Wyoming

	COURSE		DISTANCE	LATITUDES		DEPARTURES	
				N.	S.	E.	W.
E	Bdy	South	4814.54		4814.54		
S	"	West	4163.41				4163.41
W	"	North	4785.44	4785.44			
N	"	East	4246.56			4246.56	
	convergency					approx. 48.00	
				4785.44	4814.54	4294.56	4163.41

4785.44 4163.41
Error in lat 29.10 131.15

West Bdy. Yellowstone N.P.

measured length W. Bdy. Wyo. within park 4785.44

West Bdy. Wyoming

M.P. 0

M.P. 277 + 7266

656

51.10chs.
M.P. 53
M.C. 52

This intersection determined by Lyman, Mont. office in 1923 verified by Bandy 1932

Revised bdy. sur'd of Park in Wyo. = 48,14.54chs.

67,010 Acres

by W. R. Bandy 1932

32,341 Acs.

16,076 Ac.

Measured length orig. east bdy.

ORIG. East Bdy Yellowstone N.P.

Orig. park area in Wyo. by calculation 1,989,049.44 Acs.
addition on E. 67,009.88
2,056,059.32
Sum of 2 exclusions on E. 48,416.62
2,007,642.70

Mont. calc. on NE 2449.2
additions } on NW 26,004.7
 } on N 6,112.7
orig. on N. 63,292.6
" " W. 50,817.0
Ida. orig. 35,783.6

Measured length S. Bdy of park in Wyo. = 4163.41 chs.

65.02

625.02 W E 3538.39chs.

INITIAL PT.

South Bdy. Yellowstone Park

603.44chs
M.P. 74
M.P. 74

INITIAL POINT

This connection determined by Maxwell, Idaho office in 1928 verified by Lonhart Wyo. office in 1939

M.P. 7
M.P. 218

TOWNSHIP No 8 SOUTH, RANGE No 5 EAST, OF THE PRINCIPAL MERIDIAN, MONTANA.
SUPPLEMENTAL PLAT SHOWING REVISED BOUNDARY OF YELLOWSTONE NATIONAL PARK

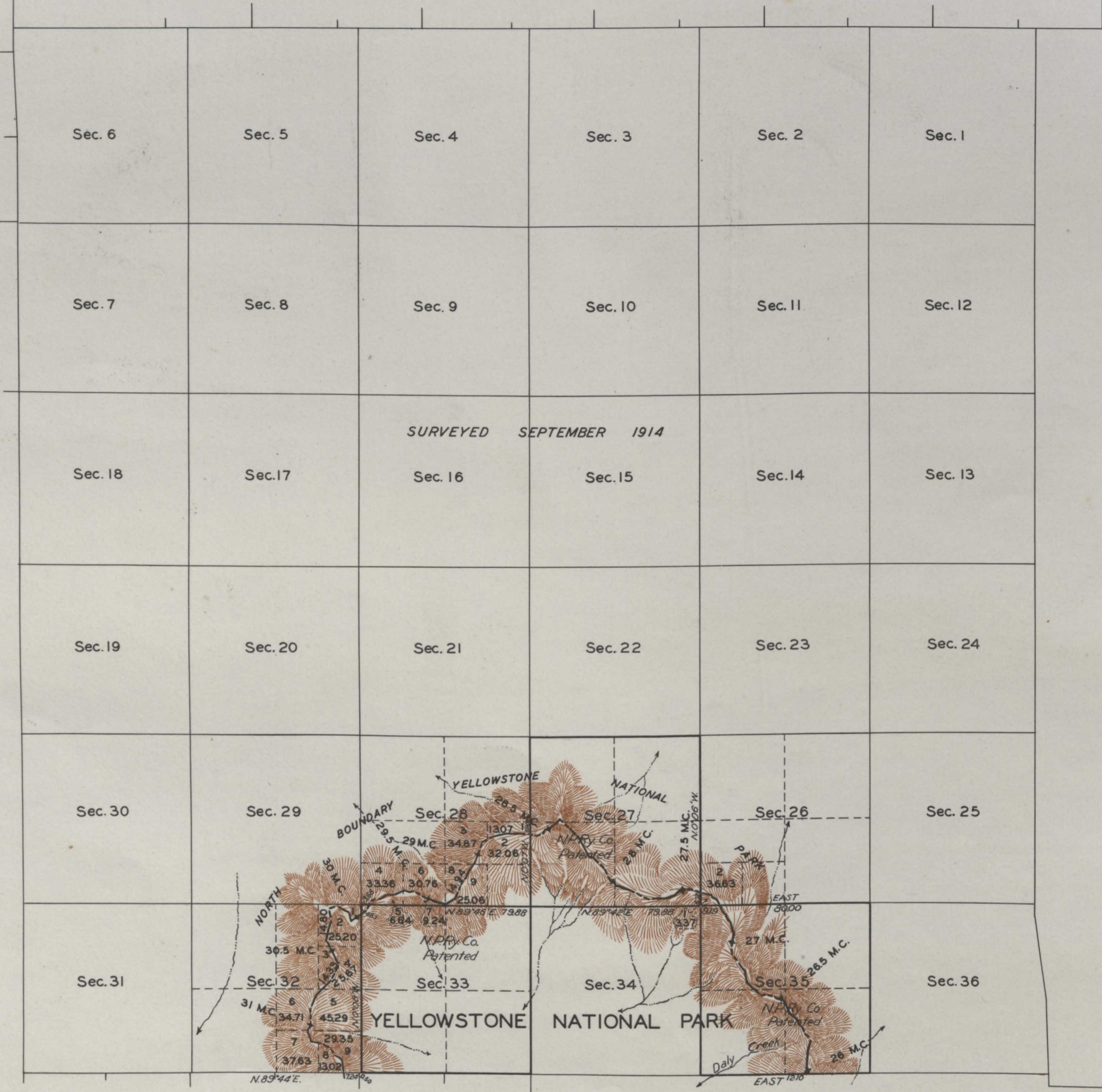

0 5 10 20 40 80
SCALE: 40 CHAINS TO AN INCH.

Survey of the revised boundaries of Yellowstone National Park, as defined by the Act of Congress approved March 1, 1929 and connecting lines, deriving lottings of fractional areas created thereby, executed by W^o R Bandy U.S. Cadastral Engineer, June and July 1931, under special instructions from the U.S. Supervisor of Surveys, Denver Colorado, dated April 14, 1931 for the survey of Yellowstone Park Boundaries.

OFFICE OF U.S. SUPERVISOR OF SURVEYS

Denver, Colorado, June 22, 1933.

The above supplemental plat showing a portion of the revised boundary of Yellowstone National Park in Township No. 8 South, Range No. 5 East, of the Principal Meridian, Montana is strictly conformable to the field notes of the survey thereof which have been examined and approved.

Wm. R. Bandy
U.S. SUPERVISOR OF SURVEYS

DEPARTMENT OF THE INTERIOR
GENERAL LAND OFFICE

Washington D.C. April 10, 1934.

The survey represented by this plat having been correctly executed in accordance with the requirements of law and the regulations of this office, is hereby accepted.

W. R. Bandy
ACTING ASSISTANT COMMISSIONER

G.F.T.
Ex. H.J.G.

5282-A

T 8 S R 5 E

W. R. Bandy
30

TOWNSHIP N^o 9 SOUTH, RANGE N^o 6 EAST, OF THE PRINCIPAL MERIDIAN, MONTANA.
SUPPLEMENTAL PLAT SHOWING REVISED BOUNDARY OF YELLOWSTONE NATIONAL PARK

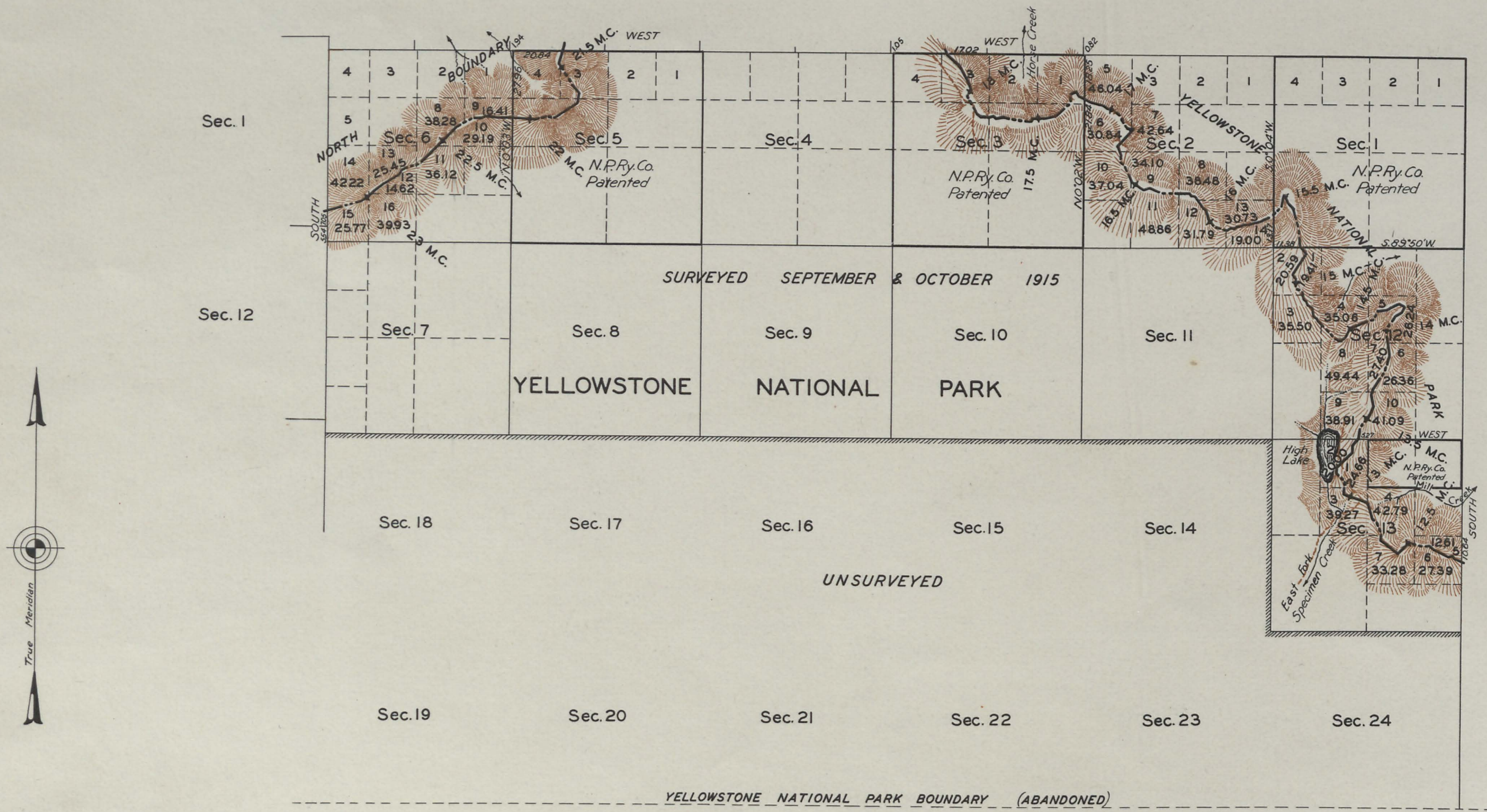

SCALE: 40 CHAINS TO AN INCH

Survey of the revised boundaries of Yellowstone National Park as defined by the Act of Congress approved March 1, 1929 and connecting lines, deriving lottings of fractional areas created thereby, executed by W^m R Bandy U.S. Cadastral Engineer, June and July 1931, under special instructions from the U.S. Supervisor of Surveys, Denver Colorado, dated April 14, 1931 for the survey of Yellowstone Park Boundaries.

OFFICE OF U.S. SUPERVISOR OF SURVEYS
Denver, Colorado, June 22, 1933

The above supplemental plat showing a portion of the revised boundary of Yellowstone National Park in Township No. 9 South, Range No. 6 East, of the Principal Meridian, Montana is strictly conformable to the field notes of the survey thereof which has been examined and approved.

Wm R Bandy
U.S. SUPERVISOR OF SURVEYS

DEPARTMENT OF THE INTERIOR
GENERAL LAND OFFICE

Washington D.C. April 10, 1934
The survey represented by this plat having been correctly executed in accordance with the requirements of law and the regulations of this office is hereby accepted.

Wm R Bandy
ACTING ASSISTANT COMMISSIONER

G.F.T.
Ex. H.J.G.

5211-A

T 9 S R 6 E

TOWNSHIP N^o 9 SOUTH, RANGE N^o 5 EAST, OF THE PRINCIPAL MERIDIAN, MONTANA.
SUPPLEMENTAL PLAT SHOWING REVISED BOUNDARY OF YELLOWSTONE NATIONAL PARK



Tracts "A" "B" and "C" in Secs. 21 and 28 refer to Exchange Survey No 1243 Montana.

SCALE: 40 CHAINS TO AN INCH

Survey of the revised boundaries of Yellowstone National Park, as defined by the Act of Congress approved March 1, 1929 and connecting lines, deriving lottings of fractional areas created thereby, executed by W^o. R. Bandy U.S. Cadastral Engineer, June and July 1931, under special instructions from the U.S. Supervisor of Surveys, Denver Colorado, dated April 14, 1931 for the survey of Yellowstone Park Boundaries.

OFFICE OF U. S. SUPERVISOR OF SURVEYS
Denver, Colorado, June 22, 1933.
The above supplemental plat showing a portion of the revised boundary of Yellowstone National Park in Township No. 9 South, Range No. 5 East, of the Principal Meridian, Montana is strictly conformable to the field notes of the survey thereof which have been examined and approved
[Signature]
U.S. SUPERVISOR OF SURVEYS

DEPARTMENT OF THE INTERIOR
GENERAL LAND OFFICE
Washington D. C. April 10, 1934.
The survey represented by this plat having been correctly executed in accordance with the requirements of law and the regulations of this office is hereby accepted.
[Signature]
ACTING ASSISTANT COMMISSIONER

G.F.T.
Ex.H.J.G.

2876-A

T 9 S R 5 E

[Handwritten initials]

PLAT

of fractional East and North Boundaries
of the

YELLOWSTONE NATIONAL PARK

Surveyed by J. Scott Harrison, Examiner of Surveys, Sept. 24 - Oct. 7, 1903,
under his instructions from Com. Civil Land Office, dated Sept. 11, 1903.

Scale: 1 inch = 1 Mile.

RECEIVED S. G. O.
JUN 10 1904
CHEYENNE, WYO.

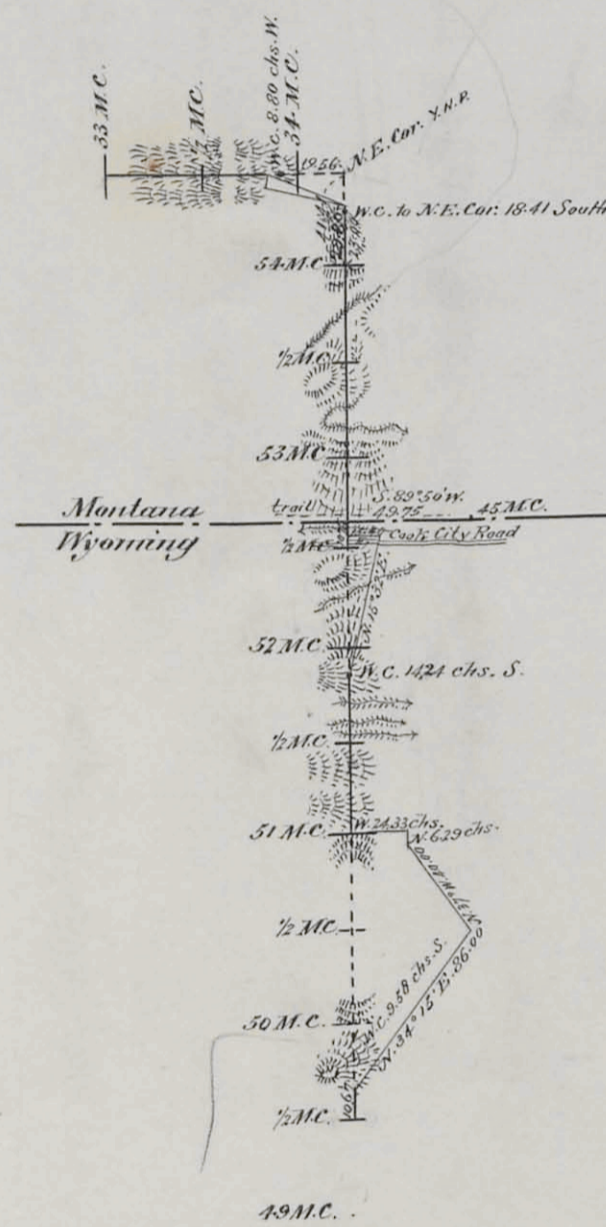

Department of the Interior,
General Land Office.
Washington, D.C., June 6, 1904.

The above plat of the fractional East Boundary of the Yellowstone National Park,
from the Fiftieth Mile Corner to the North East Corner; and the completion of the North
Boundary from the 33 mile Monument to the North East Corner, is strictly conformable
to the field notes of the survey thereof on file in this office, which have been examined
and approved.

J.S.H.

J. H. Finckle
Acting Commissioner.

NORTH BOUNDARY of the Yellowstone National Park Surveyed by Edward F. Stahl

Scale: 1 inch = 1 mile

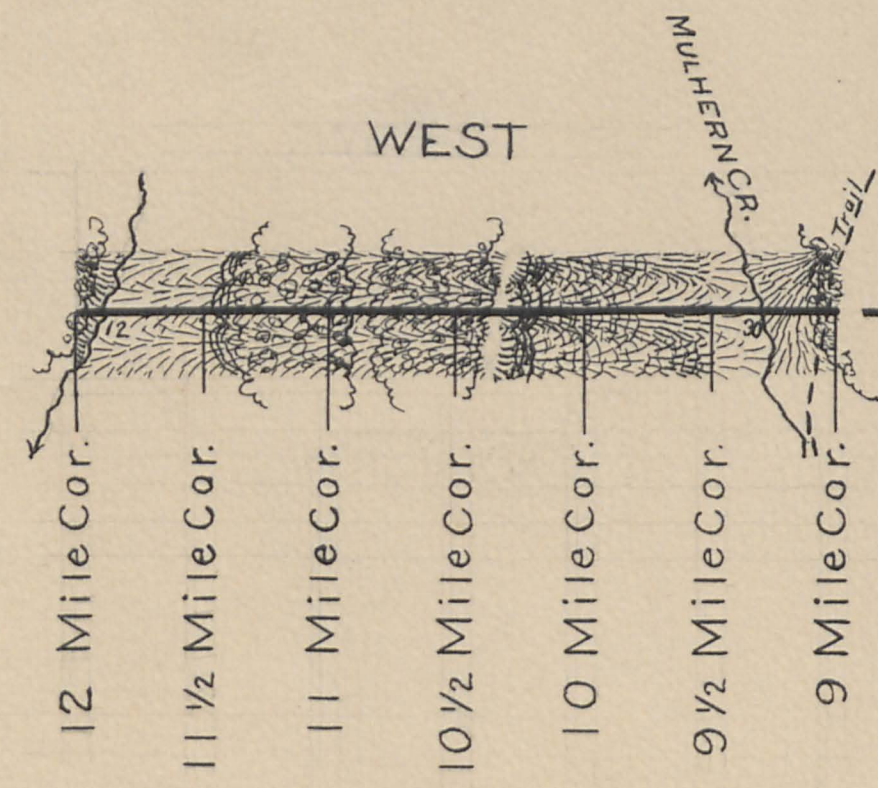
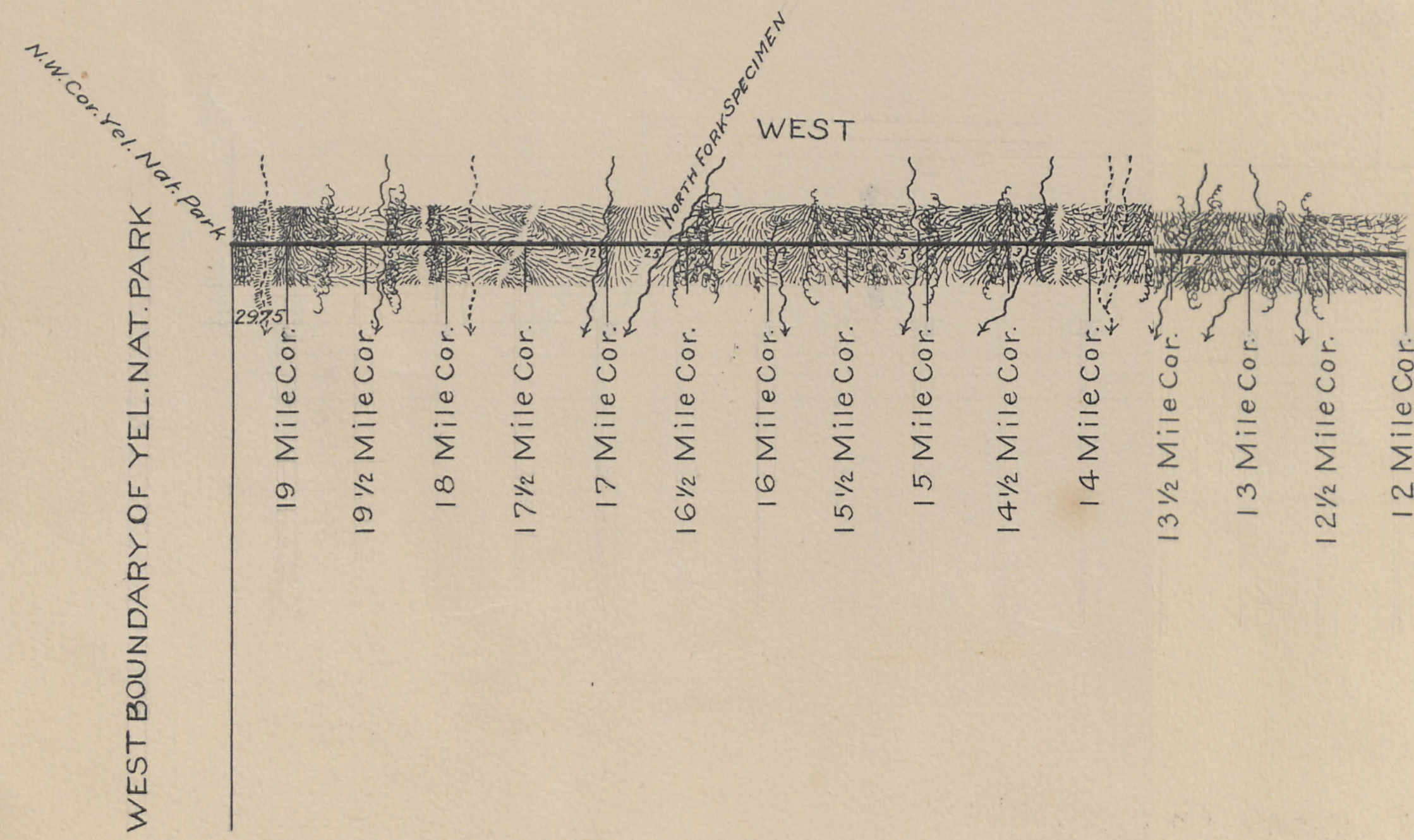

Surveyed by J. Milton Fowble in 1897

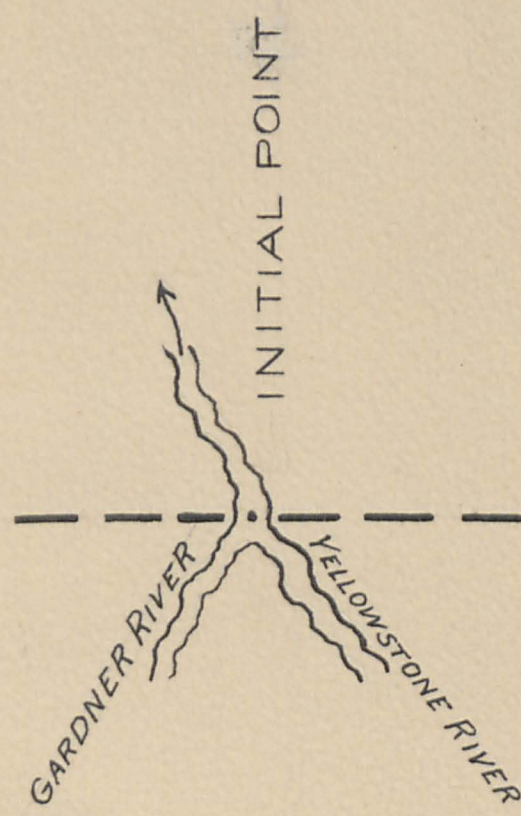

Surveyed by T. Milton Fowble in 1897

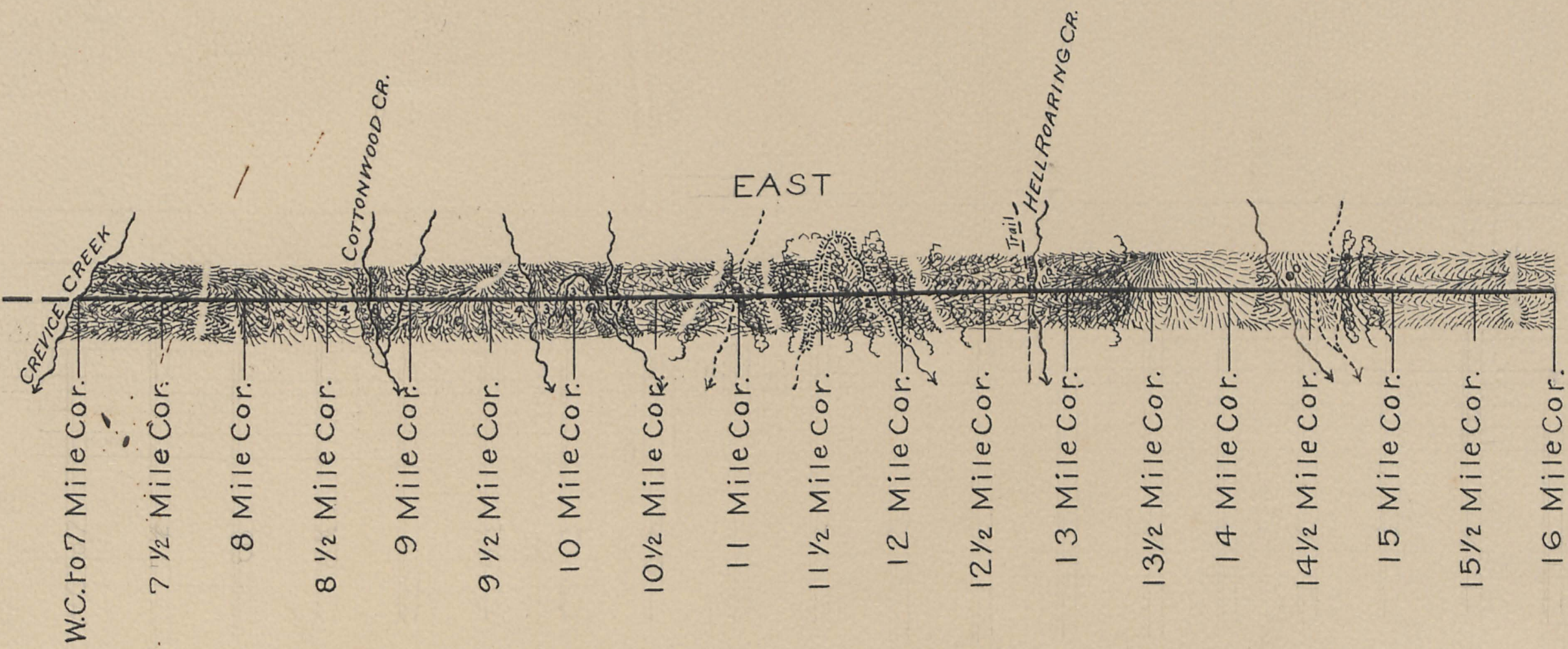

AWS.

U.S. General Land Office,
Washington, D.C., Oct. 18, 1902.

This Plat of the North Boundary of the Yellowstone National Park, is strictly conformable to the field notes of survey thereof by E. F. Stahl, U.S. Surveyor, under his contract dated April 14, 1901, and instructions dated August 16, 1901, which field notes have been approved and filed in this office.

Dunge Hermann
Commissioner.

RECEIVED S. G. O.
OCT 30 1902
CHEYENNE, WYO.

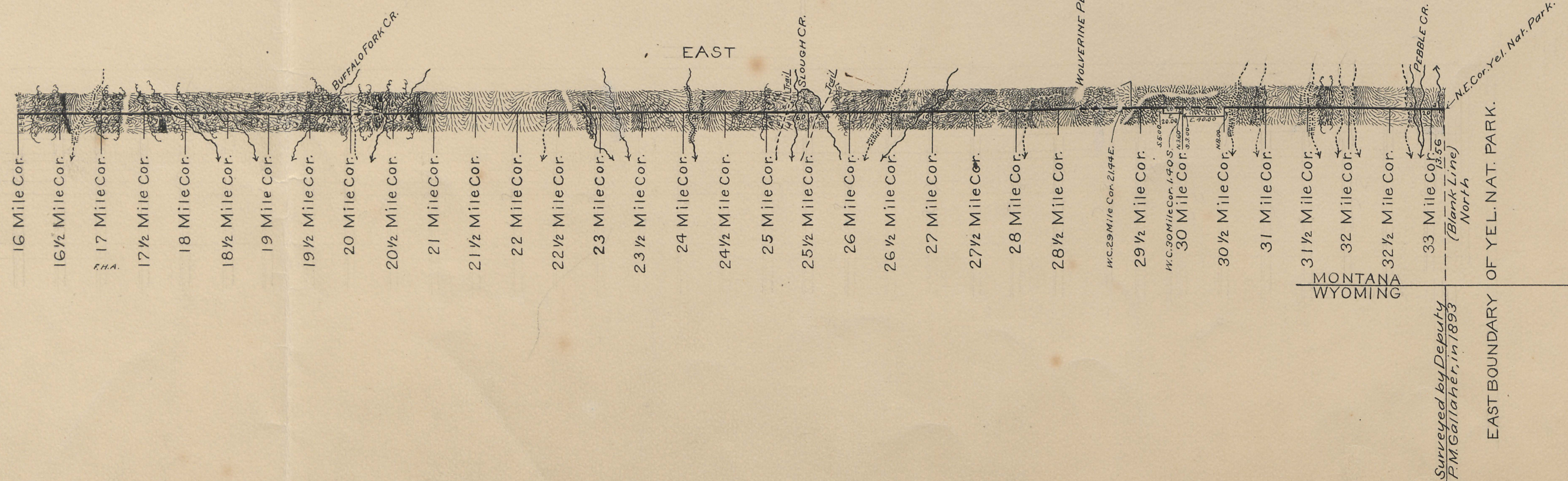

5965

MONTANA



WYOMING

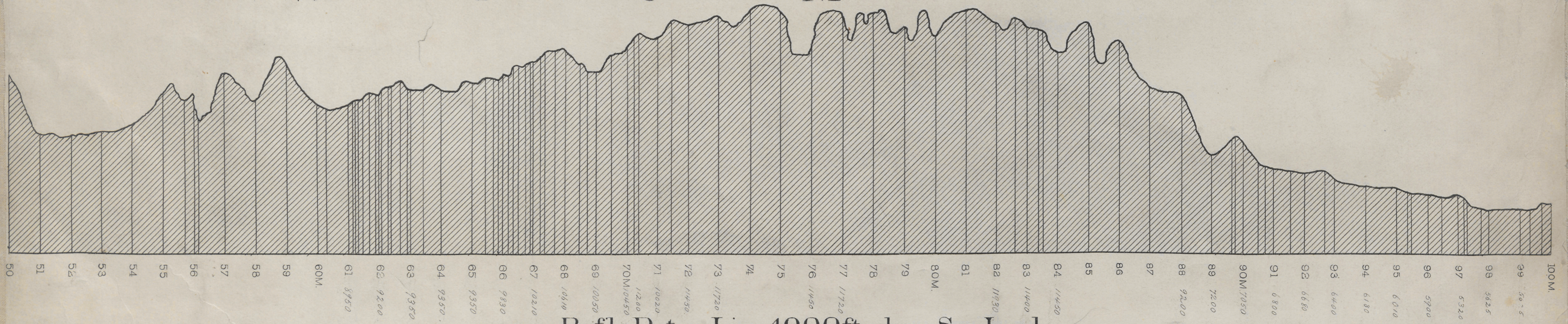

Profile Datum Line 4000ft. above Sea Level.

M O N T A N A

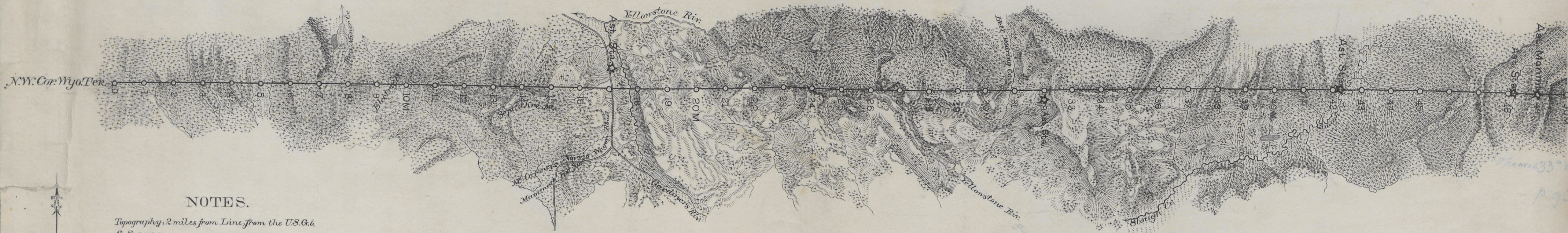

NOTES.

Topography, 2 miles from Line from the U.S. Geol. & Survey.

- Grass is represented thus: [diagonal lines]
- Deciduous trees ,, [cross-hatch]
- Evergreens ,, [stippled]
- Sage Brush ,, [dots]

Scale 2 miles to an inch. *Wyo.*

Vert. 2000 = 1 in.

W Y O M I N G

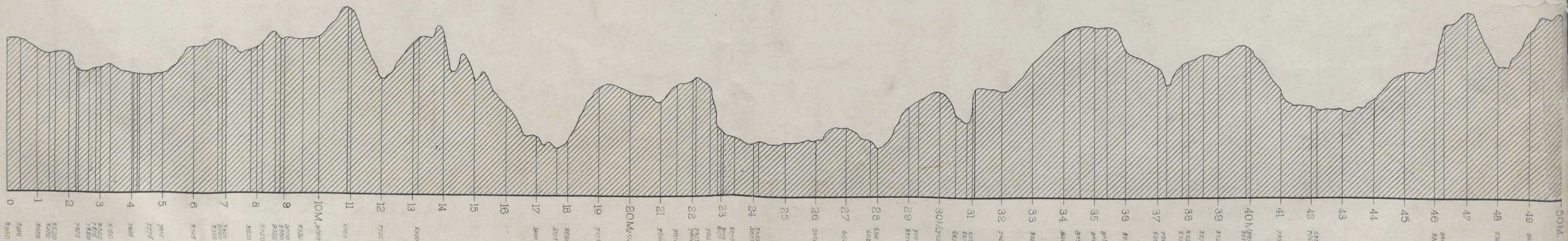

Department of the Interior.
General Land Office.
Washington, D.C. Nov. 2, 1881

Profile Datum Line 4000ft. above Sea Level.

The above Map, comprising Sheets No 1, 2, 3, 4, 5, 6 & 7 of the survey of the Northern Boundary of the Territory of Wyoming, executed by Rollin J. Reeves, U.S. Astronomer & Surveyor, under his contract with the Commissioner of the General Land Office, dated April 18, 1870, having been critically examined, and compared with the field notes of survey as filed in this Office, is hereby approved.

A. C. McFarland
Commissioner