

T. 31 N., R. 114 W., Sixth Principal Meridian, Wyoming, Field Note Links

Plat Accession Number(s)	Year(s) of Survey	
Township Subdivision Plats		
-	1968	https://www.wy.blm.gov/cadastral/countyplats/sublette/fieldnotes/t31nr115w_gp262fn.pdf
4656	1893	https://www.wy.blm.gov/cadastral/countyplats/sublette/fieldnotes/t31nr114w_c253fn.pdf
Township Exterior Plats		
4455	1892	https://www.wy.blm.gov/cadastral/countyplats/sublette/fieldnotes/ext2588.pdf

Township N^o 31 North Range N^o 114 West of the 6th Principal Meridian

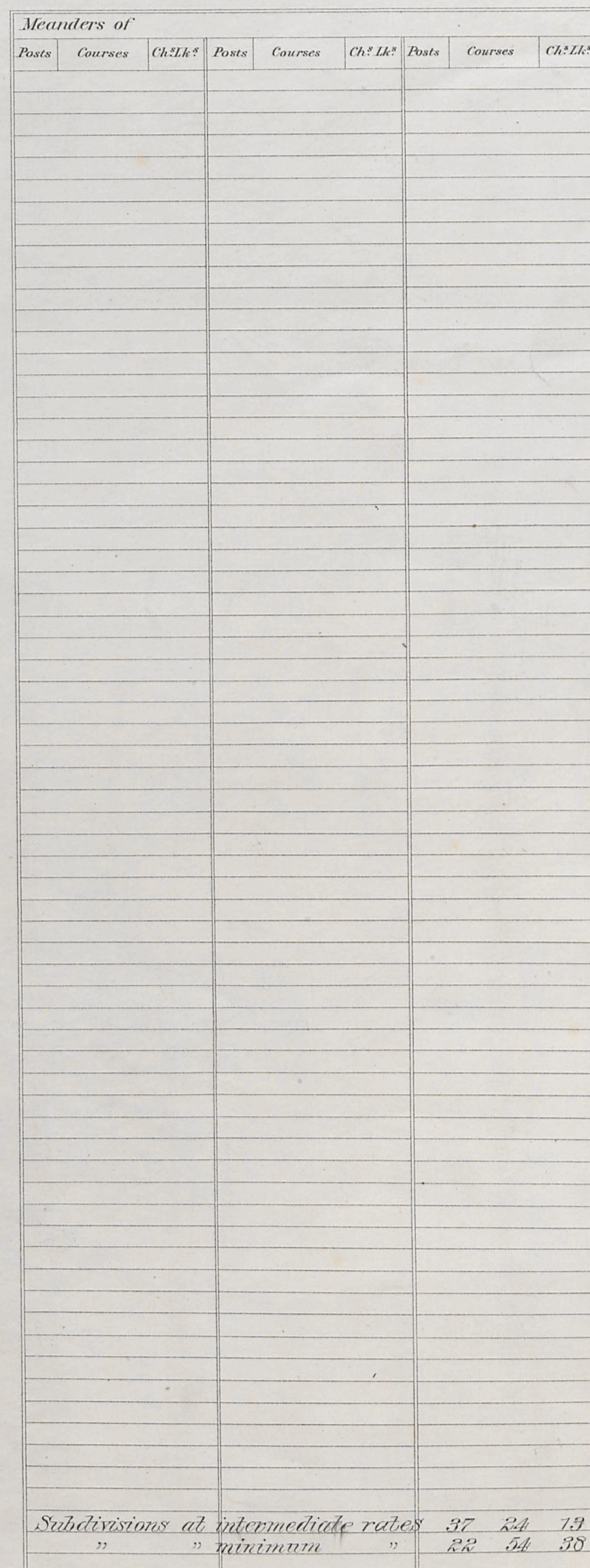

The above Map of Township 1.° 31 North of Range 1.° 114 West of the 6th Principal Meridian, Wyoming, is strictly conformable to the field notes of the survey thereof on file in this Office, which have been examined and approved.

Surveyor General's Office,
Cheyenne June 25 1894

Henry Richardson
Sur. Gen.

TOWNSHIP 31 NORTH, RANGE 114 WEST OF THE SIXTH PRINCIPAL MERIDIAN, WYOMING.

INDEX TO CORNER REMONUMENTATION WITHOUT SURVEY

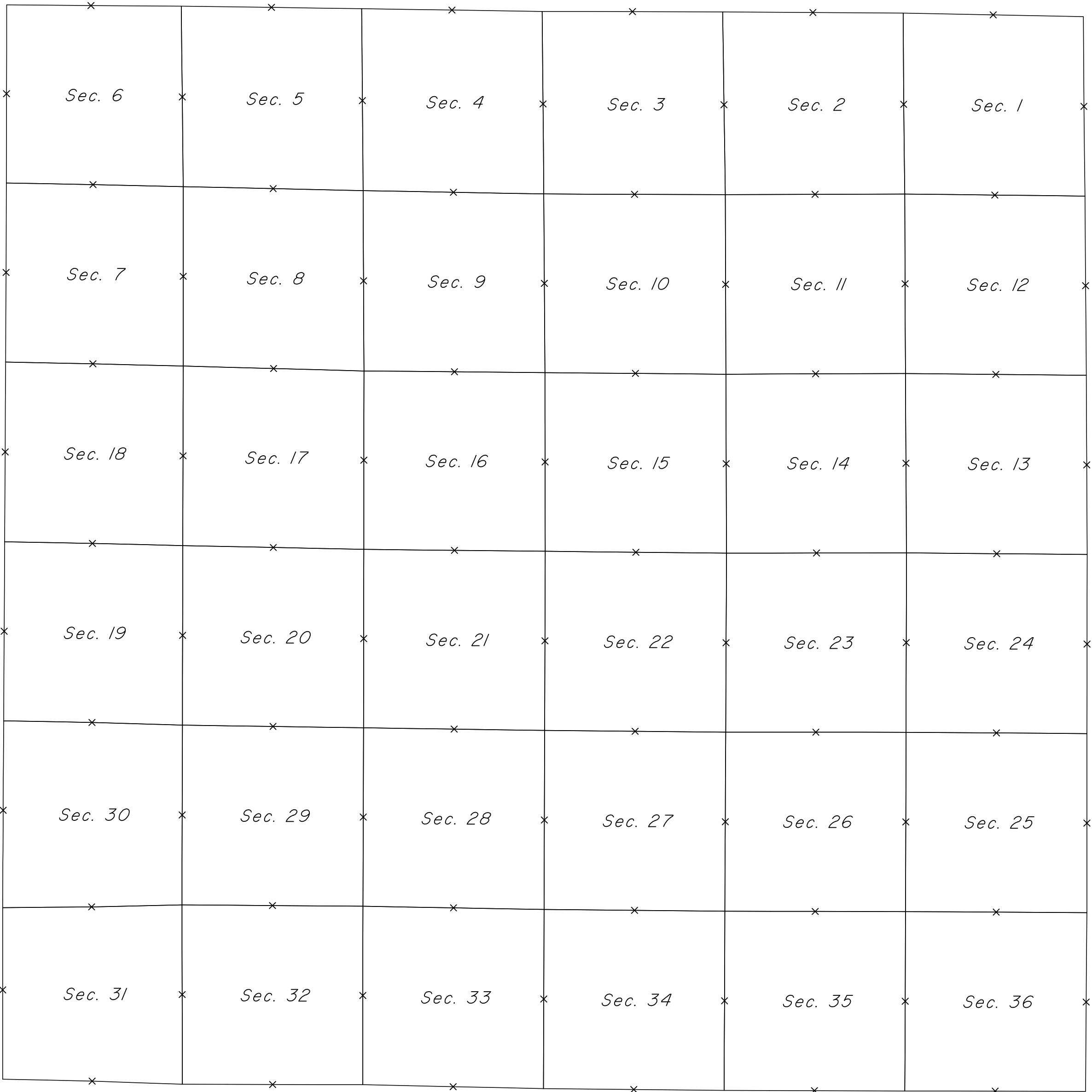
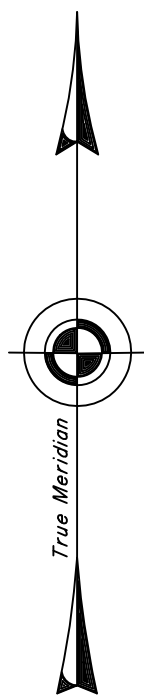

NOT TO SCALE

LEGEND

Remonumented Corner as Indicated

31
Indexed 4455

EXTERIOR LINES.

Scale 2 miles to 1 inch. Magnetic Variation East.

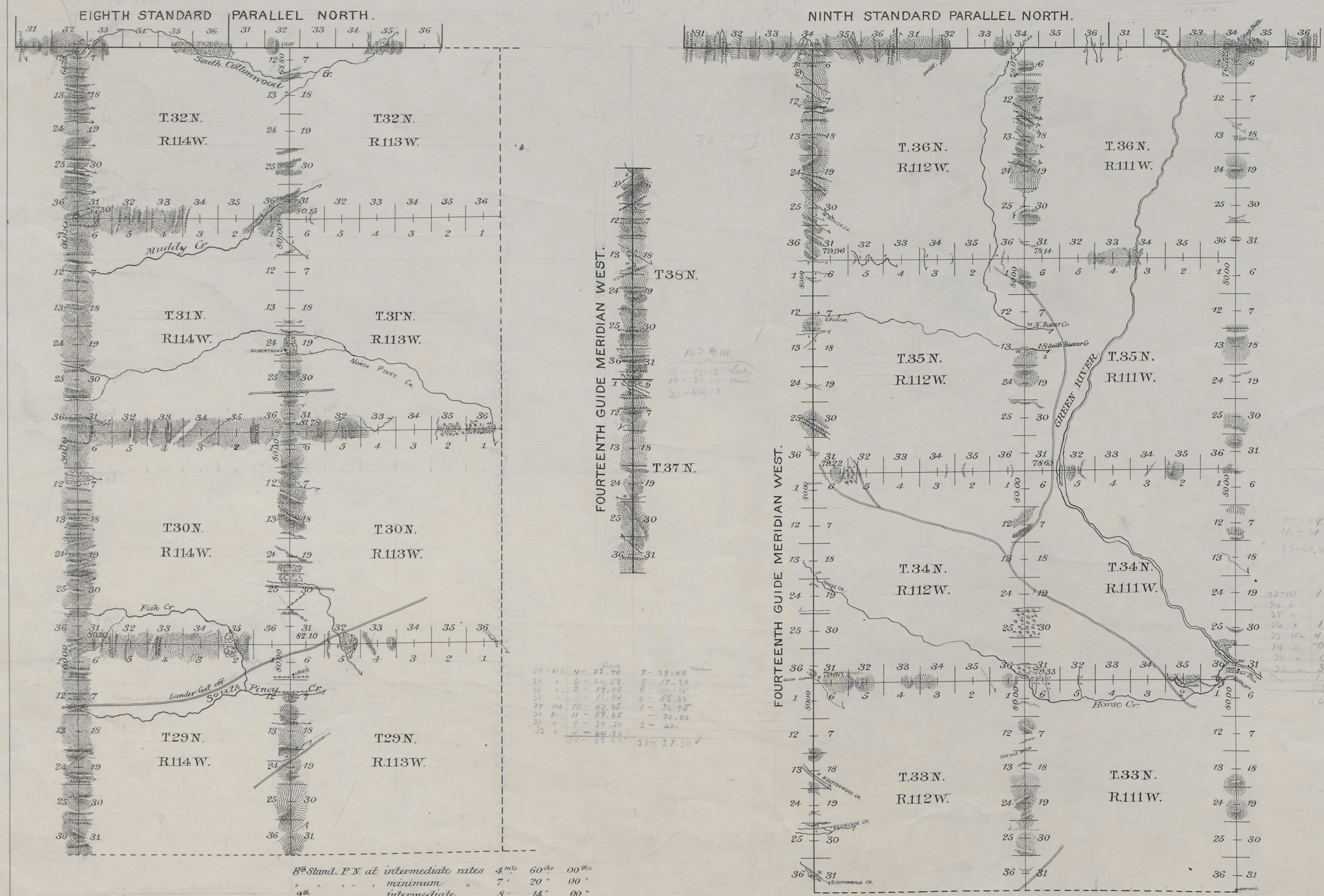

8th Stand. P. N. at intermediate rates 4^m 60^{ch} 00th
" " " minimum " 7 " 20 " 00 "
9th " " " intermediate " 8 " 14 " 00 "
" " " minimum " 9 " 66 " 00 "
14th Guide M. W. intermediate " 16 " 13 " 13 "
" " " minimum " 19 " 31 " 00 "
Township lines " intermediate " 62 " 13 " 68 "
" " " minimum " 103 " 29 " 94 "
Connecting lines at minimum rates 0^m 14^{ch} 96th

Surveys Designated.	By Whom Surveyed.	Date of Contract.	Amount of Surveys.	When Surveyed.	Magnetic Declination.
8th Stand. Par. N.	Shannon & Shannon	Sept 2 ^d 1892	12 00 00	Oct. 3 ^d 1892	17° 55' - 18° 02' East
9th Stand. Par. N.	" "	" "	18 00 00	Sept 30 - Oct 2, 1892	18° 06' - 18° 10' East
14th Guide. Mer. W.	" "	" "	35 4.4 13	Sept 25-30, 1892	17° 54' - 18° 20' East
Township lines	" "	" "	165 4.3 62	Oct 4 - Nov 17, 1892	17° 39' East
Connections.	" "	" "	14 96	" "	" "

I hereby certify that the above diagram of the Exterior lines of Townships 33, 34, 35 and 36 North, Ranges 111 and 112 West, Townships 29, 30, 31 and 32 North, Ranges 113, and 114 West, the 8th and 9th Standard Parallels North and the 14th Guide Meridian, west of the 6th Principal Meridian, Wyoming, is strictly conformable to the field notes of survey thereof on file in this office, which have been examined and approved.
Surveyor General's Office,
Cheyenne, Wyo. April 19, 1893.
N^y A. Richards
U.S. Surveyor General