

T. 41 N., R. 118 W., Sixth Principal Meridian, Wyoming, Field Note Links

Plat Accession Number(s)	Year(s) of Survey	Township Exterior Plats
4587	1892-93	https://www.wy.blm.gov/cadastral/countyplats/teton/fieldnotes/ext2680.pdf

1587
32

EXTERIOR LINES.

Scale 2 miles to 1 inch. Magnetic Variation East.

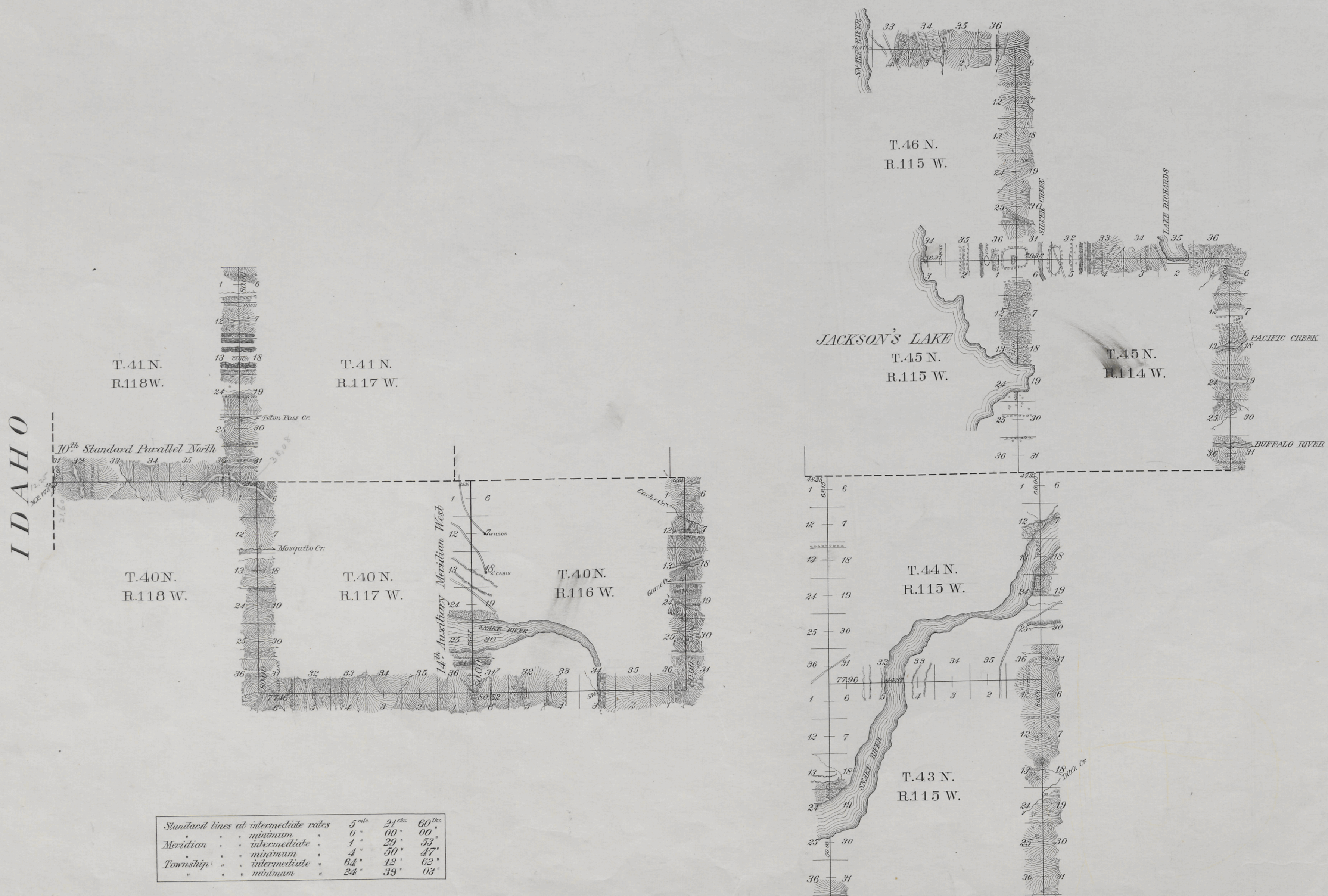

Standard lines at intermediate rates	5 ^{miles}	24 ^{ch}	60 ^{ch}
Meridian . . . minimum	0	00	00
Meridian . . . intermediate	1	29	53
Meridian . . . maximum	4	50	47
Township . . . intermediate	64	12	62
Township . . . minimum	24	39	03

Survey Designated	By Whom Surveyed	Date of Contract	Amount of Surveys Miles	When Surveyed	Magnetic Declination
10 th Stand. Par. N.	W ^m O. Owen	Sept. 2, 1892	5 21 60	Sept. 29-30, 1892	18° 28' East
14 th Guide Mer. W.	" " "	" " "	6 00 00	May 17, 1893	18° 06' "
Township Lines	" " "	" " "	88 11 65	May 18-July 17, 93	18° 00' 18" 24 "

Whereby certify that the above diagram of the Exterior lines of Townships 40 North, Range 116 West, Townships 43, 44 and 46 North, Range 115 West, Townships 40 and 41 North, Range 117 West, Township 45 North, Range 114 West the 10th Standard Parallel North, the 14th Auxiliary Meridian, west of the Principal Meridian, Wyoming, is strictly conformable to the field notes of survey thereof on file in this office, which have been examined and approved.

Surveyor General's Office
Cheyenne Wyo. Aug. 16, 1894.

Henry Richardson
U.S. Surveyor General.