

UNITED STATES
DEPARTMENT OF THE INTERIOR
BUREAU OF LAND MANAGEMENT

FIELD NOTES
OF THE
REMONUMENTATION OF CERTAIN CORNERS
AND THE
DEPENDENT RESURVEY OF
PORTIONS OF THE SUBDIVISIONAL LINES,
TOWNSHIP 6 NORTH, RANGE 6 EAST,
OF THE WIND RIVER MERIDIAN,
IN THE STATE OF WYOMING.

EXECUTED BY

JAMES R. GAMPETRO

CADASTRAL SURVEYOR

Under special instructions dated JUNE 13, 2011, approved JUNE 13, 2011, which provided for the remonumentation of certain corners under Group Number 850, Wyoming, and assignment instructions dated SEPTEMBER 14, 2022, and special instructions dated JUNE 14, 2023, approved JUNE 14, 2023, which provided for the surveys included under Group Number 1084, Wyoming, and assignment instructions dated JUNE 14, 2023.

Survey commenced OCTOBER 10, 2022

Survey completed JULY 5, 2023

INDEX DIAGRAM

Township 6 North, Range 6 East

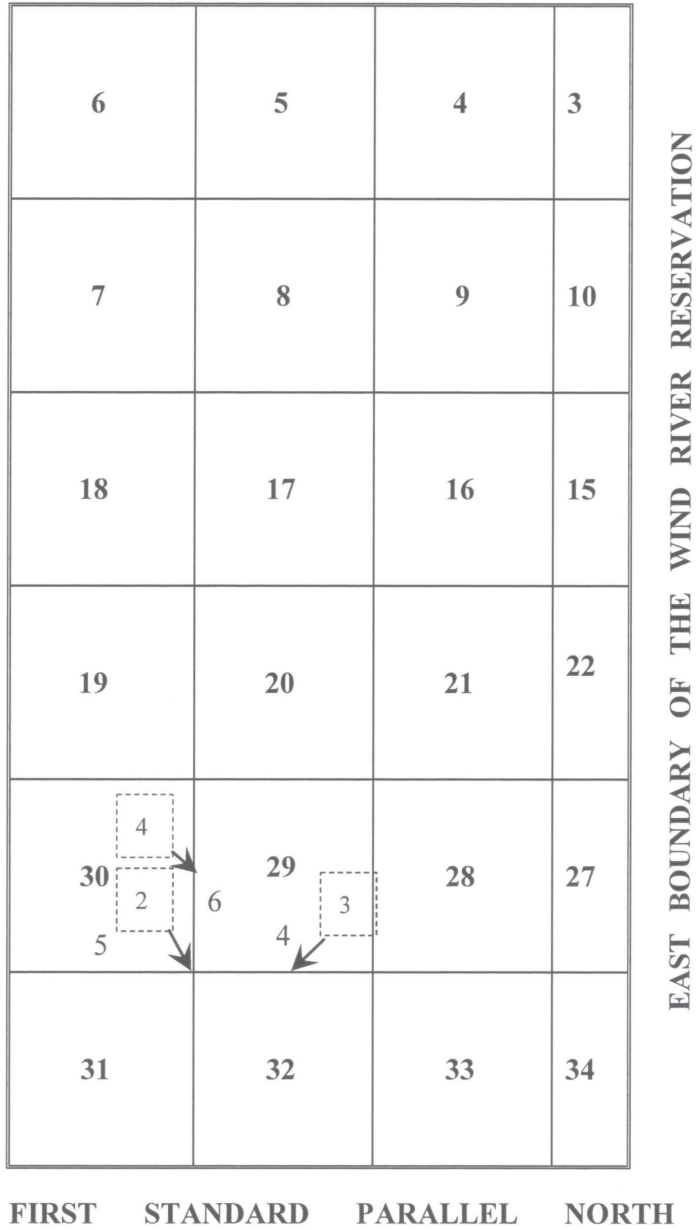

T. 6 N., R. 6 E., Wind River Meridian, Wyoming

<p>Chains</p>	<p>The following field notes are those of the remonumentation of certain corners and the dependent resurvey of portions of the subdivisional lines, Township 6 North, Range 6 East, Wind River Meridian, Wyoming.</p> <p>The history of surveys pertaining to this resurvey is as follows:</p> <p>1905 Goyne Drummond and William L. Horton, U.S. Deputy Surveyors, surveyed the south and west boundaries, and a portion of the subdivisional lines of T. 6 N. R. 6 E.</p> <p>1926 Clyde W. Atherly, Mark D. King, and Kenneth W. Bond, Cadastral Engineers, surveyed a portion of the subdivisional lines of T. 6 N. R. 6 E.</p> <p>The survey was executed in accordance with the specifications as set forth in the Manual of Surveying Instructions, 2009, the special instructions for Group No. 850, Wyoming, dated June 13, 2011, and the special instructions for Group No. 1084, Wyoming, dated June 14, 2023.</p> <p>Preliminary to the resurvey, the lines of the previous surveys were retraced and diligent search was made for all corners and other calls of the field note record. Identified corners were remonumented in their original positions. Lost corners were reestablished and monumented at proportionate positions based on the latest official record, but only after exhausting every possibility of finding direct evidence of such corners. The retracement data were thoroughly verified and only true line field notes are given herein, which refer to the completed survey.</p> <p>The direction and length of all lines were determined by TRIMBLE Model R10-2 and R12 Global Positioning System/Global Navigation Satellite Systems (GPS/GNSS) receivers. Cadastral project control and corner measurements determined during the GPS/GNSS survey achieve the accuracy standards stated in <i>Standards for the Positional Accuracy of Cadastral Surveys Conducted Using Global Navigation Satellite Systems (GNSS)</i>, dated October 2019. The directions of all lines refer to the true meridian and are reported as mean bearings. All reported positions are referenced to the NAD 83(2011) (EPOCH:2010) datum.</p> <p>The following GPS/GNSS project control point was used during this resurvey.</p>
----------------------	--------------------------------------------------------------------------------------------------------------------------------------------------------------------------------------------------------------------------------------------------------------------------------------------------------------------------------------------------------------------------------------------------------------------------------------------------------------------------------------------------------------------------------------------------------------------------------------------------------------------------------------------------------------------------------------------------------------------------------------------------------------------------------------------------------------------------------------------------------------------------------------------------------------------------------------------------------------------------------------------------------------------------------------------------------------------------------------------------------------------------------------------------------------------------------------------------------------------------------------------------------------------------------------------------------------------------------------------------------------------------------------------------------------------------------------------------------------------------------------------------------------------------------------------------------------------------------------------------------------------------------------------------------------------------------------------------------------------------------------------------------------------------------------------------------------------------------------------------------------------------------------------------------------------------------------------------------------------------------------------------------------------------------------------------------------------------------------------------------------------------------------------------------------------------------------------------------------------------------------------------------------

T. 6 N., R. 6 E., Wind River Meridian, Wyoming

Chains															
	<p>BLM 7039:</p> <table border="0" data-bbox="535 436 1282 508"> <thead> <tr> <th data-bbox="535 436 763 472">Latitude</th> <th data-bbox="841 436 1088 472">Longitude</th> <th data-bbox="1136 436 1282 472">HAE</th> </tr> </thead> <tbody> <tr> <td data-bbox="535 472 763 508">43° 27' 32.029" N.</td> <td data-bbox="841 472 1088 508">108° 12' 53.290" W.</td> <td data-bbox="1136 472 1282 508">7177.18 sft.</td> </tr> </tbody> </table> <p>Documentation of this position determination is included in the group file.</p> <p>The geographic position of the following corners, determined from the GPS/GNSS survey, is:</p> <p>The 1/4 sec. cor. of secs. 6 and 31, on the S. bdy. of the Tp.</p> <table border="0" data-bbox="535 745 1088 816"> <thead> <tr> <th data-bbox="535 745 763 781">Latitude</th> <th data-bbox="841 745 1088 781">Longitude</th> </tr> </thead> <tbody> <tr> <td data-bbox="535 781 763 816">43° 26' 42.700" N.</td> <td data-bbox="841 781 1088 816">108° 12' 35.836" W.</td> </tr> </tbody> </table> <p>The 1/4 sec. cor. of secs. 29 and 30.</p> <table border="0" data-bbox="535 886 1088 957"> <thead> <tr> <th data-bbox="535 886 763 921">Latitude</th> <th data-bbox="841 886 1088 921">Longitude</th> </tr> </thead> <tbody> <tr> <td data-bbox="535 921 763 957">43° 28' 00.844" N.</td> <td data-bbox="841 921 1088 957">108° 12' 00.055" W.</td> </tr> </tbody> </table> <p>The magnetic declination was not observed.</p> <hr data-bbox="479 1045 1356 1054"/> <p style="text-align: center;">Re monumentation of Certain Corners, T. 6 N., R. 6 E., Wind River Meridian, Wyoming</p> <hr data-bbox="479 1171 1356 1180"/> <p style="text-align: center;">(Restoring monuments set by Goyne Drummond and William L. Horton in 1905)</p> <hr data-bbox="641 1297 1193 1306"/> <p>The cor. of secs. 29, 30, 31 and 32, monumented with a sandstone, 20 x 12 x 5 ins., firmly set, 12 ins. in the ground, plainly mkd. with 4 grooves on the E. face, no other mks. visible, with a partially embedded mound of stone, W. of cor. Stanton J. Abell Jr., Wyoming Professional Land Surveyor No. 2877, document No. 395394, recorded August 16, 1988, scribed an X on top. This position is on file at the Fremont County Clerk's Office.</p> <p>At the corner point</p> <p>Set a stainless steel post, 28 ins. long, 2½ ins. diam., 20 ins. in the ground, in supporting mound of stone, 2 ft. base, to top, atop a plastic encased magnetic marker, with brass cap mkd.</p>	Latitude	Longitude	HAE	43° 27' 32.029" N.	108° 12' 53.290" W.	7177.18 sft.	Latitude	Longitude	43° 26' 42.700" N.	108° 12' 35.836" W.	Latitude	Longitude	43° 28' 00.844" N.	108° 12' 00.055" W.
Latitude	Longitude	HAE													
43° 27' 32.029" N.	108° 12' 53.290" W.	7177.18 sft.													
Latitude	Longitude														
43° 26' 42.700" N.	108° 12' 35.836" W.														
Latitude	Longitude														
43° 28' 00.844" N.	108° 12' 00.055" W.														

Remonumentation of Certain Corners,
T. 6 N., R. 6 E., Wind River Meridian, Wyoming

Chains	<table style="margin: auto;"> <tr><td></td><td style="text-align: center;">T6N</td><td style="text-align: center;">R6E</td><td></td></tr> <tr><td style="text-align: center;">S 30</td><td style="border-left: 1px solid black; border-right: 1px solid black;"></td><td style="text-align: center;">S 29</td><td></td></tr> <tr><td colspan="4" style="border-top: 1px solid black;"></td></tr> <tr><td style="text-align: center;">S 31</td><td style="border-left: 1px solid black; border-right: 1px solid black;"></td><td style="text-align: center;">S 32</td><td></td></tr> <tr><td colspan="4" style="text-align: center;">2022</td></tr> </table>		T6N	R6E		S 30		S 29						S 31		S 32		2022			
	T6N	R6E																			
S 30		S 29																			
S 31		S 32																			
2022																					
	<p>Bury the mkd. stone and set a steel fence post alongside the stainless steel post.</p> <p>Cor. is located on open, rolling ground.</p> <p>From this point, a position established by person(s) unknown, bears S. 31° 59' W., 5.77 chs. dist., monumented with a sandstone, 12 x 2 ins., loosely set, projecting 8 ins. above the ground, in partially embedded collar of stone, no mks., an iron stake, 1 x 1 x 8 ins. above ground, with steel cap mkd. BISHOP & SPURLOCK ENGRS SURVEY POINT LANDER WY, and steel fence post set alongside. Bradley H. Clow, Wyoming Professional Land Surveyor No. 548, document No. 395394, recorded on February 8, 1993. Mr. Clow erroneously recognized this position as the section cor. This position is not accepted as a careful and faithful perpetuation of the original cor. position.</p> <hr style="width: 50%; margin-left: auto; margin-right: auto;"/> <p>The 1/4 sec. cor. of secs. 29 and 32, monumented with a sandstone, 15 x 12 x 10 ins., firmly set, 8 ins. in the ground, plainly mkd. 1/4 on the N. face, and a X scribed on the top by person(s) unknown, with mound of stone, 2 ft. base, 2 ft. high, N. of cor.</p> <p>At the corner point</p> <p>Set an aluminum post, 28 ins. long, 2½ ins. diam., 9 ins. in the ground to bedrock, mkd. X, in supporting mound of stone, 3½ ft. base, to top, atop a plastic encased magnetic marker, with aluminum cap mkd.</p> <div style="text-align: center;"> <table style="margin: auto;"> <tr><td></td><td style="text-align: center;">T6N</td><td style="text-align: center;">R6E</td><td></td></tr> <tr><td></td><td style="text-align: center;">S 29</td><td></td><td></td></tr> <tr><td style="text-align: center;">1/4</td><td style="border-left: 1px solid black; border-right: 1px solid black;"></td><td></td><td></td></tr> <tr><td></td><td style="text-align: center;">S 32</td><td></td><td></td></tr> <tr><td colspan="4" style="text-align: center;">2022</td></tr> </table> </div> <p>from which</p> <p style="text-align: center;">An X BO chiseled on rock outcrop, bears N. 76° 08' W., 26 lks. dist.</p>		T6N	R6E			S 29			1/4					S 32			2022			
	T6N	R6E																			
	S 29																				
1/4																					
	S 32																				
2022																					

Remonumentation of Certain Corners,
T. 6 N., R. 6 E., Wind River Meridian, Wyoming

Chains	<p>Bury the mkd. stone and set steel fence post alongside the aluminum post.</p> <p>Cor. is located on the N. side of draw draining E., on steep and rocky E. slope, in sparse juniper timber.</p> <p>From this point, U.S. Geological Survey Benchmark CANYON bears S. 72° 20' W., 18.07 chs. dist., monumented with a standard brass tablet, 3½ ins. diam., firmly set, flush with top of limestone boulder, 5 x 5 x 3 ft., mkd. ELEVATION ABOVE SEA FEET, and a triangle.</p> <hr/> <p>The 1/4 sec. cor. of secs. 29 and 30, monumented with a sandstone, 21 x 12 x 3 ins., firmly set, 11 ins. in the ground, plainly mkd. 1/4 on the W. face, with a partially embedded mound of stone W. of cor.</p> <p>At the corner point</p> <p>Set a stainless steel post, 28 ins. long, 2½ ins. diam., 20 ins. in the ground, in a supporting mound of stone, 2 ft. base, to top, atop a plastic encased magnetic marker, with brass cap mkd.</p> <div style="text-align: center;"> <p>T6N R6E 1/4 S 30 S 29 2022</p> </div> <p>Bury the mkd. stone and set steel fence post alongside the stainless steel post.</p> <p>Cor. is located on gentle W. slope, in scattered sagebrush.</p> <hr/> <p style="text-align: center;">Dependent Resurvey of Portions of the Subdivisional Lines, T. 6 N., R. 6 E., Wind River Meridian, Wyoming</p> <hr/> <p style="text-align: center;">(Restoring the survey executed by Goyne Drummond and William L. Horton in 1905)</p> <hr/> <p>Note: Topography calls found as described in the field notes of the 1905 survey are not repeated in these field notes.</p> <p>From the 1/4 sec. cor. of secs. 29 and 32, hereinbefore described.</p>
---------------	----------------------------------------------------------------------------------------------------------------------------------------------------------------------------------------------------------------------------------------------------------------------------------------------------------------------------------------------------------------------------------------------------------------------------------------------------------------------------------------------------------------------------------------------------------------------------------------------------------------------------------------------------------------------------------------------------------------------------------------------------------------------------------------------------------------------------------------------------------------------------------------------------------------------------------------------------------------------------------------------------------------------------------------------------------------------------------------------------------------------------------------------------------------------------------------------------------------------------------------------------------------------------------------------------------------------------------------------------------------------------------------------------------------------------------------------------------------------------------------------------------------------------------------------------------------------------------------------------------------------------------------------------------------------------------------------------

Dependent Resurvey of Portions of the Subdivisional Lines,
T. 6 N., R. 6 E., Wind River Meridian, Wyoming

Chains	
	N. 89° 58' W., between secs. 29 and 32.
	Ascend steep E. slope through scattered rock and juniper timber.
19.78	The center of road, 18 lks. wide, gravel surface, bears NNE. and SSW. Thence over open, rolling ground.
40.08	The cor. of secs. 29, 30, 31 and 32, hereinbefore described.

	S. 89° 58' W., between secs. 30 and 31.
	Over open, rolling terrain.
9.10	The center of road, 18 lks. wide, gravel surface, bears NE. and SW.
40.00	The 1/4 sec. cor. of secs. 30 and 31, monumented with a sandstone, 14 x 12 x 8 ins., firmly set, 6 ins. in the ground, faintly mkd. /4 on the N. face, no other mks. visible, with a partially embedded mound of stone N. of cor.
	At the corner point
	Set a stainless steel post, 28 ins. long, 2½ ins. diam., 23 ins. in the ground, in a collar of stone, atop a plastic encased magnetic marker, with brass cap mkd.
	T6N R6E S 30 1/4 _____ S 31 2023
	Bury the mkd. stone and set steel fence post alongside the stainless steel post.
	Cor. is located on 245 lks. N. of a three-wire power transmission line extending WNW. and ENE., on NE. slope, in scattered sagebrush.
	From this point, GPS/GNSS project control point BLM 7039 bears S. 77° 57' W., 19.97 chs. dist., mkd. with an "X" scribed on sandstone bedrock and steel fence post set alongside.

	S. 89° 58' W., beginning a new measurement.

Dependent Resurvey of Portions of the Subdivisional Lines,
T. 6 N., R. 6 E., Wind River Meridian, Wyoming

Chains	
	Over open, rolling terrain.
11.20	The center of road, 18 lks. wide, gravel surface, bears NW. and SE.
18.20	Trail road, bears NE. and SW.
39.19	The cor. of secs. 25, 30, 31 and 36, on the W. bdy. of the Tp., as described in the field notes of the dependent resurvey, T. 6 N., R. 5 E., executed concurrently under this same group.

	From the cor. of secs. 29, 30, 31 and 32.
	N. 0° 01' W., between secs. 29 and 30.
	Over open, rolling terrain.
3.80	The center of road, 18 lks. wide, gravel surface, bears ENE. and WSW.
40.03	The 1/4 sec. cor. of secs. 29 and 30.

	GENERAL DESCRIPTION
	<p>The area embraced by this survey is situated in the southernmost portion of Hot Springs County, approximately 13 miles S. of Thermopolis, Wyoming. The terrain consists of rolling mountain pasture and high bald ridges. Boysen Peak is located in the northwestern portion of sec. 32. The area E. of Boysen Ridge, which extends northerly through the western portions of sec. 29, falls steeply into the Wind River Canyon, which drains N. through the eastern portion of the Tp. The elevation ranges from about 6,950 feet above sea level at the cor. of secs. 25, 30, 31 and 36, on the W. bdy. of the Tp., to about 7,370 feet above sea level, at the cor. of secs. 29, 30, 31 and 32. The soil is a mixture of sand, sandy loam, and rock. Vegetation consists of mainly grass and sagebrush, with scattered juniper timber on the slopes of the Wind River Canyon.</p> <p>Primary drainage is provided by Teeter Canyon, which drains N. from its headwaters in the southern portion of sec. 30, and by unnamed draws draining E. from Boysen Ridge into the Wind River Canyon. The Boysen Peak Tower Site is located in the northwestern portion of sec. 32. No rural residences or oil and gas development was noted in the area. The open areas are suitable for grazing.</p>

T. 6 N., R. 6 E., Wind River Meridian, Wyoming

Chains	Access is provided from Boysen Peak Road, and U.S. Highway No. 20.
---------------	--------------------------------------------------------------------

**UNITED STATES
DEPARTMENT OF THE INTERIOR
BUREAU OF LAND MANAGEMENT**

FIELD ASSISTANTS

NAMES	CAPACITY
Christopher D. Manukas	Survey intern

CERTIFICATE OF SURVEY

I, James R. Gampetro, Cadastral Surveyor, HEREBY CERTIFY upon honor that, in pursuance of special instructions bearing date of the 13th day of June, 2011, and the 14th day of June, 2023, I have remonumented certain corners and dependently resurveyed portions of the subdivisional lines, Township 6 North, Range 6 East, of the Wind River Meridian, in the State of Wyoming, which are represented in the foregoing field notes as having been executed by me and under my direction; and that said survey has been made in strict conformity with said special instructions, the Manual of Instructions for the Survey of the Public Lands of the United States, and in specific manner described in the foregoing field notes.

April 12, 2024

Date

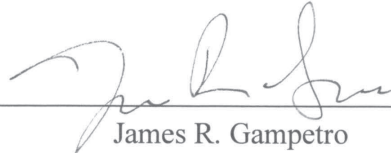

James R. Gampetro
Cadastral Surveyor

CERTIFICATE OF APPROVAL

BUREAU OF LAND MANAGEMENT
Cheyenne, Wyoming

The foregoing field notes of the remonumentation of certain corners and the dependent resurvey of portions of the subdivisional lines, Township 6 North, Range 6 East, of the Wind River Meridian, Wyoming, executed by James R. Gampetro Cadastral Surveyor, having been critically examined and found correct, are hereby approved.

April 12, 2024

Date

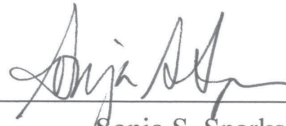

Sonja S. Sparks
Chief Cadastral Surveyor for Wyoming